

Index File No. N 9 CORNER RECORD (SEARCH) (Ref. FSM 7151.4) Tract or Survey No. _____ Cor. No. _____
 T 6 S R. 42 E R.D. UNION County UNION
 Merid. W M N.F. W W State OK

CORNER DIAGRAM

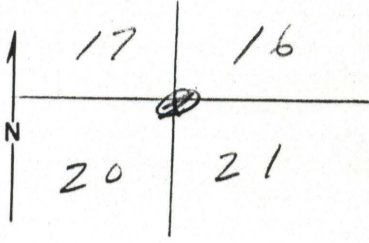

DESCRIBE CORNER MONUMENT FOUND

STONE 18 X 22 X 6 NO MARKINGS

DESCRIBE BEARING TREES OR OTHER OFFICIAL ACCESSORIES FOUND

24" PP STAMP IN SEC 16 WHICH IS A BEARING TREE I FOUND SCAB OF WOOD AT FOOT OF STUMP WITH BIT SCRIBED ON IT I NAILED IT BACK ON STUMP.
 SEC 17 HAS BOTTED 15" PP WITH FLAT SPOTS CHOPPED IN IT NO VISIBLE SCRIB

PHOTO IDENTIFICATION DATA

Photo No. FWD 21-117
 Filed At. _____
 Object Ident. _____
 Ident. By _____
 Signature _____

DESCRIBE CORNER LOCATION RELATIVE TO NEAR-BY FEATURES, ALSO HOW TO REACH CORNER

I PUT F.S. LOCATION ON RD. SHOWN ON PHOTO APPROX 10 CHAINS W. CSO OF COR
 TAG IS ON 14" DF

PLANE COORDINATE POSITION DATA

State _____ Zone _____
 X _____
 Y _____
 Estab. By _____
 Agency _____

Signature EAH

Title _____ Division _____ Headquarters _____

Date 9/6/78

UNION COUNTY SURVEYOR

Date Received _____

Date Filed 12-23-87

By G. LANGRISH, DEPUTY

File No. 406-87R

b-7

CERTIFIED RECORD OF LAND CORNER MONUMENTATION

History of original corner establishment:

Corner was established by W. B. Barr under GLO Contract No. 443, dated May 29, 1882, whose notes state:

"Set basalt rock 18 x 12 x 6 ins, 12 inches in ground for corner to Sec. 16, 17, 20 and 21 marked with 4 notches on the East and 3 notches on the South sides, from which:

A pine 15 in diam bears N 60° W 82 lks dist marked T 6 S R 42 E S 17 BT.

A pine 24 in diam bears N 58° E 85 lks dist marked T 6 S R 42 E S 16 BT

A pine 12 in diam bears S 55° E 170 lks dist marked T 6 S R 42 E S 21 BT.

A pine 12 in diam bears S 4° W 289 lks dist marked T 6 S R 42 E S 20 BT."

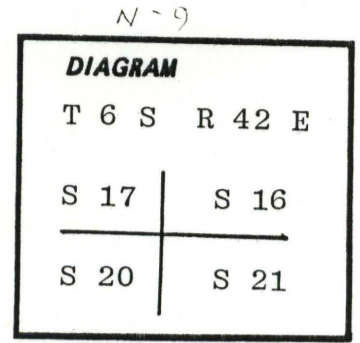

Description of corner evidence found:

Stone, 15 x 14 x 6 ins., 3 notches on the North edge, with a flagged nail underneath stone, from which:

A root hole bears N 60° W., 54.1 ft. dist.

A 1 ft. diam. stump core bears S 55° E., 114.3 ft. dist.

An uprooted rotten log, 22 ins. diam. bears S. 5° W., 192.4 ft. dist.

A 20 ins. diam, 2ft. high stump bears N 58° E., 56.8 ft. dist., with scribed "BT" visible.

Description of monument and accessories | established to perpetuate the original location of this corner:

Set a 2½-inch diam. brass cap on a 1-inch I.D. steel pipe, 30 inches long, 26 inches in the ground in a stone mound with a steel fence post alongside and USFS 54-9 sign attached, from which new bearing trees:

A 12 in. Ponderosa pine bears S 43° E., 40.8 ft. dist., marked T 6 S R 42 E S 21 BT.

A 9 in. P. pine bears S 4° W., 17.8 ft. dist., marked T 6 S R 42 E S 20 BT.

A 10 in. P. pine bears N 38° W., 5.2 ft. dist., mkd. T 6 S R 42 E S 17 BT.

A 10 in. P. pine bears N 63° E., 12.5 ft. dist., mkd. T 6 S R 42 E S 16 BT.

Attached a 54-4 and 54-3 USFS sign to each live BT.
Deposited the found stone 1 ft. deep and 1 ft. North of monument.

Monument is marked thus:

T 6 S R 42 E

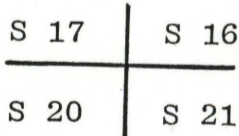

PLS 1206

1985

UNION COUNTY SURVEYOR	
Date Received	<u>5-1-89</u>
Date Filed	<u>5-15-89</u>
By	<u>G. LANGLITZ, DEPUTY</u>
File No.	<u>109-89 R</u>

I certify the above monument was properly reestablished under my supervision on July 12, 1985, by Tom Fisk and Chris Mahoney.

Office of..... County of.....
State of....., I hereby certify that the within instrument was filed in this office for record on the..... day of....., 19.....

(COUNTY OFFICIAL)

(DEPUTY)

REGISTERED PROFESSIONAL LAND SURVEYOR	
<i>James D. Hanley</i>	
OREGON SEPTEMBER 23, 1977 JAMES D. HANLEY 1206	

CERTIFIED RECORD OF LAND CORNER MONUMENTATION

History of original corner establishment:

80.00 Set basalt rock 18 x 12 x 6 ins., 12 ins in the ground for corner to sec. 16, 17, 20, and 21, marked with 4 notches on the East and 3 notches on the South, from which:

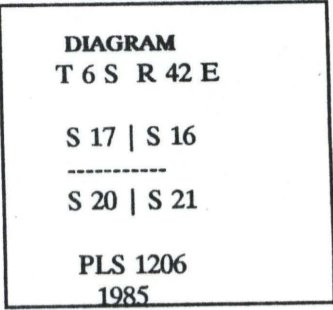

- A pine, 15 ins. diam., bears N.60°W., 82 lks. dist. mkd. T6S R42 E S17 BT.
- A pine, 24 ins. diam., bears N.58°E., 85 lks. dist. mkd. T6S R42E S16 BT.
- A pine, 12 ins. diam., bears S.55°E., 170 lks. dist. mkd. T6S R42E S21 BT.
- A pine, 12 ins. diam., bears S.04°W., 289 lks. dist. mkd. T6S R42E S20 BT.

Description of corner evidence found:

Found a 2½" Brass cap monument 6" above ground in a 2½' diam. mound of stone, from which:

- A pine stump, 24" diam., bears N.60°00'E., 56.52', scribed "BT".
- A dead pine, 12" diam., bears S.41°18'E., 40.72', scribed "T6S R42E S21 BT".
- A pine, 9" diam., bears S.06°24'W., 17.50', scribed "T6S R42E S20 BT".
- A pine, 9" diam., bears N.48°00'W., 5.38', scribed "T6S R42E S17 BT".
- A pine, 10" diam., bears N.65°44'E., 12.5', scribed "T6S R42E S16 BT".

Description of monument and accessories I established to perpetuate the original location of this corner:

UNION COUNTY SURVEYOR

Date Received 8/18/84

Date Filed 10/22/84

By Gregory T. Blanton

File No. 064-1994K



Office of _____ County of _____
 State of _____ I hereby certify that the within instrument was filed in this office
 for record on the _____ day of _____, 19____
 _____ by _____
 (COUNTY OFFICIAL) (DEPUTY)