

CERTIFIED RECORD OF LAND CORNER MONUMENTATION

History of original corner establishment:

SURVEYED BY: W.B. BARR, 1885, CONTRACT NO. 516

SURVEYED BY: G. LANGLITZ, LS 1099, 1986, CORNER MONUMENT NO. 44-86R

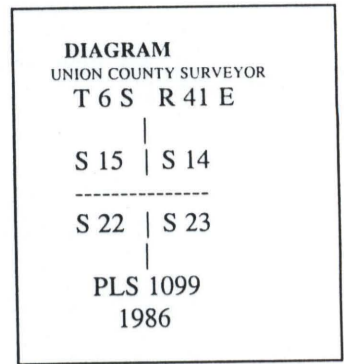

Found original corner stone, a basalt stone 16"x8"x8" on place and upright, with three distinct chisel notches on the south edge and 4 chisel notches on the east edge. (I have no explanation for the presence of 4 notches on the east edge, insted of 2 notches which would be the normal markings for this corner.) The corner stone was supported in a small mound of stone.

At the position of the original corner stone, we set a 2"x30" aluminum pipe, 12" in the ground to bedrock and supported in a mound of stone 5 ft. diameter at base to top of pipe, with aluminum cap.

The original stone is buried along the south side of the aluminum pipe.

We mark the following new trees:

An 18" ponderosa pine, scribed " T6S R41E S14 BT" on a double blaze bears N25°E 75.6 ft.
A 14" ponderosa pine, scribed T6S R41E S22 BT" on a double blaze bears S46½°E 141.2 ft.
An 18" ponderosa pine, scribed "T6S R41E S22 BT" on a double blaze bears S76°W 12.3 ft.
And a 10" ponderosa pine, scribed "T6S R41E S15 BT" on a double blaze bears N28½°W 43.5 ft.

Attached brass washer marked "LS 1099" to lower blaze of new bearing trees.

Description of corner evidence found:

Found a 2½" aluminum capped pipe, cap marked per diagram, with a 5' diam. mound of stone, from which

A ponderosa pine, 13" diam., bears S.50°26'E., 140.62', with a 15" x 2" blaze, scribed "T6S R41E S23".

A ponderosa pine, 17" diam., bears N.22°28'E., 75.18', with a 19" x 2" blaze, scribed "T6S R41E S14".

A ponderosa pine, 11" diam., bears N.32°47'W., 43.37', with a 17" x 2" blaze, scribed "T6S R41E S15"

A ponderosa pine, 17" diam., bears S.74°38'W., 12.19', with a 14" x 2" blaze, scribed "T6S R41E S22".

Description of monument and accessories I established to perpetuate the original location of this corner:

REFERENCE: RECORD OF SURVEY, LONGSHOT CADASTRAL SURVEY
WITNESS TO MONUMENT: DAVID SUTHERLAND
BEARINGS TAKEN TO BRASS TAG AT CENTER OF BLAZE, DISTANCES MEASURED TO BRASS TAG ON SIDE CENTER OF TREE. OBSERVED WITH ELECTRONIC TOTAL STATION AND STEEL TAPE.
BASIS OF BEARINGS WAS A GEODETIC BEARING DETERMINED FROM GPS OBSERVATIONS.

UNION COUNTY SURVEYOR	
Date Received	10/28/98
Date Filed	10/31/98
By	R. ROBINSON, Deputy
File No.	177-1998R

Office of _____ County of _____
State of _____ I hereby certify that the within instrument was filed in this office
for record on the ____ day of _____, 19____
_____ by _____
(COUNTY OFFICIAL) (DEPUTY)

REGISTERED PROFESSIONAL LAND SURVEYOR

OREGON
JULY 15 1983
RONALD E. STOLL
2058

CERTIFIED RECORD OF LAND CORNER MONUMENTATION

History of original corner establishment:

SURVEYED BY: W.B. BAR, 1885, CONTRACT NO. 516

SURVEYED BY: G. LANGLITZ, LS 1099, 1986, CORNER MONUMNET NO. 44-86R

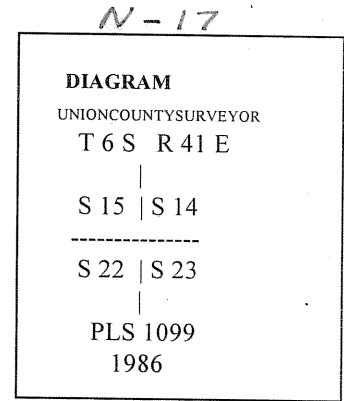

Found original corner stone, a basalt stone 16"x8"x8" on place and upright, with three distinct chisel notches on the south edge and 4 chisel notches on the east edge. (I have no explanation for the presence of 4 notches on the east edge, instead of 2 notches, which would be the normal markings for this corner.) The corner stone was supported in a small mound of stone.

At the position of the original corner stone, we set a 2"x30" aluminum pipe, 12" in the ground to bedrock and supported in a mound of stone 5 ft. diameter at base to top of pipe, with aluminum cap.

The original stone is buried along the south side of the aluminum pipe.

We mark the following new trees:

An 18" ponderosa pine, scribed " T6S R41E S14 BT" on a double blaze bears N25°E 75.6 ft.
 A 14" ponderosa pine, scribed T6S R41E S23 BT" on a double blaze bears S46½°E 141.2 ft.
 An 18" ponderosa pine, scribed "T6S R41E S22 BT" on a double blaze bears S76°W 12.3 ft.
 And a 10" ponderosa pine, scribed "T6S R41E S15 BT" on a double blaze bears N28½°W 43.5 ft.

Attached brass washer marked "LS 1099" to lower blaze of new bearing trees.

Description of corner evidence found:

Found a 2½" aluminum cap with a 5' diam. mound of stone, from which

- A ponderosa pine, 13" diam., bears S.50°26'E., 140.62', with a 15" x 2" blaze, scribed "T6S R41E S23".
- A ponderosa pine, 17" diam., bears N.22°28'E., 75.18', with a 19" x 2" blaze, scribed "T6S R41E S14".
- A ponderosa pine, 11" diam., bears N.32°47'W., 43.37', with a 17" x 2" blaze, scribed "T6S R41E S15".
- A ponderosa pine, 17" diam., bears S.74°38'W., 12.19', with a 14" x 2" blaze, scribed "T6S R41E S22".

Description of monument and accessories I established to perpetuate the original location of this corner:

REFERENCE: RECORD OF SURVEY, LONGSHOT CADASTRAL SURVEY
 WITNESS TO MONUMENT: DAVID SUTHERLAND
 BEARINGS TAKEN TO BRASS TAG AT CENTER OF BLAZE, DISTANCES MEASURED TO BRASS TAG ON SIDE CENTER OF TREE. OBSERVED WITH ELECTRONIC TOTAL STATION AND STEEL TAPE.
 BASIS OF BEARING WAS GEODETIC BEARING DETERMINED FROM GPS OBSERVATIONS.

REGISTERED
 PROFESSIONAL
 LAND SURVEYOR

R. E. Stoll 6/04

OREGON
 JULY 15, 1983
 RONALD E. STOLL
 2058

UNION COUNTY SURVEYOR	
Date Received	<u>1/4/06</u>
Date Filed	<u>9/9/06</u>
By	<u>R. ROBINSON, DEPUTY</u>
File No.	<u>019-2006R</u>

Office of _____ County of _____
 State of _____ I hereby certify that the within instrument was filed in this office
 for record on the ____ day of _____, 20 ____.

 (COUNTY OFFICIAL) By _____ (DEPUTY)

BU