

**CERTIFIED RECORD OF LAND CORNER MONUMENTATION**

History of original corner establishment:

SURVEYED BY: W.B. BARR, 1885, CONTRACT NO. 516

40.00 Set stone 14 x 12 x 10 for cor to secs. 10, 11, 14, and 15.

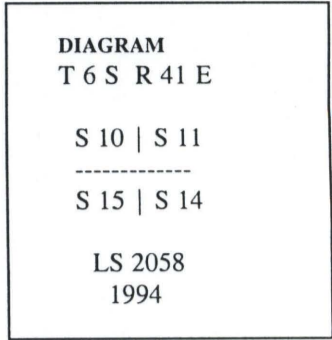

Description of corner evidence found:

No evidence of the original corner found.

Description of monument and accessories I established to perpetuate the original location of this corner:

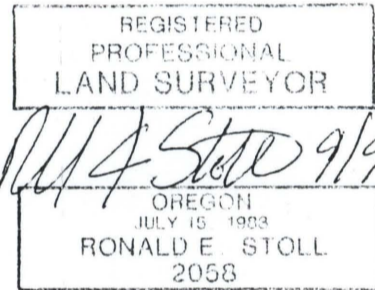

At a proportionate position. Set a USFS 3 1/4" aluminum capped pipe, cap marked per diagram, 20" in the ground with a mound of stones to cap. 15' ± Northerly E/W fence line, from which:

- A 1/2" rebar, with aluminum cap, bears S.49°08'E., 28.26'.
- A 1/2" rebar, with aluminum cap, bears S.57°06'W., 35.76'.
- A 1/2" magnet 12" below the ground with aluminum cap on top of hole, bears N.43°41'W., 25.58'.
- A 1/2" magnet 12" below the ground with aluminum cap on top of hole, bears N.44°15'E., 26.12'.

REFERENCE: RECORD OF SURVEY, LONGSHOT CADASTRAL SURVEY  
WITNESS TO MONUMENT: DAVID SUTHERLAND  
BEARINGS TAKEN TO BRASS TAG AT CENTER OF BLAZE OR CAP, DISTANCES MEASURED TO BRASS TAG ON SIDE CENTER OF TREE OR CAP. OBSERVED WITH ELECTRONIC TOTAL STATION AND STEEL TAPE.  
BASIS OF BEARINGS WAS A GEODETIC BEARING DETERMINED FROM GPS OBSERVATIONS.

Office of \_\_\_\_\_ County of \_\_\_\_\_  
State of \_\_\_\_\_ I hereby certify that the within instrument was filed in this office  
for record on the \_\_\_\_ day of \_\_\_\_\_, 19\_\_\_\_  
\_\_\_\_\_ by \_\_\_\_\_  
(COUNTY OFFICIAL) (DEPUTY)

BM

UNION COUNTY SURVEYOR
Date Received <u>10/28/98</u>
Date Filed <u>10/31/98</u>
By <u>R. ROBINSON, DEPUTY</u>
File No. <u>169-1998R</u>

# HORIZONTAL CONTROL DATA

## UNION COUNTY, OREGON

### OREGON STATE PLANE, NORTH ZONE (3601)

STA NAME: 2023006

SECTION CORNER COMMON TO SECTIONS 10, 11, 14, AND 15

TWP. 6 S RGE. 41 E.

GEODETIC COORD: NAD 83(91)

DATE TIED: February 15, 2023

LAT: 45 ° 3 ' 2.99926 " N

SURVEYOR: JEFFREY S. HSU  
OPLS 83571

LONG: 117 ° 39 ' 59.25274 " W

FIRM: BAGETT, GRIFFITH, & BLACKMAN  
2006 ADAMS AVENUE  
LAGRANDE, OR 97850  
(541) 963-6092

SP. COOR: NAD 83(91)

N: 517466.701 INT FT.

E: 8934216.793 INT FT.

TYPE: GPS

THETA: 2 ° 0 ' 34.22732 "

ORDER: SECOND CLASS: 1

SCALE FACTOR: 0.999896691

ELEV: 3659.79 US FT.

ELEV: DATUM: NGVD 29

**COMMENTS:**

2 1/2" Aluminum pipe with USFS 3 1/4" aluminum cap marked as shown, Northwesterly of fence corner

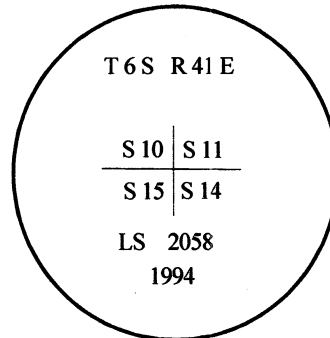

REGISTERED  
PROFESSIONAL  
LAND SURVEYOR

OREGON  
June 2, 2010  
JEFFREY S. HSU  
83571

Renewal Date: June 30, 2023

1 METER = 3.2808333333... US FEET = 39.37 INCHES

1 METER = 3.280839895 INT'L FEET OR 1 INCH = 2.54 CM

TO CALCULATE ELEVATION FACTOR ( IN THE NORTH AMERICAN CONTINENT)

DIVIDE 20,906,000 BY (20,906,000 + ELLIPSOID ELEV. IN FEET)

GEOID MODEL : 2012B