

CERTIFIED RECORD OF LAND CORNER MONUMENTATION

G-21

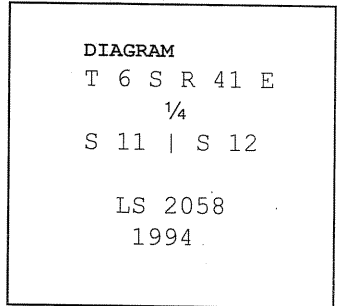

History of original corner establishment:

SURVEYED BY: W.B. BAR, 1885, CONTRACT NO. 516

40.00 Set stone 12 x 8 x 6 for 1/4 sec. cor., from which:

- A pine, 12 ins. diam., bears S.45°W., 50 lks. dist.
- A pine, 18 ins. diam., bears N.40°E., 31 lks. dist.

Description of corner evidence found:

No evidence of original corner found.

Description of monument and accessories I established to perpetuate the original location of this corner:

At a proportionate position, set a USFS 3 1/4" aluminum capped pipe, cap marked per diagram, 4" in the ground with no stones cap, from which:

- A Pine, 14" diam., bears S.10°58'W., 18.5', scribed "1/4S11BT".
- A Pine, 12" diam., bears N.87°58'E., 12.2', scribed "1/4S12BT".
- A Pine, 8" diam., bears N.40°21'W., 10.2', scribed "1/4S11BT".
- A Pine, 10" diam., bears S.69°08'W., 29.9', scribed "1/4S11BT".

REFERENCE: RECORD OF SURVEY, LONGSHOT CADASTRAL SURVEY

WITNESS TO MONUMENT: ERIC GREEN

BEARINGS TAKEN TO BRASS TAG AT CENTER OF BLAZE, DISTANCES MEASURED TO BRASS TAG ON SIDE CENTER OF TREE. OBSERVED WITH ELECTRONIC TOTAL STATION AND STEEL TAPE.

BASIS OF BEARING WAS GEODETIC BEARING DETERMINED FROM GPS OBSERVATIONS.

UNION COUNTY
SURVEYOR

Date Received 1/4/06

Date Filed 9/9/06

By R. ROBINSON, Deputy

File No. 012-2006R

REGISTERED
PROFESSIONAL
LAND SURVEYOR

M & Stoll 6/06

OREGON
JULY 15, 1983
RONALD E. STOLL
2058

Office of _____ County of _____
 State of _____ I hereby certify that the within instrument was filed in this office
 for record on the ____ day of _____, 20____.
 _____ By _____
 (COUNTY OFFICIAL) (DEPUTY)

AT

CERTIFIED RECORD OF LAND CORNER MONUMENTATION

History of original corner establishment:

SURVEYED BY: W.B. BARR, 1885, CONTRACT NO. 516

40.00 Set stone 12 x 8 x 6 for 1/4 sec. cor., from which:

A pine, 12 ins. diam., bears S.45°W., 50 lks. dist.

A pine, 18 ins. diam., bears N.40°E., 31 lks. dist.

DIAGRAM
T 6 S R 41 E
1/4
S 11 | S 12

LS 2058
1994

Description of corner evidence found:

No evidence of original corner found.

Description of monument and accessories I established to perpetuate the original location of this corner:

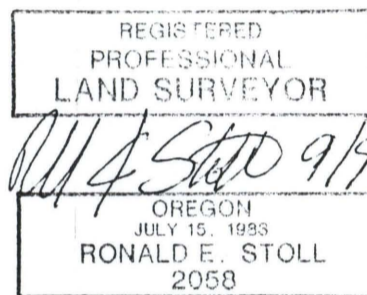

At a proportionate position, set a USFS 3 1/4" aluminum capped pipe, cap marked per diagram, 4" in the ground with mound of stones to cap, from which:

- A Pine, 14" diam., bears S.10°58'W., 190.58', scribed "1/4S11BT".
- A Pine, 12" diam., bears N.87°58'W., 87.58', scribed "1/4S12BT".
- A Pine, 8" diam., bears N.40°21'W., 319.39', scribed "1/4S11BT".
- A Pine, 10" diam., bears S.69°08'W., 249.08', scribed "1/4S11BT".

REFERENCE: RECORD OF SURVEY, LONGSHOT CADASTRAL SURVEY
WITNESS TO MONUMENT: ERIC GREEN
BEARINGS TAKEN TO BRASS TAG AT CENTER OF BLAZE, DISTANCES MEASURED TO BRASS TAG ON SIDE CENTER OF TREE. OBSERVED WITH ELECTRONIC TOTAL STATION AND STEEL TAPE.
BASIS OF BEARINGS WAS A GEODETIC BEARING DETERMINED FROM GPS OBSERVATIONS.

Office of _____ County of _____
State of _____ I hereby certify that the within instrument was filed in this office
for record on the ____ day of _____, 19____
_____ by _____
(COUNTY OFFICIAL) (DEPUTY)

AT

WASCO COUNTY
REGISTERED
Date Received 10/28/98
Date Filed 10/31/98
By R. Robinson, Deputy
File No. 151-1976R

CERTIFIED RECORD OF LAND CORNER MONUMENTATION

G-21

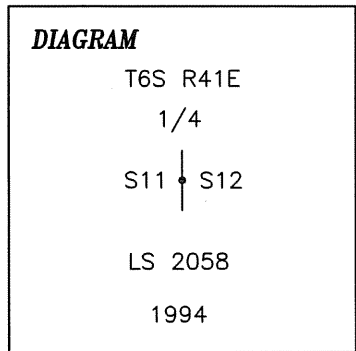

Typical USFS Cap

History of original corner establishment:

Corner originally established by John H. Stone, U.S. Deputy Surveyor, under GLO Contract No. 235 dated July 6, 1875. Surveyor General records state:

Set Stone 12 x 8 x 6 for 1/4 Sec Cor from which a:

- Pine 12 in. dia. bears S45°W, 50 lks. dist.
- Pine 18 in. dia. bears N40°E, 31 lks. dist.

Corner reestablished in 1994 by Ronald E. Stoll, PLS 2058, under USFS contract. Stoll's records state:

No evidence of original corner found. At proportionate position, set a USFS 3 1/4" aluminum capped pipe, cap marked per diagram, 4" in the ground with no stones from which:

- A Pine, 14" diam., bears S10°58'W, 18.5', scribed 1/4 S11 BT
- A Pine, 12" diam., bears N87°58'E, 12.2', scribed 1/4 S12 BT
- A Pine, 8" diam., bears N40°21'W, 10.2', scribed 1/4 S11 BT
- A Pine, 10" diam., bears S69°08'W, 29.9', scribed 1/4 S11 BT

Description of corner evidence found:

Found a 3 1/4" USFS aluminum cap on an aluminum pipe marked as per corner diagram 12" above ground in large stone mound just east of north-south fence line from which:

- A Ponderosa Pine 14" in diameter bears N75°E (Record N87°58'E), 12.9' (Record 12.2') with visible scribing.
- A Ponderosa Pine 13" in diameter bears S48°W (Record S10°58'W), 27.3' (Record 18.5') with visible scribing.
- A Ponderosa Pine 12" in diameter bears S77°W (Record S69°08'W), 45.9' (Record 29.9') with visible scribing.
- A Ponderosa Pine, dead and down, 12" in diameter bears N26°W (Record N40°21'W), 33.1' (Record 10.2') with visible scribing.

Steel fencepost with 54-2 sign north, 3.2'. Steel fencepost with 54-2 and 54-9 signs south, 3.7'.

Description of monument and accessories I established to perpetuate the original location of this corner:

New Bearing Tree:

A Ponderosa Pine 9" in diameter bears S42°E, 6.0' scribed X BT.

Corner monument evidently moved by Stoll after bearing trees were taken. Bearing tree scribes do not quite face corner monument. Remeasure bearings and distances to Stoll's bearing trees. Distances to bearing trees measured to side center. Distance to new bearing tree measured to 40d spike in right side center. New bearing tree has brass disk stamped PLS 2672 nailed between the B and T on lower face. All bearing trees have 54-3 and 54-9 signs, a 6" red painted band, and bearing tree face painted red.

Date: November 21, 2007
Declination: 16° E

UNION COUNTY SURVEYOR

Date Received 12/1/07

Date Filed 12/11/07

[Signature]

No. 027-2007R

REGISTERED PROFESSIONAL LAND SURVEYOR

[Signature]

OREGON
JULY 19, 1994
KENNETH A. LIND
2672

Renews: 12-31-08