

**CERTIFIED RECORD OF LAND CORNER MONUMENTATION**

History of original corner establishment:

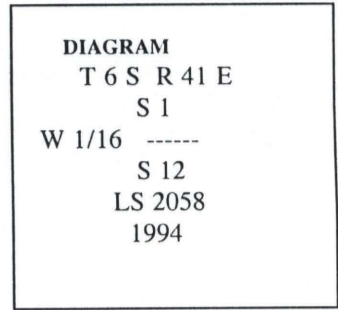

Description of corner evidence found:

Description of monument and accessories I established to perpetuate the original location of this corner:

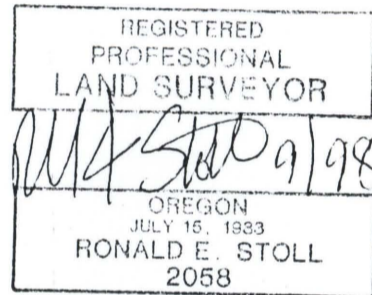

Set a USFS 3 1/4" aluminum capped pipe, cap marked per diagram, 26" in the ground, with a mound of stone to cap, from which:

- A pine, 9" in diam., bears S.78°30'W., 30.3', scribed "W1/16S12BT".
- A pine, 10" in diam., bears N.81°25'W., 30.3', scribed "W1/16S1BT".

REFERENCE: RECORD OF SURVEY, LONGSHOT CADASTRAL SURVEY  
WITNESS TO MONUMENT: ERIC GREEN  
BEARINGS TAKEN TO BRASS TAG AT CENTER OF BLAZE, DISTANCES MEASURED TO BRASS TAG ON SIDE CENTER OF TREE. OBSERVED WITH ELECTRONIC TOTAL STATION AND STEEL TAPE.  
BASIS OF BEARINGS WAS A GEODETIC BEARING DETERMINED FROM GPS OBSERVATIONS.

Office of \_\_\_\_\_ County of \_\_\_\_\_  
State of \_\_\_\_\_ I hereby certify that the within instrument was filed in this office  
for record on the \_\_\_\_\_ day of \_\_\_\_\_, 19\_\_\_\_  
\_\_\_\_\_  
(COUNTY OFFICIAL) by \_\_\_\_\_ (DEPUTY)

LEWIS COUNTY  
SURVEYOR  
Date Received 10/28/98  
Date Filed 10/31/98  
By R. ROBINSON, DEPUTY  
File No. 128-1998R