

**CERTIFIED RECORD OF LAND CORNER MONUMENTATION**

E-7

History of original corner establishment:

SURVEYED BY: W.B. BAR, 1885, CONTRACT NO. 516

41.15 Set a basalt rock, 18 x 12 x 8. 12 ins. in the ground for 1/4 sec. cor. marked 1/4 on the N. side, from which:

- A pine, 14 ins. diam., bears S.11° W., 38 lks. dist. mkd. 1/4 S BT.
- A pine, 12 ins. diam., bears N.39°E., 66 lks. dist. mkd. 1/4 S BT

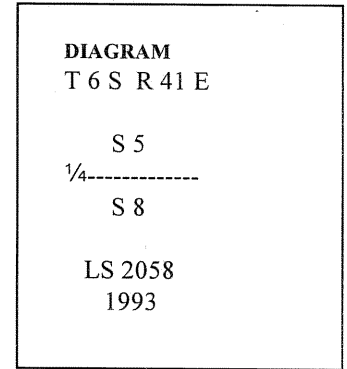

Description of corner evidence found:

No evidence of original monument found.

Description of monument and accessories I established to perpetuate the original location of this corner:

At a proportionate position, set a USFS 3 1/4" aluminum capped pipe, cap marked per diagram, 24" in the ground with a mound of stone to the cap, from which:

- A fir, 6" diam., bears N.35°31'E., 68.37', scribed "1/4 S5 BT".
- A pine, 16" diam., bears S.60°04'W., 56.25', scribed "1/4 S8 BT".
- A fir, 7" diam., bears S.52°59'E., 43.66', scribed "1/4 S8 BT".
- A fir, 12" diam., bears N.78°36'E., 88.35', scribed "1/4 S5 BT".

REFERENCE: RECORD OF SURVEY, LONGSHOT CADASTRAL SURVEY

WITNESS TO MONUMENT: DAVID SUTHERLAND

BEARINGS TAKEN TO BRASS TAG AT CENTER OF BLAZE, DISTANCES MEASURED TO BRASS TAG ON SIDE CENTER OF TREE. OBSERVED WITH ELECTRONIC TOTAL STATION AND STEEL TAPE.

BASIS OF BEARING WAS GEODETIC BEARING DETERMINED FROM GPS OBSERVATIONS.

UNION COUNTY  
SURVEYOR

Date Received 1/4/06

Date Filed 9/9/06

By R. ROBINSON, Deputy

File No. 008-2006R

REGISTERED  
PROFESSIONAL  
LAND SURVEYOR

*R. Stoll 6/04*

OREGON  
JULY 15, 1999  
RONALD E. STOLL  
2055

Office of \_\_\_\_\_ County of \_\_\_\_\_  
State of \_\_\_\_\_ I hereby certify that the within instrument was filed in this office  
for record on the \_\_\_\_ day of \_\_\_\_\_, 20\_\_\_\_.

\_\_\_\_\_  
(COUNTY OFFICIAL) By \_\_\_\_\_  
(DEPUTY)

Al

**CERTIFIED RECORD OF LAND CORNER MONUMENTATION**

History of original corner establishment:

SURVEYED BY: W.B. BARR, 1885, CONTRACT NO. 516

41.15 Set a basalt rock, 18 x 12 x 8. 12 ins. in the ground for 1/4 sec. cor. marked 1/4 on the N. side, from which:

- A pine, 14 ins. diam., bears S. W., 38 lks. dist. mkd. 1/4 S BT.
- A pine, 12 ins. diam., bears N.39°E., 66 lks. dist. mkd. 1/4 S BT

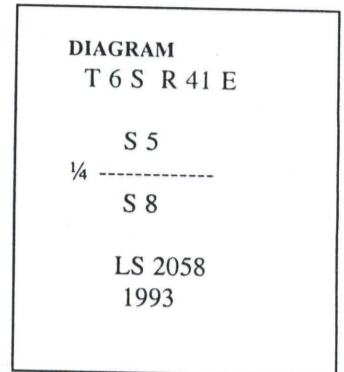

Description of corner evidence found:

No evidence of original monument found.

Description of monument and accessories I established to perpetuate the original location of this corner:

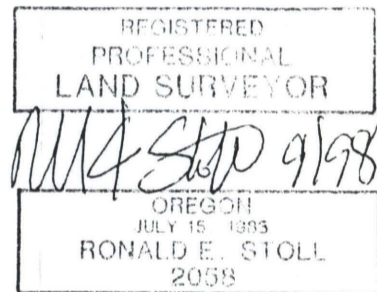

At a proportionate position, set a USFS 3 1/4" aluminum capped pipe, cap marked per diagram, 24" in the ground with a mound of stone to the cap, from which:

- A fir, 6" diam., bears N.35°31'W., 68.37', scribed "1/4 S5 BT".
- A pine, 16" diam., bears S.60°04'W., 56.25', scribed "1/4 S8 BT".
- A fir, 7" diam., bears S.52°59'E., 43.66', scribed "1/4 S8 BT".
- A fir, 12" diam., bears N.78°36'E., 88.35', scribed "1/4 S5 BT".

REFERENCE: RECORD OF SURVEY, LONGSHOT CADASTRAL SURVEY  
 WITNESS TO MONUMENT: DAVID SUTHERLAND  
 BEARINGS TAKEN TO BRASS TAG AT CENTER OF BLAZE, DISTANCES MEASURED TO BRASS TAG ON SIDE CENTER OF TREE. OBSERVED WITH ELECTRONIC TOTAL STATION AND STEEL TAPE.  
 BASIS OF BEARINGS WAS A GEODETIC BEARING DETERMINED FROM GPS OBSERVATIONS.

Office of \_\_\_\_\_ County of \_\_\_\_\_  
 State of \_\_\_\_\_ I hereby certify that the within instrument was filed in this office  
 for record on the \_\_\_\_ day of \_\_\_\_\_, 19\_\_\_\_  
 \_\_\_\_\_ by \_\_\_\_\_  
 (COUNTY OFFICIAL) (DEPUTY)

UNION COUNTY  
 CLERK'S OFFICE

Date Received 10/28/98  
 Date Filed 10/31/98  
 By R. ROBINSON, DEPUTY  
 File No. 141-1998R

**CERTIFIED RECORD OF LAND CORNER MONUMENTATION**

E-7

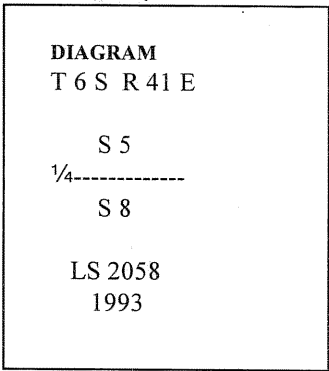

History of original corner establishment:

SURVEYED BY: W.B. BAR, 1885, CONTRACT NO. 516

41.15 Set a basalt rock, 18 x 12 x 8. 12 ins. in the ground for 1/4 sec. cor. marked 1/4 on the N. side, from which:

- A pine, 14 ins. diam., bears S.11° W., 38 lks. dist. mkd. 1/4 S BT.
- A pine, 12 ins. diam., bears N.39°E., 66 lks. dist. mkd. 1/4 S BT

Description of corner evidence found:

No evidence of original monument found.

Description of monument and accessories I established to perpetuate the original location of this corner:

At a proportionate position, set a USFS 3 1/4" aluminum capped pipe, cap marked per diagram, 24" in the ground with a mound of stone to the cap, from which:

- A fir, 6" diam., bears N.35°31'E., 68.37', scribed "1/4 S5 BT".
- A pine, 16" diam., bears S.60°04'W., 56.25', scribed "1/4 S8 BT".
- A fir, 7" diam., bears S.52°59'E., 43.66', scribed "1/4 S8 BT".
- A fir, 12" diam., bears N.78°36'E., 88.35', scribed "1/4 S5 BT".

REFERENCE: RECORD OF SURVEY, LONGSHOT CADASTRAL SURVEY

WITNESS TO MONUMENT: DAVID SUTHERLAND

BEARINGS TAKEN TO BRASS TAG AT CENTER OF BLAZE, DISTANCES MEASURED TO BRASS TAG ON SIDE CENTER OF TREE. OBSERVED WITH ELECTRONIC TOTAL STATION AND STEEL TAPE.

BASIS OF BEARING WAS GEODETIC BEARING DETERMINED FROM GPS OBSERVATIONS.

UNION COUNTY SURVEYOR
Date Received <u>1/4/06</u>
Date Filed <u>9/9/06</u>
By <u>R. ROBINSON, DEPUTY</u>
File No. <u>008-2006R</u>

REGISTERED PROFESSIONAL LAND SURVEYOR
<i>R. E. Stoll 6/04</i>
OREGON JULY 15, 1969 RONALD E. STOLL 2058

Office of \_\_\_\_\_ County of \_\_\_\_\_  
State of \_\_\_\_\_ I hereby certify that the within instrument was filed in this office  
for record on the \_\_\_\_ day of \_\_\_\_\_, 20 \_\_\_\_.

\_\_\_\_\_  
(COUNTY OFFICIAL) By \_\_\_\_\_  
(DEPUTY)

Al