

UNION COUNTY SURVEYOR

CERTIFIED RECORD OF LAND CORNER MONUMENTATION

HISTORY OF ORIGINAL CORNER ESTABLISHMENT:

Corner originally established by Timothy Davenport under GLO Contract number 102, dated July 20, 1863. GLO record states:

Set a quarter corner post, made mound of earth and drove charred stake as per instructions

No record of subsequent monumentation found in UNION COUNTY survey records.

DESCRIPTION OF CORNER EVIDENCE FOUND:

No original evidence, however old fences intersect County road are relative to topo calls. Also unrecorded field ties of Bill Hanley for Doug Lewis dated May 19, 1982. This work ties a large area of fence corners and topo calls and establishes this position as the corner.

See Survey Number 011-1998.

DESCRIPTION OF MONUMENT AND ACCESSORIES I ESTABLISHED

TO PERPETUATE THE ORIGINAL LOCATION OF THIS CORNER:

At the intersection of the centerline of the existing county road and the existing east-west fence lines (very old fences), I set a 2½"x30" aluminum pipe with aluminum cap marked as shown, 36" in the ground. From which:

NEW BEARING OBJECTS:

An 8"x8" Railroad tie (S gate post) bears N 63°E, a distance of 35.39 feet, set P.K. Nail 1.0 ft from ground on west side.

An 8"x8" Railroad tie bears S 40°E, a distance of 46.49 feet. I set a p.k. nail 1.0 ft from the ground on the west side.

An 8" gate post bears S 86°W, 30.76 feet. I set a P.K. nail 1.0 ft from the ground on the East side

A power pole bears N 30°W, a distance of 57.45 feet, marked 091259950. I set a P.K. nail 1.0 ft from ground on East side.

I hereby certify that the corner was monumented on March 22, 1998.

Witness: Greg Blackman Jr.

T 6 S R 38 E T-25

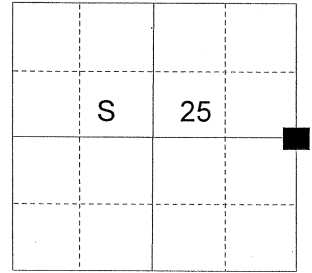

REGISTERED
PROFESSIONAL
LAND SURVEYOR

Gregory T. Blackman
OREGON
JULY 13, 1973
GREGORY T. BLACKMAN
991

Renewal Date: December, 31 1999

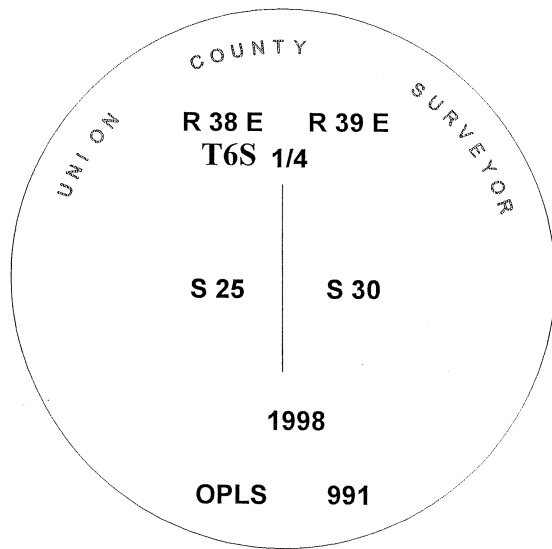

UNION COUNTY SURVEYOR
Date Received 4/19/98
Date Filed 4/20/98
Filed By R. Robinson, Deputy
File Number 009-1998R

I used a steel tape and magnetic compass in the establishment of the new accessories. I used 17° East declination.

HORIZONTAL CONTROL DATA

UNION COUNTY, OREGON

OREGON STATE PLANE, NORTH ZONE (3601)

STA NAME: 201422

1/4 SECTION CORNER COMMON TO SECTIONS 25 AND 30

TWP. 6 S. RGE. 38 39 E.

GEODETIC COORD: NAD 83(91)

DATE TIED: September 12, 2014

LAT: 45 ° 0 ' 50.30627 " N

SURVEYOR: RICK G. ROBINSON
OPLS 2219

LONG: 117 ° 59 ' 35.27127 " W

FIRM: BAGETT, GRIFFITH, & BLACKMAN
2006 ADAMS AVENUE
LAGRANDE, OR 97850
(541) 963-6092

SP. COOR: NAD 83(91)

N: 501245.735 INT FT.

E: 8850258.607 INT FT.

TYPE: GPS

THETA: 1 ° 46 ' 40.2114227 "

ORDER: SECOND CLASS: 1

SCALE FACTOR: 0.9998982142

ELEV: 3514.60 US FT.

ELEV: DATUM: NGVD 29

COMMENTS:

Corner monument is set 6" below road surface of Coughanour Lane at E-W fenceline

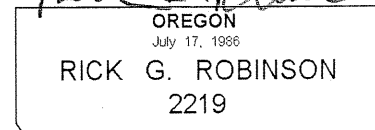
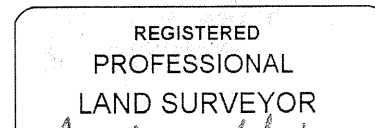
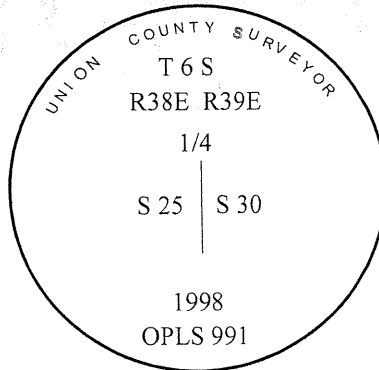

Renewal Date: December 31, 2014

1 METER = 3.2808333333... US FEET = 39.37 INCHES

1 METER = 3.280839895 INT'L FEET OR 1 INCH = 2.54 CM

TO CALCULATE ELEVATION FACTOR (IN THE NORTH AMERICAN CONTINENT)

DIVIDE 20,906,000 BY (20,906,000 + ELLIPSOID ELEV. IN FEET)