

# HORIZONTAL CONTROL DATA

## UNION COUNTY, OREGON

### OREGON STATE PLANE, NORTH ZONE (3601)

STA NAME: 200142

CORNER COMMON TO: 22,23,26,27

TWP. 6 S. RGE. 39 E.

GEODETIC COORD: NAD 83(91)

DATE TIED: 28 MARCH 2001

LAT: 45 ° 1 ' 15.45748 " N

SURVEYOR: GREGORY T. BLACKMAN  
OPLS 991

LONG: 117 ° 54 ' 43.10564 " W

FIRM: BAGETT, GRIFFITH, & BLACKMAN  
2006 ADAMS AVENUE  
LAGRANDE, OR 97850  
(541) 963-6092

SP. COOR: NAD 83(91)

N: 504453.106 INT FT.

E: 8871153.392 INT FT.

TYPE: GPS

THETA: 1 ° 50 ' 7.41119995 "

ORDER: SECOND CLASS: 1

SCALE FACTOR: 0.9998978938

ELEV: 3247.00 US FT.

ELEV: DATUM: NGVD 29

COMMENTS:

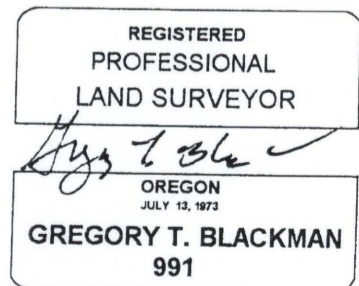
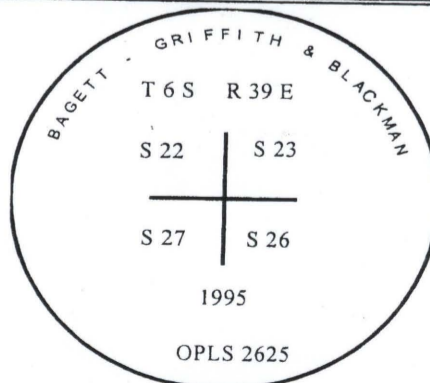

Renewal Date: Dec. 31, 2001

1 METER = 3.280833333... US FEET = 39.37 INCHES

1 METER = 3.280839895 INT'L FEET OR 1 INCH = 2.54 CM

TO CALCULATE ELEVATION FACTOR ( IN THE NORTH AMERICAN CONTINENT)

DIVIDE 20,906,000 BY (20,906,000 + ELLIPSOID ELEV. IN FEET)