

CERTIFIED RECORD OF LAND CORNER MONUMENTATION

HISTORY OF ORIGINAL CORNER ESTABLISHMENT:

Corner originally established by David Thompson under GLO contract Number 103, dated September, 1863. Surveyor General record states: Set post in mound of earth with charred stake, pits, trenches, as per instructions.

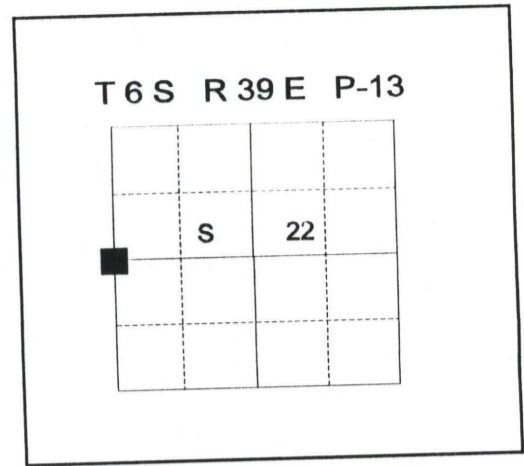

No record of subsequent monumentation found in Union County survey records

DESCRIPTION OF CORNER EVIDENCE FOUND:

No evidence of original corner was found.

See Union County survey 023-1995.

DESCRIPTION OF MONUMENT AND ACCESSORIES I ESTABLISHED TO PERPETUATE THE ORIGINAL LOCATION OF THIS CORNER:

At the intersection of the west and south fence lines, I set a 2½"x30" aluminum pipe with aluminum cap marked as shown, 32 inches in the ground, from which;

NEW BEARING OBJECTS:

- A 5/8"x30" rebar with 1.5" aluminum cap (buried 1') bears North, 6.65 feet marked BGB NORTH RP
- A 5/8"x30" rebar with 1.5" aluminum cap (buried 1') bears East, 6.49 feet marked BGB EAST RP
- A 5/8"x30" rebar with 1.5" aluminum cap bears South, 6.64 feet marked BGB South RP
- A 5/8"x30" rebar with 1.5" aluminum cap bears West, 21.86 feet marked BGB WEST RP

A steel fence post was set 1 foot north of the monument.

I hereby certify that the corner was monumented on July 11, 1995.
Witness: Pete Crabtree

REGISTERED
PROFESSIONAL
LAND SURVEYOR

Jeffery P. Petersen

OREGON
JULY 20, 1993
JEFFERY P. PETERSEN
2625

Renewal Date: December, 31 1996

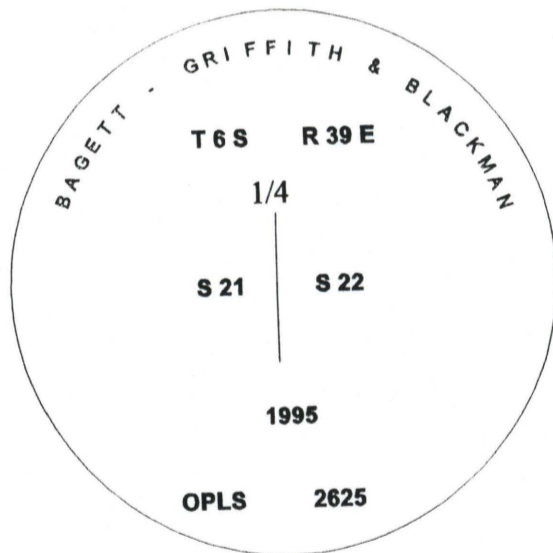

I used a steel tape and magnetic compass in the establishment of the new accessories. I used 17° East declination, the distances are to the center of the aluminum cap.

**UNION COUNTY
SURVEYOR**

Date Received 7-24-95

Date Filed 7-26-95

Filed By *Sydney T. Glue*

File Number 010-1995R

**HORIZONTAL CONTROL DATA
UNION COUNTY, OREGON
OREGON STATE PLANE, NORTH ZONE (3601)**

STA NAME: 200139

QUARTER COMMON TO: 21 & 22

TWP. 6 S. RGE. 39 E.

GEODETIC COORD: NAD 83(91)

DATE TIED: 28 MARCH 2001

LAT: 45 ° 1 ' 42.14244 " N

SURVEYOR: GREGORY T. BLACKMAN
OPLS 991

LONG: 117 ° 55 ' 56.11339 " W

FIRM: BAGETT, GRIFFITH, & BLACKMAN
2006 ADAMS AVENUE
LAGRANDE, OR 97850
(541) 963-6092

SP. COOR: NAD 83(91)

N: 506986.825 INT FT.

E: 8865826.545 INT FT.

TYPE: GPS

THETA: 1 ° 49 ' 15.6351268 "

ORDER: SECOND CLASS: 1

SCALE FACTOR: 0.9998975701

ELEV: 3289.25 US FT.

ELEV: DATUM: NGVD 29

COMMENTS:

Fence corner is 6.6 ft. South

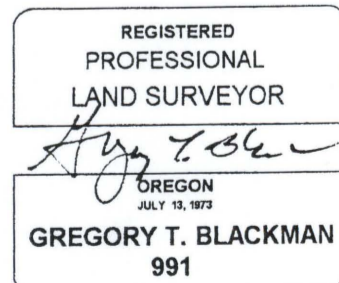
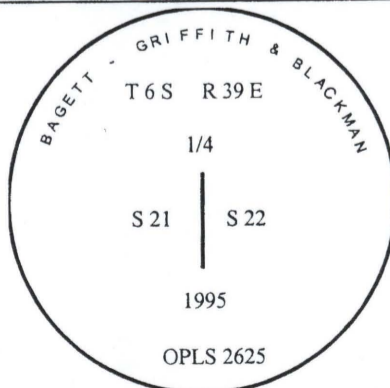

Renewal Date: Dec. 31, 2001

1 METER = 3.280833333... US FEET = 39.37 INCHES

1 METER = 3.280839895 INT'L FEET OR 1 INCH = 2.54 CM

TO CALCULATE ELEVATION FACTOR (IN THE NORTH AMERICAN CONTINENT)

DIVIDE 20,906,000 BY (20,906,000 + ELLIPSOID ELEV. IN FEET)