

UNION COUNTY SURVEYOR

CERTIFIED RECORD OF LAND CORNER MONUMENTATION

HISTORY OF ORIGINAL CORNER ESTABLISHMENT:

Corner originally established by David P. Thompson, contract No. 103, dated September 3, 1863. Surveyor General record states:

Set post for corner to secs 15, 16, 21, & 22 in mound of earth with charred stakes, pits, trenches, as per instructions.

No record of subsequent monumentation found in Union County survey records.

DESCRIPTION OF CORNER EVIDENCE FOUND:

NONE

See Survey No. 012-2001

DESCRIPTION OF MONUMENT AND ACCESSORIES I ESTABLISHED

TO PERPETUATE THE ORIGINAL LOCATION OF THIS CORNER:

At position established by Survey No. 012-2001 I set a 2 1/2" x 30" copper clad monument in a water valve box, marked as shown below, 35" in the ground from which:

A 5/8" x 30" iron pin with 1 1/2" aluminum cap in a East-West fenceline bears N22°E, a distance of 50.93 feet, marked UNION COUNTY SURVEYOR NE RP.

A 5/8" x 30" iron pin with 1 1/2" aluminum cap in a East-West fenceline bears S21°E, a distance of 41.46 feet, marked UNION COUNTY SURVEYOR SE RP.

A 5/8" x 30" iron pin with 1 1/2" aluminum cap in a East-West fenceline bears S37°W, a distance of 35.19 feet, marked UNION COUNTY SURVEYOR SW RP.

A 5/8" x 30" iron pin with 1 1/2" aluminum cap in a East-West fenceline bears N51°W, a distance of 39.96 feet, marked UNION COUNTY SURVEYOR NW RP.

I hereby certify that the corner was monumented on March 27, 2001. Witness: Norbert Volny and Gregory T. Blackman, Jr.

T 6 S R 39 E N-13

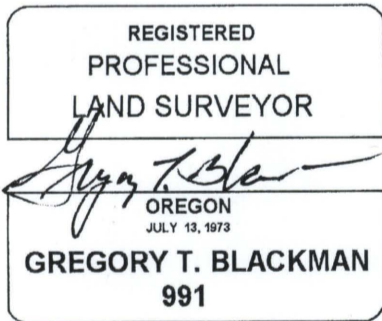
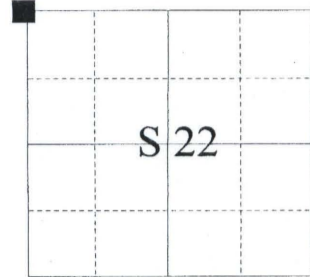

Renewal Date: Dec. 31, 2001

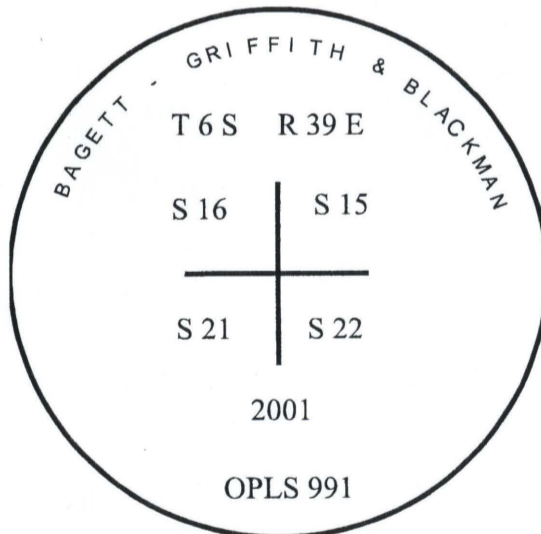

UNION COUNTY SURVEYOR
Date Received 3/30/01
Date Filed 4/14/01
Filed By R. ROBINSON, DEPUTY
File Number 024-2001R

I used a Leica 530 GPS unit in the establishment of the new accessories. The Basis of Bearings is the same as that shown on Survey No. 012-2001. The distances are to the center of a 5/8"x30" rebar with 1 1/2" aluminum cap marked Union County Survey Marker.

HORIZONTAL CONTROL DATA

UNION COUNTY, OREGON

OREGON STATE PLANE, NORTH ZONE (3601)

STA NAME: 200138

CORNER COMMON TO: 15,16,21,22

TWP. 6 S. RGE. 39 E.

GEODETIC COORD: NAD 83(91)

DATE TIED: 28 MARCH 2001

LAT: 45 ° 2 ' 8.08100 " N

SURVEYOR: GREGORY T. BLACKMAN
OPLS 991

LONG: 117 ° 55 ' 56.05457 " W

FIRM: BAGETT, GRIFFITH, & BLACKMAN
2006 ADAMS AVENUE
LAGRANDE, OR 97850
(541) 963-6092

SP. COOR: NAD 83(91)

N: 509612.418 INT FT.

E: 8865747.295 INT FT.

TYPE: GPS

THETA: 1 ° 49 ' 15.6768433 "

ORDER: SECOND CLASS: 1

SCALE FACTOR: 0.9998972713

ELEV: 3291.29 US FT.

ELEV: DATUM: NGVD 29

COMMENTS:

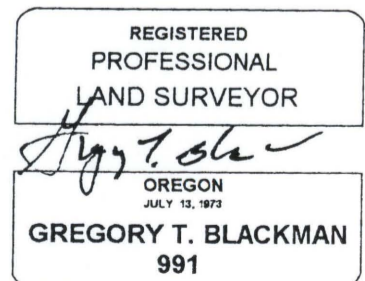
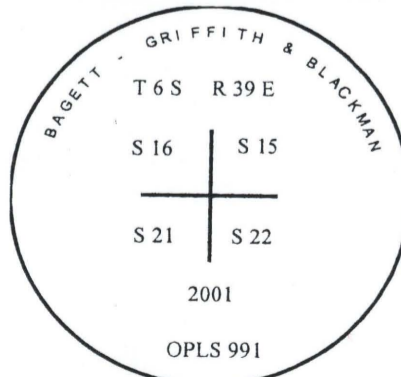

Renewal Date: Dec. 31, 2001

1 METER = 3.2808333333... US FEET = 39.37 INCHES

1 METER = 3.280839895 INT'L FEET OR 1 INCH = 2.54 CM

TO CALCULATE ELEVATION FACTOR (IN THE NORTH AMERICAN CONTINENT)

DIVIDE 20,906,000 BY (20,906,000 + ELLIPSOID ELEV. IN FEET)