

CERTIFIED RECORD OF LAND CORNER MONUMENTATION

HISTORY OF ORIGINAL CORNER ESTABLISHMENT:

Corner originally established by David P. Thompson under GLO Contract Number 103, dated September 1863. Surveyor General field notes states:

Set post for cor. to Secs. 8, 9, 16 and 17 in mound of earth, charred Stake, pits, trench as per instructions

Corner recovered by S.B. Morgan in Union County Highway Department survey of Wolf Creek Market Road completed Dec. 8, 1930. Survey states:

Section Corner Stone 5"x12"x18" located South 114.5' from Sta 32+73.

T 6 S R 39 E J-09

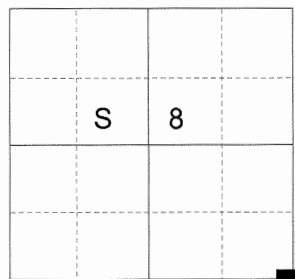

DESCRIPTION OF CORNER EVIDENCE FOUND:

None. An 1" axle, protruding 6" above ground bears North 1°02'27" East, a distance of 12.58 feet from true corner position, as established by retracement of county road.

SEE SURVEY NUMBER 011-2016

DESCRIPTION OF MONUMENT AND ACCESSORIES I ESTABLISHED

TO PERPETUATE THE ORIGINAL LOCATION OF THIS CORNER:

At record bearing and distance from Station 32+73, established by survey, I set a 2 1/2" x 30" aluminum pipe with 2 1/2" aluminum cap, marked as shown below, 24 inches in the ground, from which:

NEW BEARING OBJECTS:

The Southeast corner of a concrete base for a pivot bears North 40°56'04" East, a distance of 93.27 feet.

A 5/8" iron pin bears South 0°59'26" East, a distance of 20.72 feet, with 1 1/2" aluminum cap marked UNION COUNTY SURVEYOR S RP.

A 5/8" iron pin bears North 43°33'14" West, a distance of 58.41 feet, with 1 1/2" aluminum cap marked UNION COUNTY SURVEYOR NW RP.

Corner falls on in a North/South running fenceline.

I hereby certify that the corner was monumented on March 23, 2016.

REGISTERED
PROFESSIONAL
LAND SURVEYOR

OREGON
June 2, 2010
JEFFREY S. HSU
83571

Renewal Date: June 30, 2015

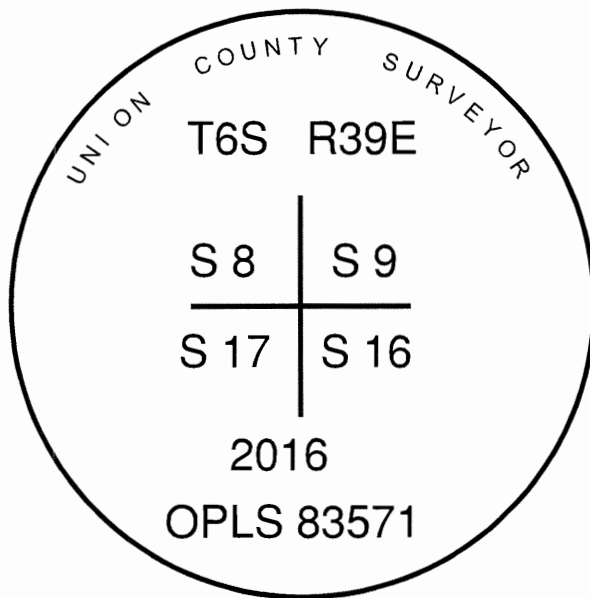

UNION COUNTY SURVEYOR

Date Received 3/28/16

Date Filed 3/28/16

Filed By [Signature]

File Number 006-2016R

I used a Leica GS-15 RTK GPS system for establishment of the accessories. Basis of bearing is as per Survey Number 011-2016.

HORIZONTAL CONTROL DATA

UNION COUNTY, OREGON

OREGON STATE PLANE, NORTH ZONE (3601)

STA NAME: 201607

SECTION CORNER COMMON TO SECTIONS 8, 9, 16 AND 17

TWP. 6 S. RGE. 39 E.

GEODETIC COORD: NAD 83(91)

DATE TIED: March 28, 2016

LAT: 45 ° 3 ' 0.20931 " N

SURVEYOR: RICK G. ROBINSON
OPLS 2219

LONG: 117 ° 57 ' 9.39240 " W

FIRM: BAGETT, GRIFFITH, & BLACKMAN
2006 ADAMS AVENUE
LAGRANDE, OR 97850
(541) 963-6092

SP. COOR: NAD 83(91)

N: 514722.133 INT FT.

E: 8860317.504 INT FT.

TYPE: GPS

THETA: 1 ° 48 ' 23.6666743 "

ORDER: SECOND CLASS: 1

SCALE FACTOR: 0.9998967185

ELEV: 3349.99 US FT.

ELEV: DATUM: NGVD 29

COMMENTS:

2 ½" aluminum monument marked as shown in North-South fenceline

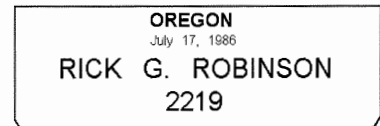
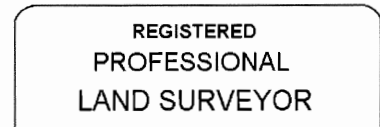
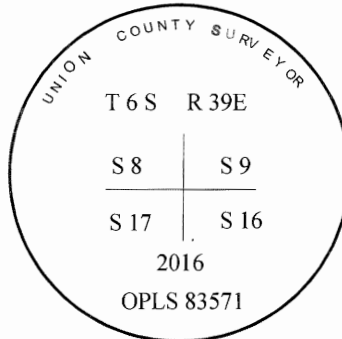

Renewal Date: December 31, 2016

1 METER = 3.2808333333... US FEET = 39.37 INCHES

1 METER = 3.280839895 INT'L FEET OR 1 INCH = 2.54 CM

TO CALCULATE ELEVATION FACTOR (IN THE NORTH AMERICAN CONTINENT)

DIVIDE 20,906,000 BY (20,906,000 + ELLIPSOID ELEV. IN FEET)