

**CERTIFIED RECORD OF LAND CORNER MONUMENTATION**

**HISTORY OF ORIGINAL CORNER ESTABLISHMENT:**

Corner originally established by David P. Thompson under GLO Contract Number 103, dated September 1863. Surveyor General field notes states:

Set post for 1/4 Sec. corner in mound of earth, charred Stake, pits, trench as per instructions

Corner recovered by S.B. Morgan in Union County Highway Department survey of Wolf Creek Market Road completed Dec. 8, 1930. Survey shows position of quarter corner at Station 59+46.7. Type of monument unspecified.

T 6 S R 39 E J-07

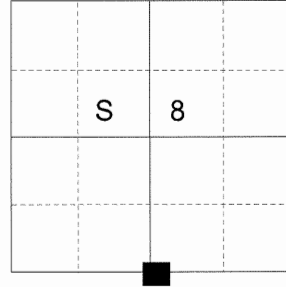

**DESCRIPTION OF CORNER EVIDENCE FOUND:**

None.

SEE SURVEY NUMBER 011-2016

**DESCRIPTION OF MONUMENT AND ACCESSORIES I ESTABLISHED**

**TO PERPETUATE THE ORIGINAL LOCATION OF THIS CORNER:**

At station 59+46.7, established by survey, I set a 5/8" x 30" copperclad iron rod with 2 1/2" brass cap, marked as shown below, 34 inches in the ground, in a valve box, from which:

**NEW BEARING OBJECTS:**

A 5/8" iron pin bears North 59°23' East, a distance of 38.31 feet, with 1 1/2" aluminum cap marked UNION COUNTY SURVEYOR NE RP.

A 5/8" iron pin bears South 43°02' East, a distance of 33.32 feet, with 1 1/2" aluminum cap marked UNION COUNTY SURVEYOR SE RP.

A 5/8" iron pin bears South 53°23' West, a distance of 32.90 feet, with 1 1/2" aluminum cap marked UNION COUNTY SURVEYOR SW RP.

A 5/8" iron pin bears North 62°18" West, a distance of 59.81 feet, with 1 1/2" aluminum cap marked UNION COUNTY SURVEYOR NW RP.

Corner falls at the intersection of Wolf Creek Road and a private road extending to the North.

I hereby certify that the corner was monumented on March 23, 2016.

REGISTERED  
PROFESSIONAL  
LAND SURVEYOR

OREGON  
June 2, 2010  
JEFFREY S. HSU  
83571

Renewal Date: June 30, 2015

UNION COUNTY  
SURVEYOR

Date Received 3/28/16

Date Filed 3/28/16

Filed By [Signature]

File Number 005-2016R

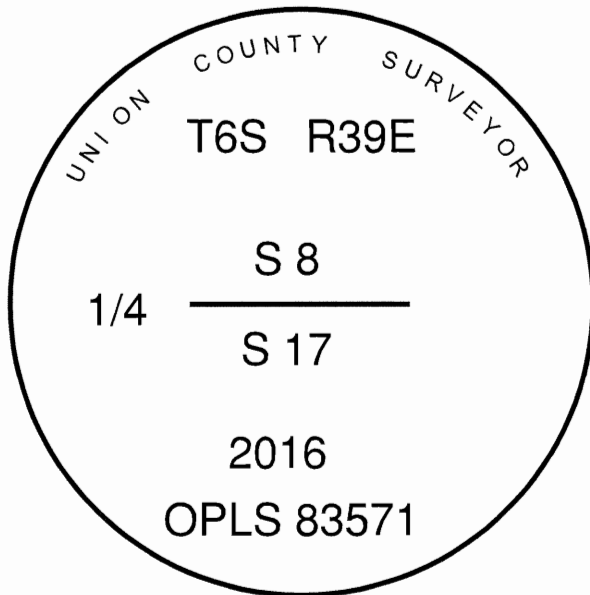

I used a Leica GS-15 RTK GPS system for establishment of the accessories. Basis of bearing is as per Survey Number 011-2016.

**HORIZONTAL CONTROL DATA**  
**UNION COUNTY, OREGON**  
**OREGON STATE PLANE, NORTH ZONE (3601)**

STA NAME: 201606

1/4 SECTION CORNER COMMON TO SECTIONS 8 AND 17

TWP. 6 S. RGE. 39 E.

GEODETIC COORD: NAD 83(91)

DATE TIED: March 28, 2016

LAT: 45 ° 3 ' 0.30779 " N

SURVEYOR: RICK G. ROBINSON  
OPLS 2219

LONG: 117 ° 57 ' 46.39171 " W

FIRM: BAGETT, GRIFFITH, & BLACKMAN  
2006 ADAMS AVENUE  
LAGRANDE, OR 97850  
(541) 963-6092

SP. COOR: NAD 83(91)

N: 514648.536 INT FT.

E: 8857662.451 INT FT.

TYPE: GPS

THETA: 1 ° 47 ' 57.4272828 "

ORDER: SECOND CLASS: 1

SCALE FACTOR: 0.9998967175

ELEV: 3379.93 US FT.

ELEV: DATUM: NGVD 29

COMMENTS:

2 1/2" "Copper clad" monument marked as  
shown in centerline of road in valve box

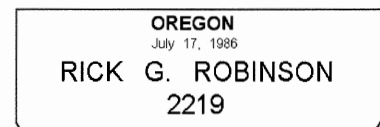
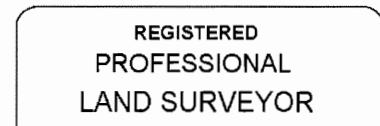
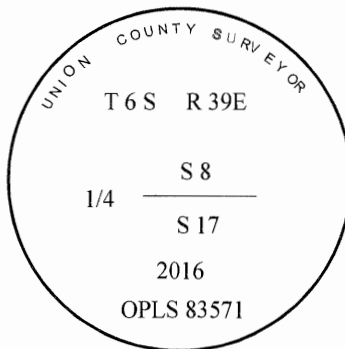

Renewal Date: December 31, 2016

1 METER = 3.2808333333... US FEET = 39.37 INCHES

1 METER = 3.280839895 INT'L FEET OR 1 INCH = 2.54 CM

TO CALCULATE ELEVATION FACTOR ( IN THE NORTH AMERICAN CONTINENT)

DIVIDE 20,906,000 BY (20,906,000 + ELLIPSOID ELEV. IN FEET)