

CERTIFIED RECORD OF LAND CORNER MONUMENTATION

HISTORY OF ORIGINAL CORNER ESTABLISHMENT:

Corner originally established by David P. Thompson under GLO Contract Number 103, dated September 1863. Surveyor General field notes states:

Set post for 1/4 Sec. corner in mound of earth, charred Stake, pits, trench as per instructions

Corner recovered by S.B. Morgan in Union County Highway Department survey of Wolf Creek Market Road completed Dec. 8, 1930. Survey shows position stone mound accepted as quarter corner at a point 774' North of Station 114+20.0.

T 6 S R 39 E J-03

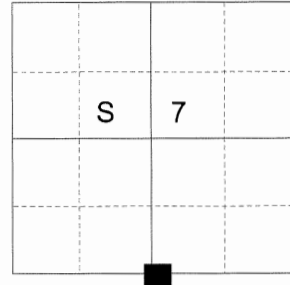

DESCRIPTION OF CORNER EVIDENCE FOUND:

None.

SEE SURVEY NUMBER 011-2016

DESCRIPTION OF MONUMENT AND ACCESSORIES I ESTABLISHED TO PERPETUATE THE ORIGINAL LOCATION OF THIS CORNER:

At a point 774 ft. North of Station 114+20.0, established by survey, I set a 5/8" x 30" copperclad iron rod with 2 1/2" brass cap, marked as shown below, 56 inches in the ground, from which:

The Southeast corner of a concrete base for a pivot bears North 5°41' West, a distance of 944.96 feet.

A 5/8" iron pin bears South 15°28' East, a distance of 766.72 feet, with 1 1/2" aluminum cap marked UNION COUNTY SURVEYOR SE RP.

A 5/8" iron pin bears South, a distance of 743.73 feet, with 1 1/2" aluminum cap marked UNION COUNTY SURVEYOR S RP.

A 5/8" iron pin bears South 28°55' West, a distance of 859.18 feet, with 1 1/2" aluminum cap marked UNION COUNTY SURVEYOR SW RP.

Corner falls in a tilled agricultural field, approximately 10 feet East of the East edge of a North/South running gravel farm road.

I hereby certify that the corner was monumented on March 28, 2016.

REGISTERED
PROFESSIONAL
LAND SURVEYOR

OREGON
June 2, 2010
JEFFREY S. HSU
83571

Renewal Date: June 30, 2015

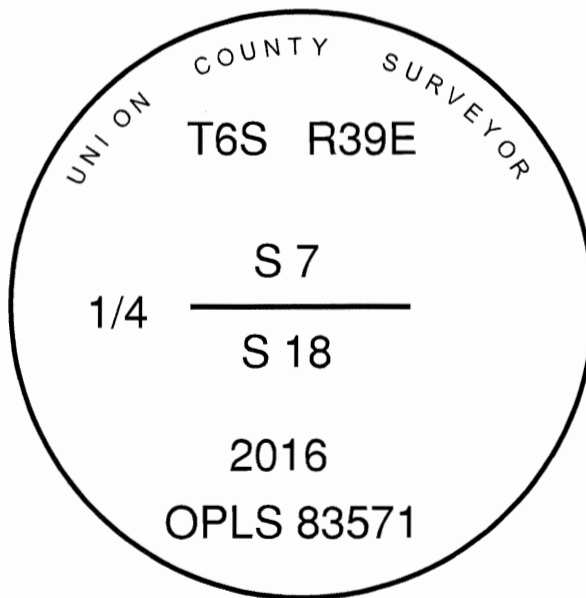

UNION COUNTY
SURVEYOR
Date Received 3/28/16
Date Filed 3/28/16
Filed By [Signature]
File Number 003-2016R

I used a Leica GS-15 RTK GPS system for establishment of the accessories. Basis of bearing is as per Survey Number 011-2016.

HORIZONTAL CONTROL DATA

UNION COUNTY, OREGON

OREGON STATE PLANE, NORTH ZONE (3601)

STA NAME: 201604

1/4 SECTION CORNER COMMON TO SECTIONS 7 AND 18

TWP. 6 S. RGE. 39 E. GEODETIC COORD: NAD 83(91)

DATE TIED: March 28, 2016 LAT: 45 ° 3 ' 0.68700 " N

SURVEYOR: RICK G. ROBINSON LONG: 117 ° 58 ' 59.51468 " W
OPLS 2219

FIRM: BAGETT, GRIFFITH, & BLACKMAN SP. COOR: NAD 83(91)
2006 ADAMS AVENUE
LAGRANDE, OR 97850 N: 514522.763 INT FT.
(541) 963-6092 E: 8852414.575 INT FT.

TYPE: GPS THETA: 1 ° 47 ' 5.56949669 "

ORDER: SECOND CLASS: 1 SCALE FACTOR: 0.9998967137

ELEV: 3447.55 US FT.

ELEV: DATUM: NGVD 29

COMMENTS:

2 1/2" "Copper clad" monument marked as shown 56" in the ground in tilled field

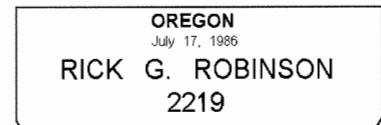
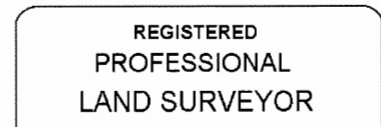
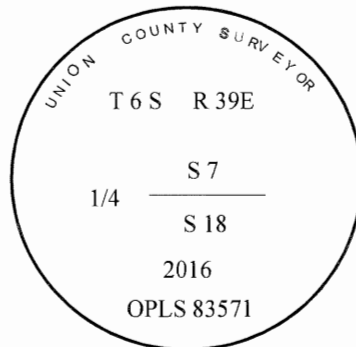

Renewal Date: December 31, 2016

1 METER = 3.2808333333... US FEET = 39.37 INCHES

1 METER = 3.280839895 INT'L FEET OR 1 INCH = 2.54 CM

TO CALCULATE ELEVATION FACTOR (IN THE NORTH AMERICAN CONTINENT)

DIVIDE 20,906,000 BY (20,906,000 + ELLIPSOID ELEV. IN FEET)