

LINE DATE 5-2-43 PARTY Morgan
PROJECT Private C. Hargett
Jacobson D. Hargett

13

2145 FC. Line

South

13+20 1/4 cor. 90°00 Rt

Beginning at 1/4 cor. between 27-28
T65R38EWM. Found Vitars Tree
36" Pipe

CERTIFIED RECORD OF LAND CORNER MONUMENTATION

HISTORY OF ORIGINAL CORNER ESTABLISHMENT:

Corner originally established by David P. Thompson and Daniel Chaplin under GLO contract Number 104, dated April 16, 1864. Surveyor General record states:

Set post corner for 1/4 section.

Survey Number 7, by J.W. Kimbrell dated 1887 notes existing corner out of place and re-established it by setting a post 4" square and 3 1/2" long, made mound and pits from which;

A 24" dia. pine bears S 75°E, a distance of 288 lks.

A 10" dia. pine bears S 64°W, a distance of 94 lks.

Survey Number 006-2010, by James Hanley dated April 21, 1994.

Notes finding 1 1/2" smooth rod in split rail fence line.

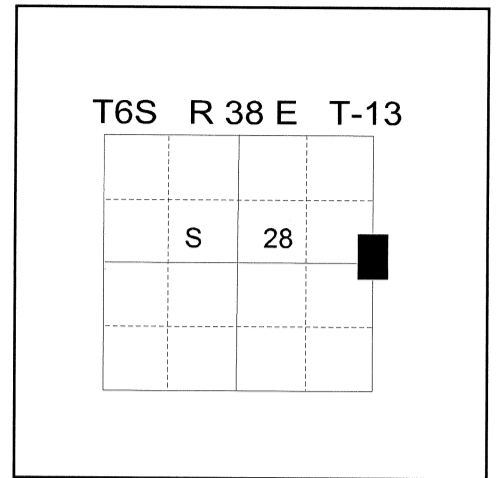

DESCRIPTION OF CORNER EVIDENCE FOUND:

Found 1 1/2" smooth rod in split rail fence line, along with a 44"dia. High stumped pine with visible scribes that bears S 70°E, a distance of 193.60 feet to face of blaze.

DESCRIPTION OF MONUMENT AND ACCESSORIES I ESTABLISHED TO PERPETUATE THE ORIGINAL LOCATION OF THIS CORNER:

At the found smooth rod, I set a 2 1/2"x30" aluminum pipe with aluminum cap, marked as shown, 27 inches in the ground, over the top of existing 1 1/2" pipe with small mound of stone from which;

NEW BEARING TREES AND OBJECT:

A 5/8"X30" iron pin with aluminum cap marked Union County Surveyor NE RP, which bears North 60° East a distance of 28.85 feet in split rail fence.

A 5/8"X30" iron pin with aluminum cap marked Union County Surveyor SE RP, which bears South 16° East a distance of 7.15 feet in split rail fence.

A 5/8"X30" iron pin with aluminum cap marked Union County Surveyor SW RP, which bears West a distance of 2.20 feet in split rail fence.

A 5/8"X30" iron pin with aluminum cap marked Union County Surveyor NW RP, which bears North 6° West a distance of 14.05 feet in split rail fence.

I hereby certify that the corner was monumented on March 16, 2010.

Witness: Greg T. Blackman Jr. and Jeff Hsu

REGISTERED
PROFESSIONAL
LAND SURVEYOR

Rick G. Robinson
OREGON
July 17, 1986
RICK G. ROBINSON
2219

Renewal Date: December 31, 2010

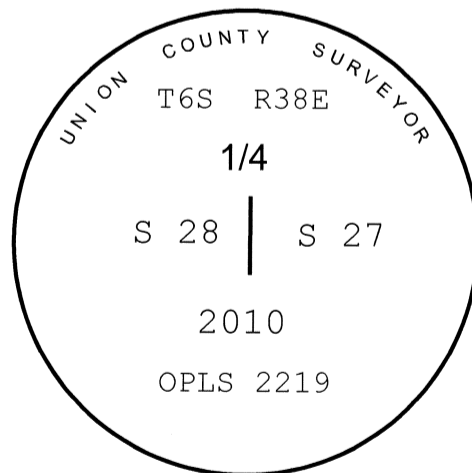

UNION COUNTY SURVEYOR

Date Received 4/15/10

Date Filed 4/15/10

Filed By *Greg T. Blackman Jr.*

File Number 015-2010R

I used a steel tape and magnetic compass in the establishment of the new accessories. I used 18° East declination, the distances are to the center of the aluminum cap.

HORIZONTAL CONTROL DATA

UNION COUNTY, OREGON

OREGON STATE PLANE, NORTH ZONE (3601)

STA NAME: 201005

1/4 SECTION CORNER COMMON TO SECTIONS: 27 and 28

TWP. 6 S. RGE. 38 E.

GEODETIC COORD: NAD 83(91)

DATE TIED: March 16, 2010

LAT: 45 ° 0 ' 49.97851 " N

SURVEYOR: RICK G. ROBINSON
OPLS 2219

LONG: 118 ° 3 ' 15.19991 " W

FIRM: BAGETT, GRIFFITH, & BLACKMAN
2006 ADAMS AVENUE
LAGRANDE, OR 97850
(541) 963-6092

SP. COOR: NAD 83(91)

N: 500728.412 INT FT.

E: 8834469.153 INT FT.

TYPE: GPS

THETA: 1 ° 44 ' 4.24110495 "

ORDER: SECOND CLASS: 1

SCALE FACTOR: 0.9998982185

ELEV: 3525.09 US FT.

ELEV: DATUM: NGVD 29

COMMENTS:

Corner is 2 1/2"x30" aluminum pipe with
2 1/2" aluminum cap marked as shown:
Monument is set 27" in the ground in a
split rail fence line.

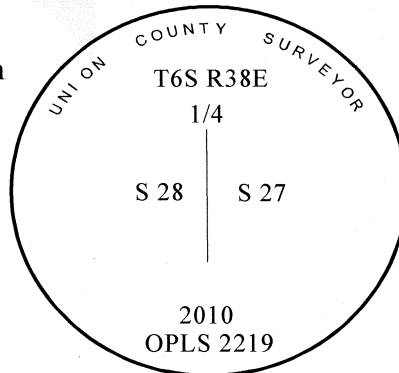

REGISTERED
PROFESSIONAL
LAND SURVEYOR

R. G. Robinson
OREGON
July 17, 1988
RICK G. ROBINSON
2219

Renewal Date: December 31, 2010

1 METER = 3.280833333... US FEET = 39.37 INCHES

1 METER = 3.280839895 INT'L FEET OR 1 INCH = 2.54 CM

TO CALCULATE ELEVATION FACTOR (IN THE NORTH AMERICAN CONTINENT)

DIVIDE 20,906,000 BY (20,906,000 + ELLIPSOID ELEV. IN FEET)