

Subdivisions, T. 6 S., R. 38 E.

4-673b

Chains	North, bet. secs. 28 and 29. Var. 19°E.
1.00	Creek, 15 lks. wide, runs SE.
40.00	Set post for $\frac{1}{4}$ sec. cor. in mound of earth with charred stake, pits, trench, etc. as per instructions.
80.00	Set post for cor. to secs. 20, 21, 28, and 29; from which A cottonwood, 16 ins. dia., bears N.65°W., 12 lks. 79 A cottonwood, 24 ins. dia., bears N.65°E., 8 lks. 53 A cottonwood, 10 ins. dia., bears S.50°E., 18 lks. 119 An alder, 6 ins. dia., bears S.30°W., 25 lks. 165
	Land, hilly. Soil, 2nd rate. Scattering pine with cottonwood on the streams.
	East, on a random line bet. secs. 21 and 28.
40.00	Set post for temporary $\frac{1}{4}$ sec. cor.
80.00	Intersect N. and S. line at cor. to secs. 21, 22, 27, and 28, from which cor. I run
	West, on a true line bet. secs. 21 and 28.
40.00	Set $\frac{1}{4}$ sec. cor. in a mound of stone. Found Cor. Iron Pipe Rock Marked $\frac{1}{4}$ S Oct 13, 1937
70.00	Enter timber, bears N. and S.
74.00	Creek, 15 lks. wide, runs SE.
78.15	Swamp in clump of cottonwood timber.
80.00	The cor. to secs. 20, 21, 28, and 29. Variation 19°E.
	Land, rough and broken. Soil, 3rd rate. Some scattering pine timber.
	June 28th, 1864.

Subdivisions, T. 6 S., R. 38 E.  
 Surveyed by W. B. Barr under Contract  
 No. 388, dated May 7, 1881.

Commencing at cor. to secs. 21, 22, 27, and 28 in T. 6 S.,  
 R. 38 E., post in mound of earth with pits and trench.  
 Post decayed, I re-established by planting basalt rock,  
 16x10x10.  
 North, bet. secs. 21 and 22.  
 Var. 21°E.

**CERTIFIED RECORD OF LAND CORNER MONUMENTATION**

**HISTORY OF ORIGINAL CORNER ESTABLISHMENT:**

Corner originally established by David P. Thompson and Daniel Chaplin under GLO contract Number 104, dated April 16, 1864. Surveyor General record states:

Set post corner for 1/4 sec in mound of stone.

Survey Number 7, by J.W. Kimbrell dated 1887 notes Found Post in mound of Stone.

Survey Number 167, by S.B. Morgan dated September 25, 1938. Notes finding Stone marked "1/4 S".

Survey Number 45-78, by James Hanley dated April 7, 1978. Notes finding a 1 1/2" unrecorded pipe and Stone marked "1/4" alongside of pipe.

Survey Number 006-2010, by James Hanley dated April 21, 1994. Notes finding 1" pipe in mound of stone.

**DESCRIPTION OF CORNER EVIDENCE FOUND:**

Found 1 1/2" pipe in mound of stone, looked for marked stone but found no visible marks on any stones in mound.

**DESCRIPTION OF MONUMENT AND ACCESSORIES I ESTABLISHED TO PERPETUATE THE ORIGINAL LOCATION OF THIS CORNER:**

At the found pipe in mound of stone, I set a 2 1/2"x30" aluminum pipe with aluminum cap, marked as shown, 25 inches in the ground, over the top of existing 1 1/2" pipe from which;

**NEW BEARING TREES AND OBJECT:**

A 5/8"x30" iron pin with aluminum cap marked Union County Surveyor NE RP, which bears North 12° East a distance of 12.55 feet.

A 5/8"x30" iron pin with aluminum cap marked Union County Surveyor SE RP, which bears South 59° East a distance of 32.60 feet in right of way fence.

A 5/8"x30" iron pin with aluminum cap marked Union County Surveyor SW RP, which bears South 49° West a distance of 12.60 feet.

A 5/8"x30" iron pin with aluminum cap marked Union County Surveyor NW RP, which bears North 48° West a distance of 17.20 feet.

I hereby certify that the corner was monumented on March 16, 2010.  
Witness: Greg T. Blackman Jr. and Jeff Hsu

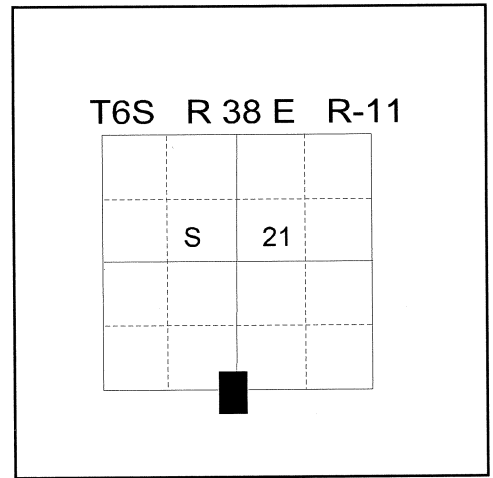

REGISTERED  
PROFESSIONAL  
LAND SURVEYOR

*Rick G. Robinson*  
OREGON  
July 17, 1986  
RICK G. ROBINSON  
2219

Renewal Date: December 31, 2010

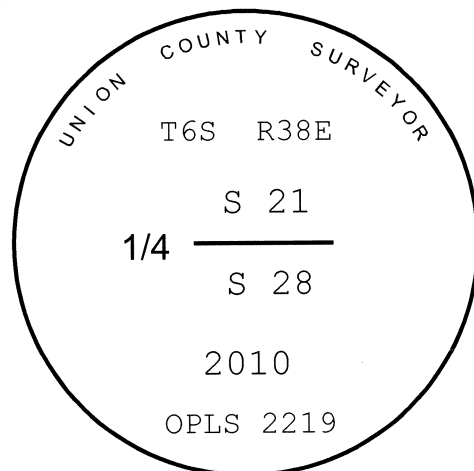

**UNION COUNTY SURVEYOR**

Date Received 4/15/10

Date Filed 4/15/10

Filed By *Greg T. Blackman*

File Number 016-2010R

I used a steel tape and magnetic compass in the establishment of the new accessories. I used 18° East declination, the distances are to the center of the aluminum cap.

# HORIZONTAL CONTROL DATA

## UNION COUNTY, OREGON

### OREGON STATE PLANE, NORTH ZONE (3601)

STA NAME: 201006

1/4 SECTION CORNER COMMON TO SECTIONS: 21 and 28

TWP. 6 S. RGE. 38 E.

GEODETIC COORD: NAD 83(91)

DATE TIED: March 16, 2010

LAT: 45 ° 1 ' 19.13561 " N

SURVEYOR: RICK G. ROBINSON  
OPLS 2219

LONG: 118 ° 3 ' 53.82209 " W

FIRM: BAGETT, GRIFFITH, & BLACKMAN  
2006 ADAMS AVENUE  
LAGRANDE, OR 97850  
(541) 963-6092

SP. COOR: NAD 83(91)

N: 503596.001 INT FT.

E: 8831607.129 INT FT.

TYPE: GPS

THETA: 1 ° 43 ' 36.8507937 "

ORDER: SECOND CLASS: 1

SCALE FACTOR: 0.9998978482

ELEV: 3691.05 US FT.

ELEV: DATUM: NGVD 29

**COMMENTS:**

Corner is 2 1/2"x30" aluminum pipe with  
2 1/2" aluminum cap marked as shown:  
Monument is set 25" in the ground in a  
mound of stone 50'+/- North of Road.

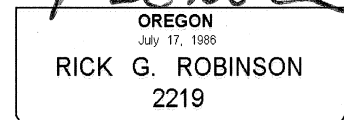
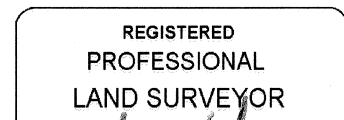
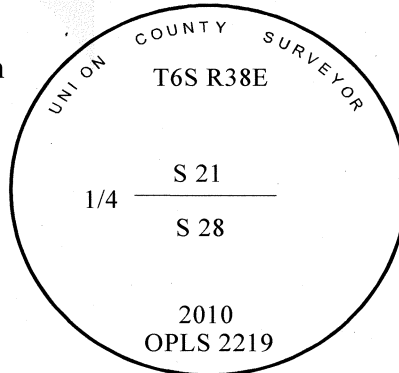

Renewal Date: December 31, 2010

1 METER = 3.280833333... US FEET = 39.37 INCHES

1 METER = 3.280839895 INT'L FEET OR 1 INCH = 2.54 CM

TO CALCULATE ELEVATION FACTOR ( IN THE NORTH AMERICAN CONTINENT)

DIVIDE 20,906,000 BY (20,906,000 + ELLIPSOID ELEV. IN FEET)