

**UNION COUNTY SURVEYOR
CERTIFIED RECORD OF LAND CORNER MONUMENTATION**

HISTORY OF ORIGINAL CORNER ESTABLISHMENT:

Corner originally established by W. B. Barr, under GLO contract Number 388, dated May 7, 1881. Surveyor General record states: Set 12x10x10 Basalt rock for ¼ corner, raised a mound of stone

No record of subsequent monumentation found in Union County survey records

DESCRIPTION OF CORNER EVIDENCE FOUND:

Found basalt stone 15x12x7 with a + on top and ¼ on South face w/ several small stones around it. Stone was previously found by Bill Wells OPLS 1106. Found remains of approximately 600 ft. of fence line running West from the corner stone. Wire down on ground and post remains in a direct line.

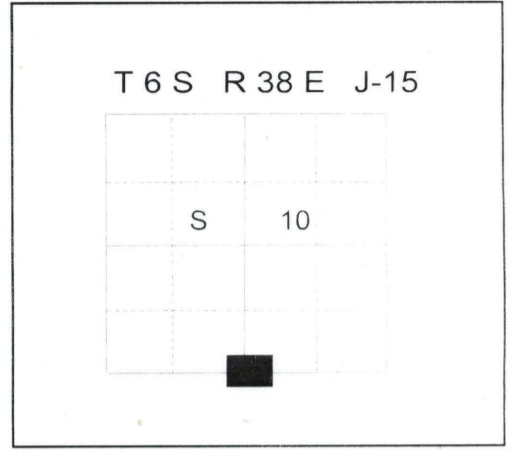

DESCRIPTION OF MONUMENT AND ACCESSORIES I ESTABLISHED

TO PERPETUATE THE ORIGINAL LOCATION OF THIS CORNER:

In place of the stone, I set a 2½x30" aluminum pipe with aluminum cap marked as shown below 30" in the ground and placed 2 small stones around the monument. I buried the marked stone North of the new monument.

NEW BEARING OBJECTS:

- An 18" Ponderosa Pine bears N 23°E, a distance of 49.07 feet, marked X BT.
- A 13" Ponderosa Pine bears S 59°E, a distance of 99.62 feet, marked X BT.
- An 8" Ponderosa Pine bears S 18°W, a distance of 38.07 feet, marked ¼ S15 BT.
- An 8" Ponderosa Pine bears N 59°W, a distance of 24.03 feet, marked ¼ S10 BT.

I hereby certify that the corner was monumented on May 22, 2002.
Witness: Rick Robinson, David Trapp, Norm Records.

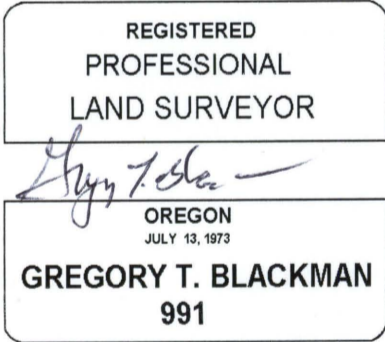

Renewal Date: December 31, 2003

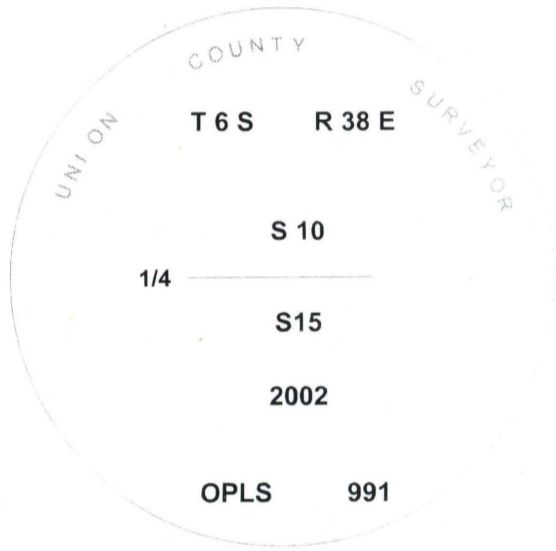

I used a steel tape and magnetic compass in the establishment of the new accessories. I used 19° East declination. I set a 60d spike in the right side of the Root Crown and placed a brass washer marked OPLS 991 in the BT blaze.

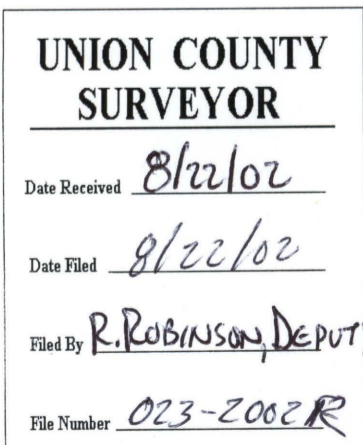

HORIZONTAL CONTROL DATA
UNION COUNTY, OREGON
OREGON STATE PLANE, NORTH ZONE (3601)

STA NAME: 200928

QUARTER CORNER COMMON TO SECTIONS 10 AND 15

TWP. 6 S RGE. 38 E.

GEODETIC COORD: NAD 83(91)

DATE TIED: September 29, 2009

LAT: 45 ° 3 ' 1.99178 " N

SURVEYOR: RICK ROBINSON
OPLS 2219

LONG: 118 ° 2 ' 38.40406 " W

FIRM: BAGETT, GRIFFITH, & BLACKMAN
2006 ADAMS AVENUE
LAGRANDE, OR 97850
(541) 963-6092

SP. COOR: NAD 83(91)

N: 514171.325 INT FT.

E: 8836704.709 INT FT.

TYPE: GPS

THETA: 1 ° 44' 30.3 "

ORDER: SECOND CLASS: 1

SCALE FACTOR: 0.9998967007

ELEV: 3957.8322 US FT.

ELEV: DATUM: NGVD 29

COMMENTS:

Corner is a 2 1/2" aluminum cap monument
Cap is marked as shown.

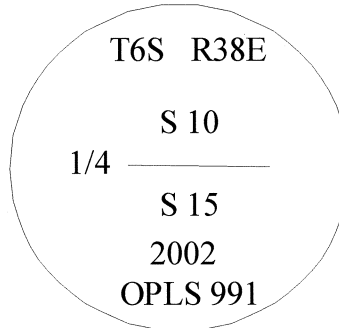

1 METER = 3.2808333333... US FEET = 39.37 INCHES

1 METER = 3.280839895 INT'L FEET OR 1 INCH = 2.54 CM

TO CALCULATE ELEVATION FACTOR (IN THE NORTH AMERICAN CONTINENT)

DIVIDE 20,906,000 BY (20,906,000 + ELLIPSOID ELEV. IN FEET)

Renewal Date: December 31, 2010