

CERTIFIED RECORD OF LAND CORNER MONUMENTATION

Index File No. A-25

History of original corner establishment:

A basalt stone 12"x10"x10", 8" in ground. from which:

- a 12" W. Larch bears S50°E, 185 lks.
- a 48" W. Larch bears S45°W, 30 lks.
- a 24" fir bears N10°W, 25 lks.

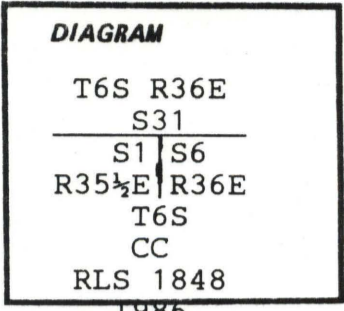

Original corner established in 1881 by Eugene P. McCornack under contract #398

Description of corner evidence found:

Orig. stone found no marks, bearings good to orig BT stumps, dists a little off.

- A 48" W. Larch stump bears S45°W, 16.8 Ft.
- A 20" W. Larch stump bears S50°E, 17.0 Ft.
- A 20" Fir stump bears N8°W, 21.8 Ft.

Description of monument and accessories established to perpetuate the original location of this corner:

Cap is stamped:

Set 2½"x30" aluminum capped aluminum pipe rising 6" in mound of stones and earth Set steel fencepost 3' north of corner.

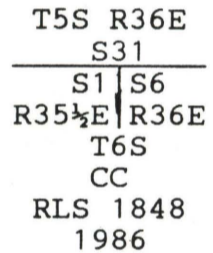

New BT's

- A 7½" W. Larch bears S3½°W, 6.6 ft., blazed&scribed CC T6S R35½E S1 BT
- A 10½" W. Larch bears S54½°E 105.8 Ft., blazed&scribed CC T6S R36E S6 BT

Painted blazes and attached signs as required in Specifications for Cadastral Surveys, USFS Region 6, March, 1982.

Compass Declination: 19½°E

Witness: J. Sutton

I hereby certify that the above described corner monument and/or accessories was perpetuated as hereon described on July 12, 1986.

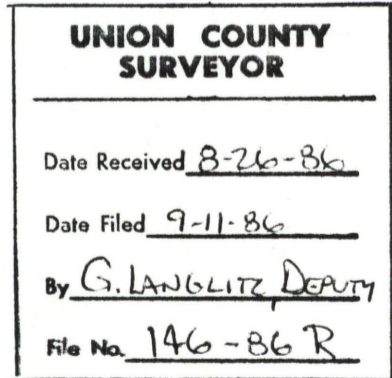

Office of..... County of..... **SEE SURVEY 27-86**
 State of....., I hereby certify that the within instrument was filed in this office
 for record on the..... day of....., 19.....
 by
 (COUNTY OFFICIAL) (DEPUTY)

CERTIFIED RECORD OF LAND CORNER MONUMENTATION

Index File No. A-25

History of original corner establishment:

A basalt stone 12"x10"x10", 8" in ground,
From which:
A 12" W. Larch bears S50°E, 185 lks.
A 48" W. Larch bears S45°W, 30 lks.
A 24" Fir bears N10°W, 25 lks.

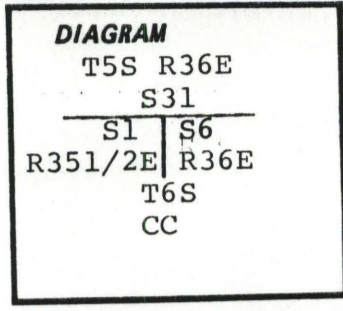

Original corner established in 1881 by Eugene P. McCornack under contract #398.

This corner was previously recorded for a survey by me under Union County Surveyor File No. 146-86R (Date 9-11-86) and this new record is made to clarify the corner information as shown below. It is intended to supercede said File No. 146-86R.

Description of corner evidence found:

Original stone found, no marks, bearings good to original BT stumps, distances off as follows:
A 48" W. Larch stump bears S45°W, 16.8 ft. (base of blaze BT visible)
A 20" W. Larch stump bears S50°E, 117.0 ft. (opened blaze, BT visible)
A 20" Fir stump bears N8°W, 21.8 ft. (full scribing visible)

Description of monument and accessories I established to perpetuate the original location of this corner:

Cap is stamped:

At the point of intersection of the line between R35 1/2E and R36E with the south line of Section 31, T5S, R36E, I set a 2 1/2"x30" aluminum capped aluminum pipe rising 6" in a mound of stones with the original buried along the north side of the pipe in the mound. Set a steel fence post 3 ft. north of corner. From the aluminum monument, I marked the following new bearing trees:

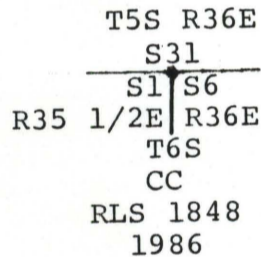

A 7 1/2" W. Larch bears S3 1/2°W, 6.6 ft.,
blazed and scribed CC T6S R35 1/2ES1BT.
A 10 1/2" W. Larch bears S54 1/2°E, 105.8 ft.,
blazed and scribed CC T6S R36E S6BT.

Painted blazes and attached signs as required in Specifications for Cadastral Surveys, USFS Region 6, March 1982.

Compass Declination: 19 1/2°E
Witness: J. Sutton

I hereby certify that the above described corner monument and/or accessories was perpetuated as hereon described on July 12, 1986.

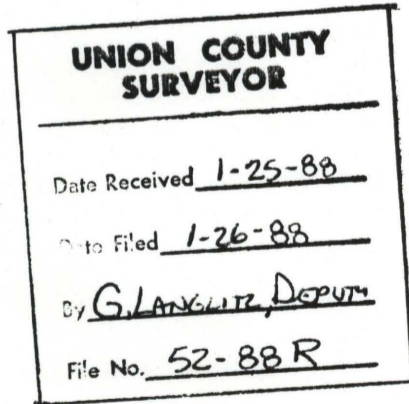

Office of..... County of.....
State of....., I hereby certify that the within instrument was filed in this office
for record on the..... day of....., 19.....
..... by

(COUNTY OFFICIAL) (DEPUTY)