

1. T. 6S R. 35E No. R17 Cor. Sec. Mer Will State Oregon N. F. Wallowa Whitman Dist. LaGrande

2. Corner Status

R-17

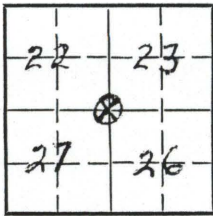

7. Photo Identification BC-5
Photo No. UBM-0 8/E/60
Ident. By: R.J.C. 10/29/64

8. Plane Coordinate Position Data
State _____ Zone _____
X _____
Y _____
Estab. By _____
Field Book No. _____
Where Filed _____

9. Evaluation
Authentic
Needs Verif. Monument no
Re-estab. Survey
Land Status AG

3. Original Description _____ Vol. _____ Page _____ Where Recorded _____

4. Description of Corners: Established 1884 by G.O. contract Survey.
Set a basalt stone 6x6x6 ins. 11 ins. in ground, marked 2
notches on S. + E' edges. A fir 6 in. bears N60°E 28 LKS, A 6 in. LP
bears S10°E 22 LKS, A 12" WL bears S79°W 19 LKS. A 5" Fir bears
N40°W 19 LKS. (See item 1A)

5. Investigation Notes: Found 4" x 10" stone 8" above ground. No visible
markings. A 13" WL B.T. bears S78°W 13 ft. dist. A 10" LP. B.T.
bears S12°E 13' dist.

Ran line south from location tag on Sheep Creek
trail. Crossed Sheep Cr. and climbed moderate-steep
grade. Cor. is just below a Knoll at the top of the
slope. Line is well blazed.

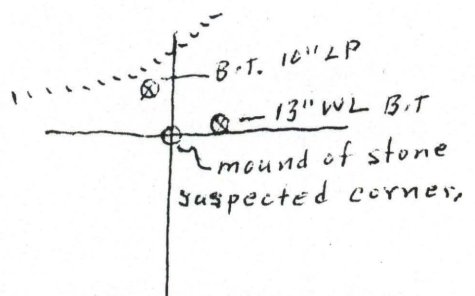

6. Signed Robert Chadwick Title forester Date 10/29/64

UNION COUNTY SURVEYOR

Date Received _____

Date Filed 12-23-87

By G. LANGLITZ, DEPUTY

File No. 368-87R

R-17