

CERTIFIED RECORD OF LAND CORNER MONUMENTATION

Index File No. E-09

History of original corner establishment:

Original subdivision of T6S, R35E was by Herman D. Gradon under Contract No 499, approved November 24, 1884. At this corner he set a stone 17x12x6, from which an 8" Pine bears N73°E, 20 lks. and mounds.

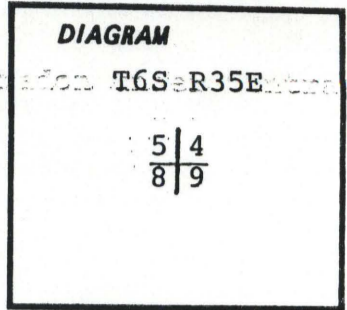

Description of corner evidence found:

No corner monument found.

Bearing Trees Found:

A 24" Tamarack bears N58°E, 20.46 ft., scribing partly healed.  
A stump hole bears S15°W, 10 ft., with rotted remains of tree, scribing faint.

Description of monument and accessories established to perpetuate the original location of this corner:

Cap is stamped:

Set 2.5" aluminum cap on 2 3/8"x30" aluminum pipe rising 11" above ground. Set steel fence post 3.0 ft. north of corner.

T6S R35E  
 S5 | S4  
 S8 | S9  
 RLS 1844  
 1984

New BT's:

- An 8" Fir bears N31°W, 10.8 ft., blazed and scribed: T6S R35E S5 BT.
- A 10" Fir bears S7.5°W, 8.6 ft., blazed and scribed: T6S R35E S8 BT.
- A 6" Fir bears S55°E, 24.1 ft., blazed and scribed: T6S R35E S9 BT.

Brass LS 1844 disc in lower end of blazes. Painted blazes and attached signs as per Standard Specifications for Cadastral Surveys, USFS Region 6, March 1982.

Compass Declination: 19 3/4°E

Witness: Duane Scott

To find corner, from Rd. 5160 take 5160-155 northwesterly to corner. (1/2 mi.)

I hereby certify the above described corner monument and/or accessories was established as described on September 19, 1984.

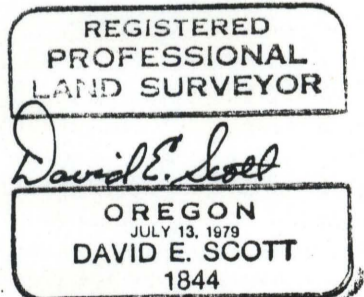

Office of..... County of.....

State of....., I hereby certify that the within instrument was filed in this office for record on the..... day of....., 19.....

..... by .....  
 (COUNTY OFFICIAL) (DEPUTY)

<b>UNION COUNTY SURVEYOR</b>	
Date Received	<u>10-17-84</u>
Date Filed	<u>10-24-84</u>
By	<u>G. LANGLITZ DEPUTY</u>
File No.	<u>1007-84 R</u>