

CERTIFIED RECORD OF LAND CORNER MONUMENTATION

History of original corner establishment:

Original survey made by General Land office contract survey 1881  
The original notes state. Set a post from which.  
A tamarack 8" in diam bears S48°E 7 lks dist marked T6S R35E S1BT;  
A tamarack 16" in diam bears S61°W 53 lks dist marked T6S R35E S2BT;

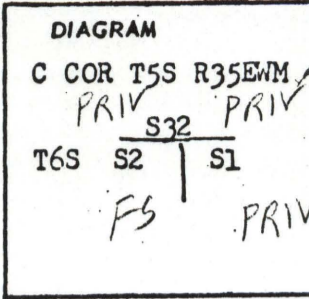

Description of corner evidence found:

A tamarack snag 9" in diam bears S48°E.  
A tamarack 18" in diam bears S61°W 53 lks dist. Tree in good shape.  
We found the original post marked for the corner.

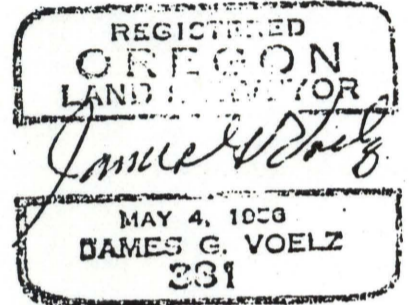

Description of monument and accessories I established to perpetuate the original location of this corner

At the position of the corner I set a 2" galvanized pipe 30" long with bronze cap on top and 8" plate welded to bottom. The pipe set to a depth of 24".

I stamped the disk.

CCOR T5S R35E

S32

From the position of the corner the original bearing tree is;  
A tamarack 18" in diam bears S61°W 53 lks dist.  
I set the following new bearing trees;  
A tamarack 13" in diam bears S32°E 29.6 ft. dist marked T6S R35E S1BT;  
A tamarack 14" in diam bears N55°E 35 ft. dist marked T5S R35E S32BT;  
Distance measured to center of the respective trees and marked with a scribe.  
I set a steel fence post with USFS sign 54-4 attached. USFS National Forest boundary signs were attached to post indicating National Forest land to South and West. We nailed the original post to a tree adjacent to corner.

T6S S2 | S1  
ORE LIC 381  
1969

Office of ..... County surveyor ..... County of ..... Union .....  
State of ..... Oregon ..... , I hereby certify that the within instrument was filed in this office  
for record on the 17 day of Sept ..... 1969, at 8 o'clock A. m., (signed)  
County surveyor ..... by James G. Voelz  
(COUNTY OFFICIAL) (DEPUTY)

UNION COUNTY SURVEYOR  
Date Received \_\_\_\_\_  
Date Filed \_\_\_\_\_  
By G. LANGLITZ, DEPUTY  
File No. 945-84 R

CERTIFIED RECORD OF LAND CORNER MONUMENTATION

Index File No. A-21

History of original corner establishment:

The Original subdivision of T6S, R35E was by Herman D. Gradon under Contract No. 499, approved November 24, 1884. At this corner he set a post, from which an 8" Tamarack bears S48°E, 7 lks. and a 16" Tamarack bears S68°W, 53 lks.

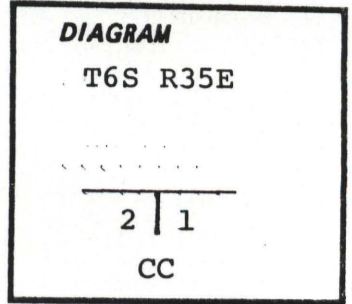

(Old Location)

Description of corner evidence found:

Found 3" brass cap on 2" iron pipe rising 6" above ground. Cap is stamped;

Bearing trees found;

- A 19" Tamarack bears S68°W, 35.6 ft., healed blaze.
- An 8" Tamarack bears S48°E, 4.62 ft., dead, scribed (CC T6S R35E S1 BT).
- A 17" Tamarack bears N61°E, 32.3 ft., scribed (T5S R35E S32 BT).

C COR  
T5S R35E  
.....  
S32  
S2|S1  
T6S  
ORE LIC 381  
1969

Previous corner certificate not on file.

Description of monument and accessories | established to perpetuate the original location of this corner:

Added letters AM to cap.

New BT;

15" Tamarack bears East, 4.3 ft., blazed and scribed (CC T6S R35E S1 BT).

C COR AM  
T5S R35E  
.....  
S32  
S2|S1  
T6S  
ORE LIC 381  
1969

Painted blazes and attached signs as per Standard Specifications for Cadastral Surveys, USFS Region 6, March 1982.

Compass Declination; 19 3/4°E

Witness: Duane Scott

Corner is found 1250 ft. west of East Sheep Creek, 1.75 mi. north of Road 5160. Take Toad 5160-140 0.5 mi, take right fork to fence, 1/2 mi. north along fence.

I hereby certify the above described corner monument and/or accessories was established as described September 19, 1984.

REGISTERED PROFESSIONAL LAND SURVEYOR
---------------------------------------------

*David E. Scott*

OREGON JULY 13, 1979 DAVID E. SCOTT 1844
---------------------------------------------------

Office of..... County of.....

State of....., I hereby certify that the within instrument was filed in this office for record on the..... day of....., 19.....

..... by .....  
(COUNTY OFFICIAL) (DEPUTY)

<b>UNION COUNTY SURVEYOR</b>
Date Received <u>10-17-84</u>
Date Filed <sup>★GPO-798-24</sup> <u>10-24-84</u>
By <u>G. LANGLITZ DEPUTY</u>
File No. <u>998-84R</u>

CERTIFIED RECORD OF LAND CORNER MONUMENTATION

Index File No. A-21

History of original corner establishment:

See certificate for old location of A-21.

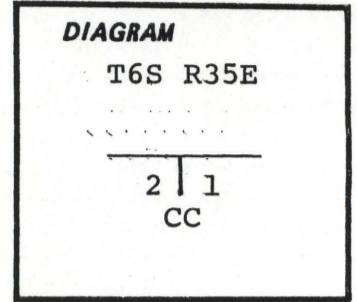

New Location

Description of corner evidence found:

Corner monument was in error. Old monument was found 5.95 ft. south of correct location. Added letters "AM" to cap to show it had been ammended.

Description of monument and accessories | established to perpetuate the original location of this corner:

At computed location of intersection of lines, set 2.5" aluminum cap on 2 3/8"x30" aluminum pipe.

Set steel fence post 3.0 ft. west of corner.

New BT's:

- A 17" Tamarack bears N61°E, 32.3 ft., blazed and scribed; T5S R35E S32 BT.
- A 15" Tamarack bears S42.5°E, 6.5 ft., blazed and scribed; CC T6S R35E S1 BT.
- A 19" Tamarack bears S61°W, 37.8 ft., blazed and scribed; CC T6S R35E S2 BT.

Brass LS 1844 disc in lower end of blaze. Painted blazes and attached signs as per Standard Specifications for Cadastral Surveys, USFS Region 6, March 1982.

Compass Declination: 19 3/4°E

Witness: Duane Scott

Corner is found 5.94 ft. north of original location. 1/4 mile west of East Sheep Creek and 1 3/4 mile north of Road 5160.

I hereby certify the above described corner monument and/or accessories was established as described September 19, 1984.

Cap is stamped:

T5S R35E  
 S32  
 S2 | S1  
 T6S R35E  
 CC  
 RLS 1844  
 1969

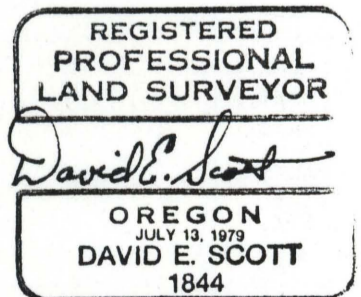

Office of..... County of.....

State of....., I hereby certify that the within instrument was filed in this office for record on the..... day of....., 19.....

..... by .....  
(COUNTY OFFICIAL) (DEPUTY)

**UNION COUNTY  
SURVEYOR**

Date Received 10-17-84

Date Filed 10-24-84  
☆ GPO-798-276

By G. LANGUITZ, Deputy

File No. 999-84 R