

97-69A

93

CERTIFIED RECORD OF LAND CORNER MONUMENTATION

History of original corner establishment:

Original survey by General Land Office Contract survey 1884.

The original notes state. Set a post from which;
A pine 12" in diam bears N65°E 43 lks dist marked $\frac{1}{4}$ SBT
A pine 18" in diam bears S45°W 32 lks dist marked $\frac{1}{4}$ SBT

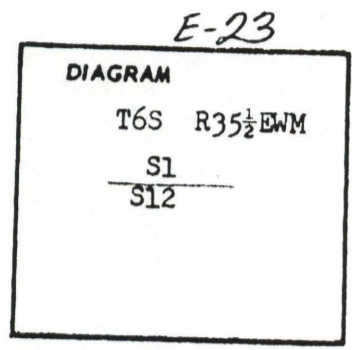

Description of corner evidence found:

A pine 17" in diam bears N65°E 43 lks dist with scribe.
A stump 24" in diam bears S45°W 32 lks dist.

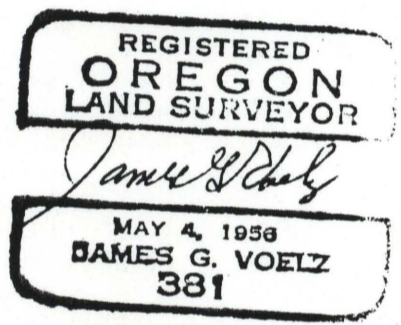

Description of monument and accessories I established to perpetuate the original location of this corner

At the position of the corner I set a 2" galvanized pipe 30" long with bronze cap on top and 8" plate welded to bottom. The pipe set to a depth of 25". The hole back filled with stone and tamped soil.

I stamped the disk

$\frac{1}{4}$ COR

T6S R35 $\frac{1}{2}$ E
S1
S12
ORE LIC 381
1969

From the monument the original bearing tree is;
A pine 17" in diam bears N65°E 43 lks dist.
I set a new bearing tree as follows;
A fir 13" in diam bears S60°W 20.7 ft. dist marked with scribe $\frac{1}{4}$ SBT. Distance measured to center of tree. USFS bearing tree signs were placed on the bearing trees shoulder high facing the corner.

Office of County surveyor County of UNION
 State of OREGON I hereby certify that the within instrument was filed in this office
 for record on the 20. day of Sept 1969, at 3 o'clock P. M. (signed)
 County surveyor by
 (COUNTY OFFICIAL)

UNION COUNTY SURVEYOR
Date Received _____
Date Filed _____
By _____
File No. 736-84R

CERTIFIED RECORD OF LAND CORNER MONUMENTATION

Index File No. E-23

History of original corner establishment:

Original corner established in 1884 by William B. Barr under Contract No. 492. Set Pine post 3"x3"x3', from which: A 12" Pine bears N65°E, 43 lks. and An 18" Pine bears S45°W, 32 lks.

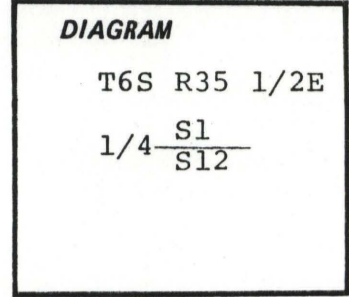

James G. Voelz set a 2" galvanized pipe 30" long with bronze cap on top and 8" plate welded to the bottom, under contract with the USDA Forest Service and recorded Certified Record of Land Corner Monumentation on Sept. 20, 1969.

From which: A Fir 13" in diam bears S60°W, 20.7 ft. dist. scribed 1/4SBT He found a pine 17" in diam bearing N65°E, 43 lks. dist.

Description of corner evidence found: Cap is stamped: 1/4 COR T6S R35 1/2E Found 3" brass cap on 2 3/8" iron pipe. Found steel fence post 1.5 ft. west of corner. Bearing trees found: 16" Ponderosa Pine, dead & down. Stump hole bears N65°E, 43 lks. (tree is 10 ft. east of stump hole.) 16" Douglas Fir bears S60°W, 20.7 ft. (BT by LS#381)

Description of monument and accessories established to perpetuate the original location of this corner:

No changes made to monument; no stones available for mound. New BT: A 7" Western Larch bears N13 1/2°W, 44.1 ft., blazed&scribed: 1/4S1BT.

Painted blazes and attached signs as per Standard Specifications for Cadastral Surveys, USFS Region 6, March 1982. A 3/4" brass disk stamped "RLS 1848" was nailed to the lower end of the blaze.

Corner is on northeasterly slope, 150 ft. northeast of summit of hill. Private road crosses saddle southeast of corner. Follow road by rock pit to summit of hill.

Compass declination: 19 1/2°E Witness: Jeremy Sutton

I hereby certify that the above described corner monument and/or accessories were established as hereon described on June 30, 1987.

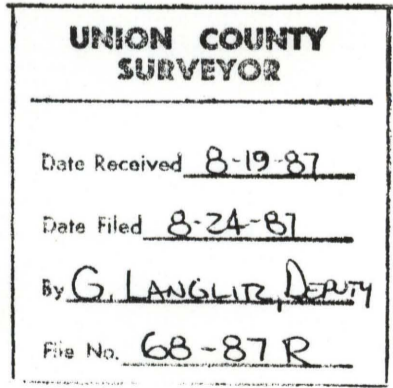

Office of..... County of..... State of....., I hereby certify that the within instrument was filed in this office for record on the..... day of....., 19..... by..... (COUNTY OFFICIAL) (DEPUTY)

E-23