

89-69A

82

CERTIFIED RECORD OF LAND CORNER MONUMENTATION

A-21

History of original corner establishment:

Original survey made by General Land office contract survey 1881

The original notes state. Set a post from which.
A tamarack 8" in diam bears S48°E 7 lks dist marked T6S R35E S1BT;
A tamarack 16" in diam bears S61°W 53 lks dist marked T6S R35E S2BT;

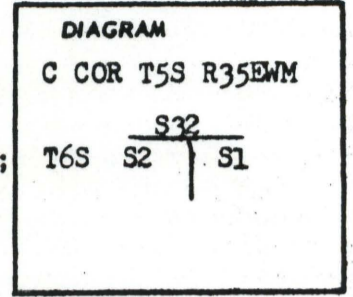

Description of corner evidence found:

A tamarack snag 9" in diam bears S48°E.
A tamarack 18" in diam bears S61°W 53 lks dist. Tree in good shape.
We found the original post marked for the corner.

REGISTERED
OREGON
LAND SURVEYOR

James G. Voelz

MAY 4, 1958
JAMES G. VOELZ
381

Description of monument and accessories I established to perpetuate the original location of this corner

At the position of the corner I set a 2" galvanized pipe 30" long with bronze cap on top and 8" plate welded to bottom. The pipe set to a depth of 24".

I stamped the disk.

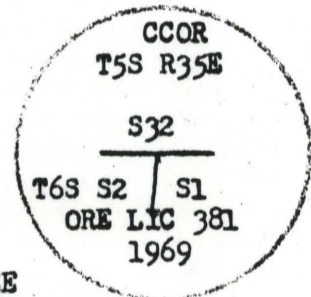

From the position of the corner the original bearing tree is;
A tamarack 18" in diam bears S61°W 53 lks dist.
I set the following new bearing trees;
A tamarack 13" in diam bears S32°E 29.6 ft. dist marked T6S R35E S1BT;
A tamarack 14" in diam bears N55°E 35 ft. dist marked T5S R35E S32BT;
Distance measured to center of the respective trees and marked with a scribe.
I set a steel fence post with USFS sign 54-4 attached. USFS National Forest boundary signs were attached to post indicating National Forest land to South and West. We nailed the original post to a tree adjacent to corner.

Office of.....Union County surveyor..... County of.....Union
State of.....Oregon....., I hereby certify that the within instrument was filed in this office
for record on the 17 day of Sept, 1959, at 8 o'clock A. m., (signed)
.....James G. Voelz.....
County surveyor by (DEPUTY)
(COUNTY OFFICIAL)

UNION COUNTY
SURVEYOR

Date Received _____
Date Filed _____
By _____
File No. 732-84R

CERTIFIED RECORD OF LAND CORNER MONUMENTATION

Index File No. A-21

History of original corner establishment:

Original corner established in 1883 by William B. Barr under contract #492

A post, 4½"x4"x4", was set 24" in ground. from which:

- A 72" pine bears N35°W, 176 lks.
- A 12" Pine bears S80°E, 90 lks.
- An 18" Pine bears S65°W, 40 lks.

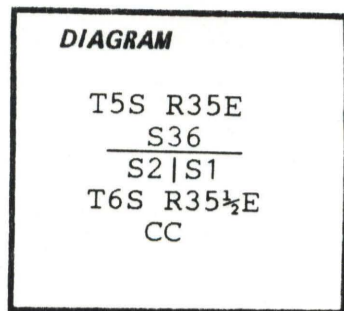

Description of corner evidence found:

A 72" ponderosa pine bears N35°E (orig. N35°W), 176 lks. dead & down

A careful examination of the dead & down 72" ponderosa pine indicates the tree did not twist as it fell and that the blaze did in fact face Southwest while it was still standing. Evidence that supports this is the shape of the root wad and the shape of the root hole match. Also the pieces of root still in the ground match pieces of the root wad still attached to the tree showing the position of the blaze on the Southwest side of the tree. Other supporting evidence is the distance more closely fits to the standard corner closed on in the original survey and the bearing to the section corner south is closer to parallel to the range line and the other two north-south section lines to the west.

Description of monument and accessories | established to perpetuate the original location of this corner:

No permanent monument was set at the original closing corner location. A traverse point was set at the original location, and the intersection point of the east line of sec. 2 and the first standard parallel south lies N00°44'22"W, 2.13 ft. The new closing corner at the intersection point is described on another certificate of monumentation. Accessories are referenced to the new corner only and are shown on that record of monumentation.

Painted blaze and attached signs as required in Specifications for Cadastral Surveys, USFS Region 6, March, 1982.

Compass Declination: 19½°E
Witness: J. Sutton
I hereby certify that the above described corner monument and/or accessories was perpetuated as hereon described on Aug 21, 1986.



UNION COUNTY SURVEYOR	
Date Received	9-17-86
Date Filed	9-19-86
By	<i>G. Langlie Deputy</i>
File No.	145-86 R

SEE SURVEY 27-86

Office of..... County of.....
 State of....., I hereby certify that the within instrument was filed in this office
 for record on the..... day of....., 19.....
 by
 (COUNTY OFFICIAL) (DEPUTY)

CERTIFIED RECORD OF LAND CORNER MONUMENTATION

Index File No. A-21

History of original corner establishment:

Original corner established in 1883 by William B. Barr under contract #492
A post, 4 1/2'x4"x4", was set 24" in ground.
from which:
A 72" pine bears N35°W, 176 lks.
A 12" Pine bears S80°E, 90 lks.
An 18" Pine bears S65°W, 40 lks.

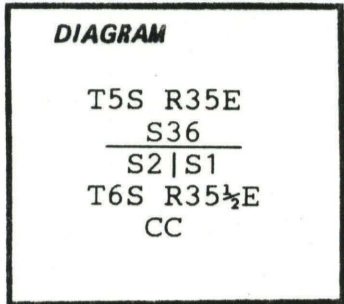

Description of corner evidence found:

A 72" ponderosa pine bears N35°E (orig. N35°W), 176 lks. dead & down.
An explanation of the problem encountered with the original evidence found is described on the certificate of monumentation for the original closing corner, and will not be repeated here.
No permanent monument was set at the original closing corner location.
A traverse point was set at the original location, and the intersection point of the east line of sec. 2 and the first standard parallel south lies N00°44'22"W, 2.13 ft.

Description of monument and accessories established to perpetuate the original location of this corner:

Set 2 1/2"x30" aluminum capped aluminum pipe rising 6". No stones available.
Set steel fencepost 3' north of corner.
Cap is stamped:

T5S R35E
S36
S2|S1
T6S R35 1/2 E
CC
RLS 1848
1986

New BT's:

A 15" P. Pine bears S18 1/2°E, 121.0 ft.
blazed&scribed CCT6SR35 1/2 ES1BT
A 6 1/2" L. Pine bears S53 1/2°W 106.7 ft.
blazed&scribed CCT6SR35 1/2 ES2BT
A 20" P. Pine bears N42 1/2°W, 67.2 ft.
blazed&scribed CCT5SR35ES36BT

Painted blaze and attached signs as required in Specifications for Cadastral Surveys, USFS Region 6, March, 1982.

Compass Declination: 19 1/2°E
Witness: J. Sutton

I hereby certify that the above described corner monument and/or accessories was perpetuated as hereon described on Aug 21, 1986.

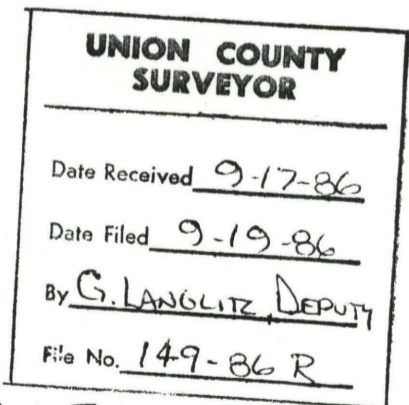

SEE SURVEY 27-86

Office of..... County of.....
State of....., I hereby certify that the within instrument was filed in this office for record on the..... day of....., 19.....
..... by
(COUNTY OFFICIAL) (DEPUTY)