

R-3 T55 R42E

CORNER RECORD (PERPETUATION)

MONUMENT: DESCRIBE NEW MONUMENT SET, OR WORK DONE TO PRESERVE EXISTING MONUMENT

2 1/2" IRON POST 28" LONG SET 24" IN GROUND
WITH 5' STEEL FENCE POST ALONG SIDE

T55 R42E
S19
1/4 S30
1971

ACCESSORIES: DESCRIBE NEW BT'S WITNESS OBJECTS ETC. ESTABLISHED, OR WORK DONE TO PRESERVE EXISTING EVIDENCE

Work Done By S. AIBRIGHT Title CADASTRAL SURVEYOR Date 9/30/71 State Registration No. AIM

Certified Cor. Record Prepared? Yes No Filed At: _____ Date _____

REMARKS

Index File No. T. R. M. Tract or Surv. No. Cor.

UNION COUNTY SURVEYOR	
Date Received	_____
Date Filed	<u>12-28-87</u>
By	<u>G. LANGRISH, DEPUTY</u>
File No.	<u>457-87R</u>

R-3

TSS 42 R 03

Remonumentation of Certain Original Corner Points,
T. 5 S., R. 42 E., Willamette Meridian, Oregon

CHAINS

A ponderosa pine, 41 ins. diam., bears S. 64½° E.,
186 lks. dist., with scribe marks T5S R42E S2
visible on open blaze. (Record, S. 70° E.)

A root hole, bears S. 31° W., 62 lks. dist., with
a down ponderosa pine alongside, size indeter-
minate, with illegible scribe marks visible on
burned blaze.

A ponderosa pine, 31 ins. diam., bears N. 66° W.,
203 lks. dist., with scribe marks 5S 42 1 B
visible on open double blaze. (Record, N. 70° W.)

At the corner point

Set an iron post, 28 ins. long, 2½ ins. diam., 20 ins.
in the ground, and in a mound of stone, 2 ft. base, to
top, with brass cap mtd.

T 5 S R 42 E
S 19 S 20
S 30 S 29
1971

from which new bearing trees

A fir, 8 ins. diam., bears N. 66½° E., 162 lks.
dist., mkd. T5S R42E S20 BT.

A fir, 16 ins. diam., bears S. 36½° E., 207 lks.
dist., mkd. T5S R42E S29 BT.

A ponderosa pine, 15 ins. diam., bears S. 6° W.,
73 lks. dist., mkd. T5S R42E S30 BT.

A ponderosa pine, 8 ins. diam., bears N. 34½° W.,
44½ lks. dist., mkd. T5S R42E S19 BT.

Set 5 ft. steel fence post alongside iron post.

The ¼ sec. cor. of secs. 19 and 30, determined at record
distance from the original bearing trees:

A fir, 22 ins. diam., bears N. 78° W., 38 lks.
dist., with healed blaze. (Record, N. 88° W.)

A western larch, 14 ins. diam., bears S. 13° E.,
31 lks. dist., with healed blaze. (Record,
S. 5° E.)

At the corner point

Set an iron post, 28 ins. long, 2½ ins. diam., 24 ins.
in the ground, with brass cap mkd.

T 5 S R 42 E
¼ S 19
S 30
1971

from which new bearing trees

A fir, 16 ins. diam., bears N. 30½° E., 29 lks.
dist., mkd. ¼ S19 BT.

A fir, 12 ins. diam., bears S. 4½° E., 52 lks.
dist., mkd. ¼ S30 BT.

**UNION COUNTY
SURVEYOR**

Date Received 3/15/13

Date Filed 3/15/13

By [Signature] DEPUTY

File No. 393-2013R

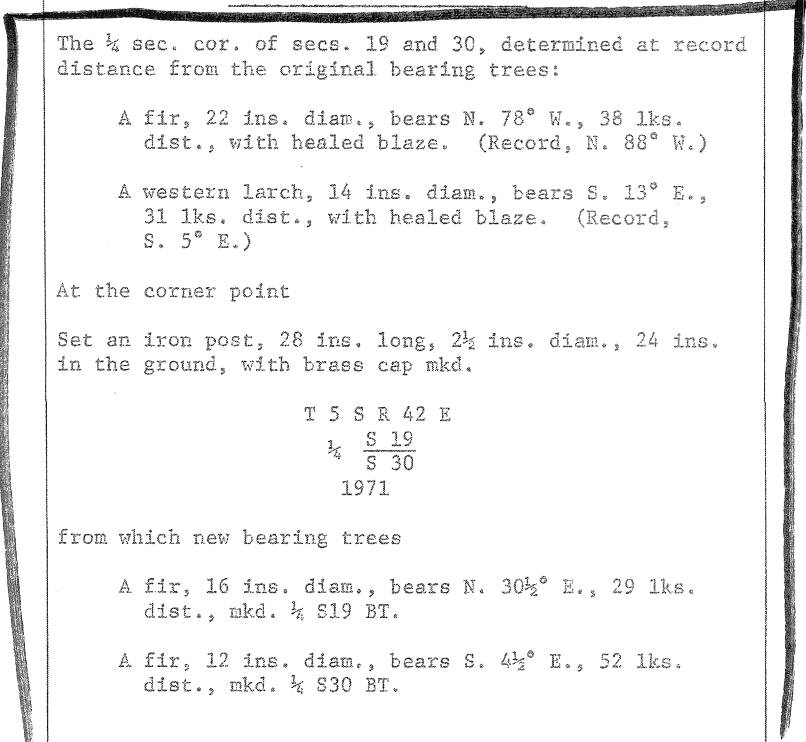

TSS 42 R 03

Remonumentation of Certain Original Corner Points,
T. 5 S., R. 42 E., Willamette Meridian, Oregon

CHAINS

Set 5 ft. steel fence post alongside iron post.

The cor. of secs. 17, 18, 19, and 20, determined at record distance from the remaining original bearing trees:

A western larch, 18 ins. diam., bears N. 35° E., 37 lks. dist., with scribe marks S R42E S7 visible on opened blaze. (Record, N. 40° E.)

A lodgepole pine, 13 ins. diam., bears S. 50½° W., 78 lks. dist., with fragmentary scribe marks visible on open blaze. (Record, S. 45° W.)

At the corner point

Set an iron post, 28 ins. long, 2½ ins. diam., 24 ins. in the ground, with brass cap mkd.

T 5 S R 42 E
S 18 S 17
S 19 S 20
1971

from which new bearing trees

A lodgepole pine, 9 ins. diam., bears N. 36° E., 53 lks. dist., mkd. T5S R42E S17 BT.

A white fir, 8 ins. diam., bears S. 34° E., 104 lks. dist., mkd. T5S R42E S20 BT.

A lodgepole pine, 11 ins. diam., bears S. 27½° W., 7½ lks. dist., mkd. T5S R42E S19 BT.

A lodgepole pine, 9 ins. diam., bears N. 64½° W., 61 lks. dist., mkd. T5S R42E S18 BT.

Set 5 ft. steel fence post alongside iron post.

The ¼ sec. cor. of secs. 18 and 19, monumented with the original basalt stone, 16 x 12 x 6 ins., firmly set, 14 ins. in the ground, marked ¼ on N. face, from which the only remaining original bearing tree:

A fir, 22 ins. diam., bears S. 20° E., 12 lks. dist., with scribe marks 4 S19 visible on opened blaze.

At the corner point

Set an iron post, 28 ins. long, 2½ ins. diam., 24 ins. in the ground, with brass cap mkd.

T 5 S R 42 E
¼ S 18
¼ S 19
1971

from which new bearing trees

A lodgepole pine, 9 ins. diam., bears N. 59¾° E., 55 lks. dist., mkd. ¼ S18 BT.

UNION COUNTY
SURVEYOR

Date Received

3/15/13

Date Filed

3/15/13

By

J. L. DEPUTY

File No.

393-20132