

CERTIFIED RECORD OF LAND CORNER MONUMENTATION

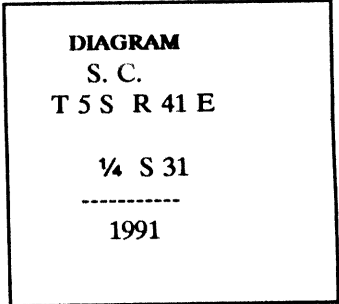

History of original corner establishment:

40.175 The standard ¼ sec. cor, of sec. 31, determined at the center of an ancient stone mound with the original slate stone, 15 x 12 x 3 ins. (record, 12 x 12 x 3 ins.), loose alongside, mkd. ¼ on the N. face. Set a stainless steel post 28 ins long, 2½ ins. diam., 22 ins. in the ground, and in a collar of stone, with brass cap, from which:

- A ponderosa pine, 10 ins. diam., bears N.77°E., 27 lks. dist. mkd. ¼ S31 SC BT.
- A ponderosa pine, 15 ins. diam., bears N.50°W., 103 lks. dist. mkd. x at breast height and BT at the base.

Deposit a white "DEEP-1" magnetic marker at the base and the corner stone alongside the stainless steel post.

Description of corner evidence found:

Found a 2½" B.L.M. brass cap, 6" above ground, with a 1.5' mound of stone to cap, from which:

- A pine, 10" diam., bears N.77°08'E., 17.38', with a 17" blaze, scribed "¼ S31 SC BT".
- A pine, 13" diam., bears N.50°31'W., 67.83', with a 9" blaze, scribed "x" at breast height.

Description of monument and accessories I established to perpetuate the original location of this corner:

- A pine, 13" diam., bears N.19°25'E., 45.71', with a 15" blaze, scribed "¼ S31 SC BT".
- A pine, 12" diam., bears S.16°58'W., 43.98', with a 21" blaze, scribed "¼ S31 SC BT".

UNION COUNTY
SURVEYOR

Date Received 10/18/84
Date Filed 10/23/84
By Gregory T. Black
File No 138-1994.R

REGISTERED
PROFESSIONAL
LAND SURVEYOR

RM & Stoll 10/94
OREGON
JULY 15 1983
RONALD E. STOLL
2058

Office of _____ County of _____
State of _____ I hereby certify that the within instrument was filed in this office
for record on the ____ day of _____, 19__
_____ by _____
(COUNTY OFFICIAL) (DEPUTY)

Index File No. 2-3 CORNER RECORD (SEARCH) Tract or Survey No. _____ Cor. No. 4
 T 5 S R. 41 E R.D. UNION County UNION
 Merid. Will N.F. W-W State OR.

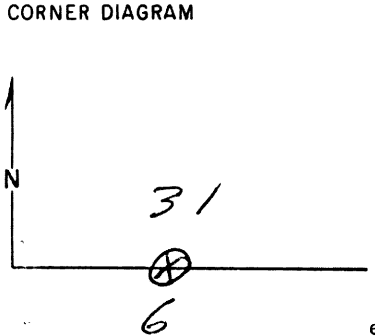

DESCRIBE CORNER MONUMENT FOUND
STONE 26x20x8 LAYING ON TOP OF
GROUND MARKED 1/4 S

DESCRIBE BEARING TREES OR OTHER OFFICIAL ACCESSORIES FOUND
VALSETS LUMBER CO. TAG ON 6" P.P.
COULD NOT FIND BEARING TREE'S

PHOTO IDENTIFICATION DATA
 Photo No. ENW-5-132
 Filed At. _____
 Object Ident. _____
 Ident. By _____
Signature

DESCRIBE CORNER LOCATION RELATIVE TO NEAR-BY FEATURES, ALSO HOW TO REACH CORNER

PLANE COORDINATE POSITION DATA
 State _____ Zone _____
 X _____
 Y _____
 Estab. By _____
Agency

Signature E.A.H. Title _____ Division _____ Headquarters _____ Date 6/3/70 7100-52 REV. 65 5

NOTE: FOR S 31 ONLY!

UNION COUNTY SURVEYOR

Date Received _____

Date Filed 12-28-87

By G. LANGLITZ, DEPUTY

File No. 440-87R

2-3

Dependent Resurvey of the South Boundary
 (First Standard Parallel South),
 T. 5 S., R. 41 E., Willamette Meridian, Oregon

| CHAINS | |
|--------|--|
| | <p>At the corner point</p> <p>Set a stainless steel post, 28 ins. long, 2½ ins. diam., 22 ins. in the ground, with brass cap mkd.</p> <p style="text-align: center;"> T 5 S R 41 E S 31 S 6 S 5 T 6 S R 41 E CC 1991 </p> <p>from which new bearing trees</p> <p>A lodgepole pine, 12 ins. diam., bears S. 29½° E., 222 lks. dist., mkd. T6S R41E S5 CC BT.</p> <p>A lodgepole pine, 12 ins. diam., bears S. 27¼° W., 147 lks. dist., mkd. T6S R41E S6 CC BT.</p> <p>Deposit a white "DEEP-1" magnetic marker at the base and set a 6 ft. steel fence post alongside the stainless steel post.</p> |
| 14.00 | Ascend NE. slope. |
| 26.00 | Spur, slopes NW.; desc. W. slope. |
| 40.175 | <p>The standard ¼ sec. cor. of sec. 31, determined at the center of an ancient stone mound with the original slate stone, 15 x 12 x 3 ins. (record, 12 x 12 x 3 ins.), loose alongside, mkd. ¼ on the N. face.</p> <p>At the corner point</p> <p>Set a stainless steel post, 28 ins. long, 2½ ins. diam., 22 ins. in the ground, and in a collar of stone, with brass cap mkd.</p> <p style="text-align: center;"> SC T 5 S R 41 E ¼ S 31 1991 </p> <p>from which new bearing trees</p> <p>A ponderosa pine, 10 ins. diam., bears N. 77° E., 27 lks. dist., mkd. ¼ S31 SC BT.</p> <p>A ponderosa pine, 15 ins. diam., bears N. 50° W., 103 lks. dist., mkd. X at breast height and BT at the base.</p> <p>Deposit a white "DEEP-1" magnetic marker at the base and the corner stone alongside the stainless steel post.</p> |
| | <p>S. 89° 28' 00" W., beginning new measurement.</p> <p>Descend SW. slope.</p> <p>Track road, 15 lks. wide, bears N. and S., and ravine, drains S.; asc. SE. slope.</p> |

UNION COUNTY
 SURVEYOR

Date Received 3/5/13

Date Filed 3/15/13

By MLG

File No. 166-2013R