

UNION COUNTY SURVEYOR

CERTIFIED RECORD OF LAND CORNER MONUMENTATION

HISTORY OF ORIGINAL CORNER ESTABLISHMENT:

Corner originally established by H.M. Thatcher under GLO contract Number 320, dated April 1, 1879. Surveyor General record states:
Set stone 15x18x9 inches for 1/4 cor.
Raised Stone Mound at Cor.

T 5S R 41 E P-09

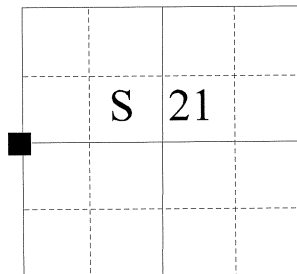

DESCRIPTION OF CORNER EVIDENCE FOUND:

A stone, 7x10x18", mkd '1/4', lying loose next to mound of stone.

DESCRIPTION OF MONUMENT AND ACCESSORIES I ESTABLISHED

TO PERPETUATE THE ORIGINAL LOCATION OF THIS CORNER:

At the mound of stone, I set a 2 1/2" x 30" Aluminum pipe with cap marked as shown, 18" in the ground, with mound of stone 3 ft. wide, from which:

NEW BEARING TREES:

An 8" Douglas Fir bears North 27° East, a distance of 38.36 feet, marked 1/4 S21 BT.
An 8" Ponderosa Pine bears South 61° East, a distance of 45.51 feet, marked 1/4 S21 BT.
A 6" Ponderosa Pine bears South 7° West, a distance of 16.78 feet, marked X BT.
A 17" Douglas Fir bears North 28° West, a distance of 74.57 feet, marked 1/4 S21 BT.

I buried the stone alongside the pipe on the North side.

Corner falls 15' Northeast of a logging road on a steep Northeast facing slope.

I hereby certify that the corner was monumented on November 9, 2009.

Witness: Jeff Hsu

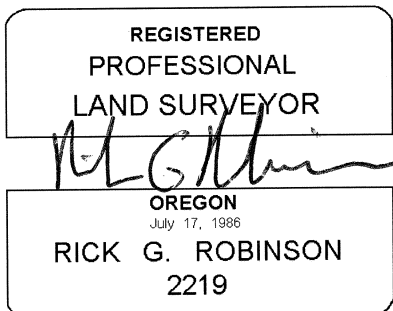

Renewal Date: December 31, 2010

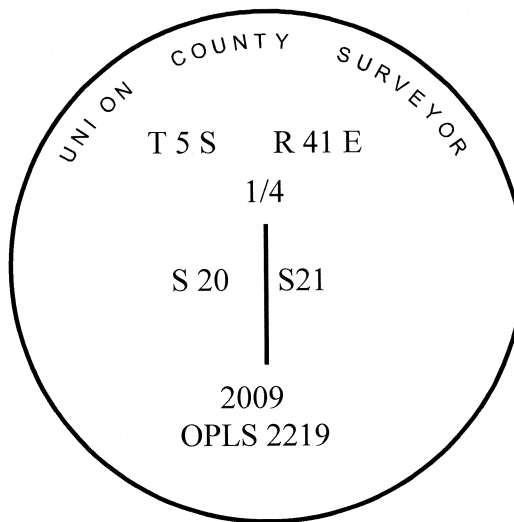

UNION COUNTY SURVEYOR
Date Received 1/4/2010
Date Filed 2/9/2010
Filed By [Signature]
File Number 004-2010R

I used a steel tape and magnetic compass in the establishment of the new accessories. I used 18° East declination, the distances are to a 60d spike driven into the root crown at the right side of the bearing trees. Attached brass washer marked OPLS 2219 to BT blaze.