

**CERTIFIED RECORD OF LAND CORNER MONUMENTATION**

**HISTORY OF ORIGINAL CORNER ESTABLISHMENT:**  
Corner not previously established.

T 5S R 41 E O-15

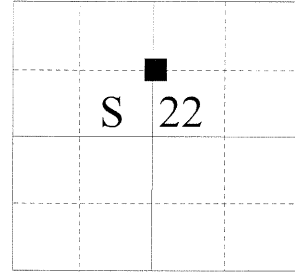

**DESCRIPTION OF CORNER EVIDENCE FOUND:**  
None

See Survey Number 035-2012

**DESCRIPTION OF MONUMENT AND ACCESSORIES I ESTABLISHED**

**TO PERPETUATE THE ORIGINAL LOCATION OF THIS CORNER:**

At position determined by survey, I set a 5/8" x 30" iron rod with 2 1/2" Aluminum Cap marked as shown, 28 ins. in the ground, from which:

**BEARING TREES:**

A 13 in. Ponderosa Pine bears North 9° East, a distance of 8.35 feet, marked CN 1/16 S22 BT.

a 13 in. Ponderosa Pine bears South 67° West, a distance of 7.10 feet, marked CN 1/16 S22 BT.

I hereby certify that the corner was set on October 25, 2012.

I set a steel fencepost 1 foot West of the corner monument.

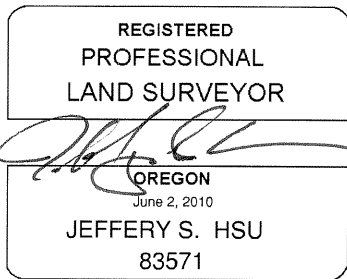

Renewal Date: June 30, 2013

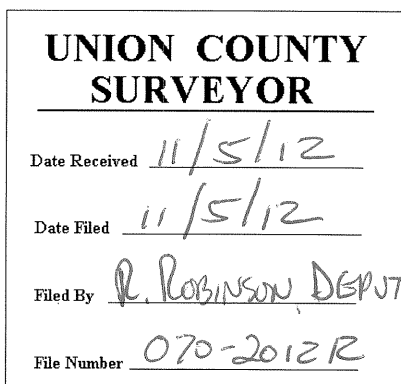
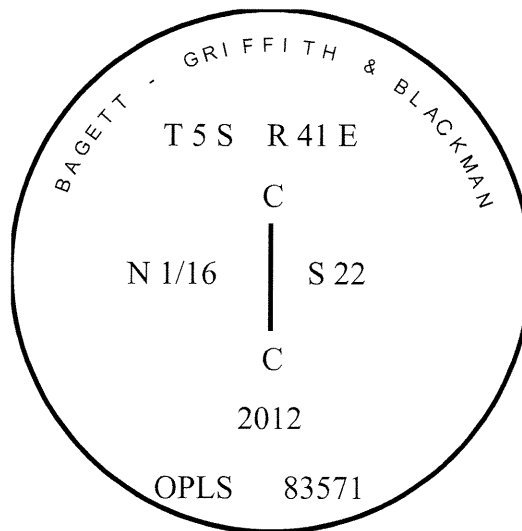

I used a steel tape and magnetic compass in the establishment of the new accessories. I used 16° East declination, the distances are to a 60d spike driven into the root crown at the right side of the bearing trees. Attached brass washer marked OPLS 83571 to BT blaze.