

CERTIFIED RECORD OF LAND CORNER MONUMENTATION

INDEX NO. L-16

History of original corner establishment:

None. Corner established this survey.

DIAGRAM
 T5S R41E
 E1/16
 C ----- C
 S15
 1994

Description of Corner Evidence Found:

None. Corner established this survey.

Description of monument and accessories I established to perpetuate the original location of this corner:

Set 2" O.D. x 30" ~~galvanized iron~~ ^{ALUMINUM} pipe 26" in ground with 2" aluminum cap, with magnet and flared ends, stamped as shown on the DIAGRAM, in a mound of stone with 3 ft. base.

*8-27-94
 PLS
 MF # 96372*

From Which:

A White Fir, 10" dia., bears N52°33'W, 12.5 ft., scribed: CE 1/16 S15 BT

A White Fir, 7" dia., bears S42°23'W, 23.0 ft., scribed: CE 1/16 S15 BT

Measurements to BT's taken with total station and chain with bearings based on the survey control network; bearings taken to an 8" spike set at top of blaze, extending out 2" +/- . Nailed Bearing Tree (54-3) signs above blaze and Land Survey Monument (54-9) signs on back of each tree as required. Painted a 6" red band above Bearing Trees signs. Set 1/2" brass disc at base of blaze stamped: "L. MILLER PLS 2513". Spike and nail in brass disc on vertical line. Set steel fence post with Land Survey Monument (54-9) and Property Boundary (54-2) signs alongside monument. Set steel fence post with 54-2 sign East 50' from the monument.

This monumentation was performed by:
 Linda Lee Miller, PLS 2513
 Witnessed by:
 Russell Avery, PE, PLS
 August 23, 1994

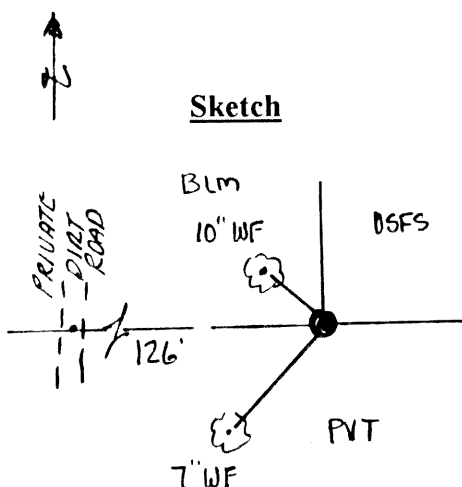

Monument Detail

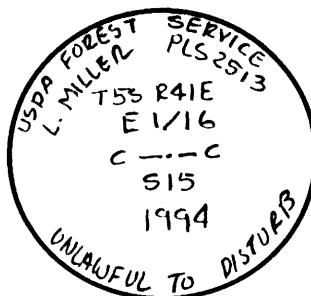

Location/Comments

Mean Magnetic Declination 20° East

SURVEYOR

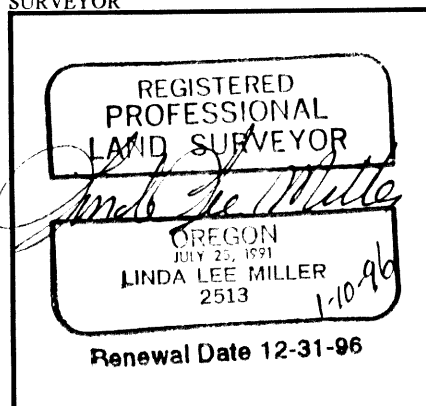

UNION COUNTY

