

CERTIFIED RECORD OF LAND CORNER MONUMENTATION

INDEX NO. L-15

History of original corner establishment:

None. Corner established this survey.

DIAGRAM
T5S R41E

C 1/4 - 1 - S15

1994

Description of Corner Evidence Found:

None. Corner established this survey.

Description of monument and accessories I established to perpetuate the original location of this corner:

Set 2" O.D. x 30" ~~galvanized iron~~ ^{ALUMINUM} pipe 26" in ground with 2" aluminum cap, with magnet and flared ends, stamped as shown on the DIAGRAM, in a mound of stone with 3 ft. base.

*8-27-96
RLM
MF 963772*

From Which:

- Ponderosa Pine, 6" dia., bears S88°31'20"E, 23.5 ft., scribed: X BT
- Douglas Fir, 7" dia., bears S03°23'05"W, 19.6 ft., scribed: C 1/4 S15 BT
- White Fir, 6" dia., bears S44°18'50"W, 25.0 ft., scribed: X BT
- Douglas Fir, 12" dia., bears N05°39'55"W, 5.0 ft., scribed: C 1/4 S15 BT

Measurements to BT's taken with total station and chain with bearings based on the survey control network; bearings taken to an 8" spike set at top of blaze, extending out 2" +/- . Nailed Bearing Tree (54-3) signs above blaze and Land Survey Monument (54-9) signs on back of each tree as required. Painted a 6" red band above Bearing Trees signs. Set 1/2" brass disc at base of blaze stamped: "L. MILLER PLS 2513". Spike and nail in brass disc on vertical line. Set steel fence post with Land Survey Monument (54-9) sign alongside monument.

This monumentation was performed by:
Linda Lee Miller, PLS 2513
Witnessed by:
Russell Avery, PE, PLS
August 22, 1994

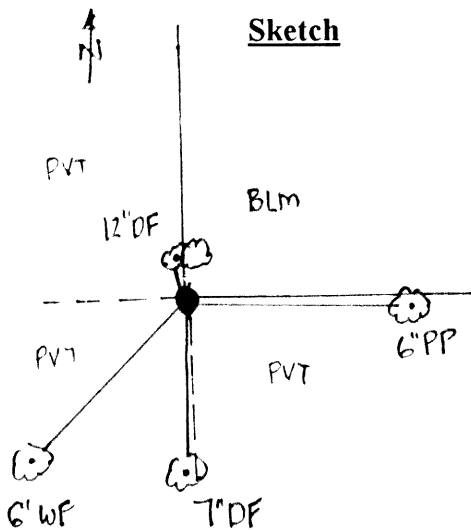

Monument Detail

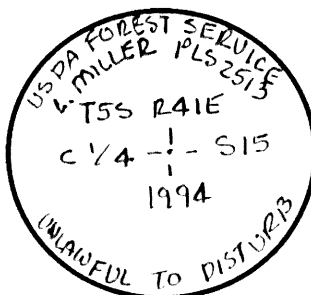

Location/Comments

Mean Magnetic Declination 20° East

SURVEYOR

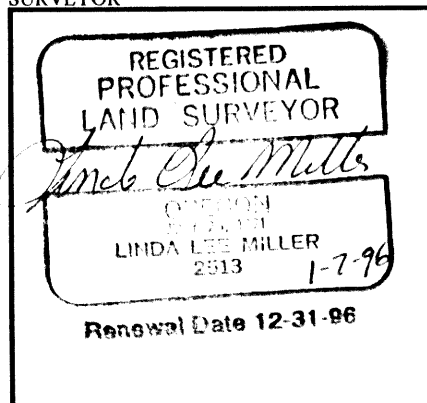

UNION COUNTY

