

CERTIFIED RECORD OF LAND CORNER MONUMENTATION

History of original corner establishment:
Corner originally established by Henry M. Thatcher under GLO contract number 320 dated April 1, 1879. Surveyor General record states:

Set stone 15x13x11 for 1/4 sec cor
Raised stone mound at cor

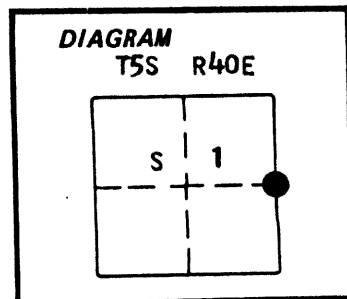

No record of subsequent remonumentation found in county records
Description of corner evidence found:

Found a stone 15x13x9 inches with faint 1/4 visible in mound of stone

Found a 1 1/2 inch pipe filled with concrete marked as shown with brass screw in center (pipe found in mound)

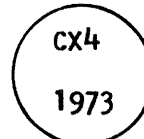

Description of monument and accessories I established to perpetuate the original location of this corner: In place of pipe, I set a 2 1/2"x30" aluminum pipe with aluminum cap marked as shown, 24 inches in the ground with mound of stone 5 ft. base to top of cap from which:

New B0s;

A 5/8"x30" iron pin with plastic cap marked BGA SURVEY MARKER bears S15°E 13.80 feet
A 5/8"x30" iron pin with plastic cap marked BGA SURVEY MARKER bears S44°W 17.58 feet

Set a steel fencepost approximately 5 feet South with 54-4 sign

Corner set May 17, 1986

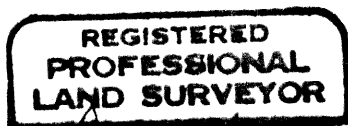
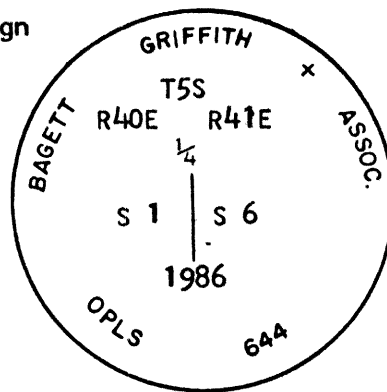

Handwritten signature of Duane I. Griffith

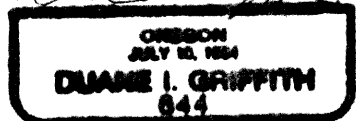

Brass washer marked OPLS 644 nailed to BT blaze. Used steel tape and magnetic compass with 20° East declination. Distances to the BTs are to a 50d spike set in right side of tree when facing tree, unless otherwise stated.

Office of..... County of.....
State of....., I hereby certify that the within instrument was filed in this office for record on the..... day of....., 19.....
..... by
(COUNTY OFFICIAL) (DEPUTY)

UNION COUNTY SURVEYOR
Date Received 6-5-86
Date Filed 6-18-86
By G. LANGRIZ DEPUTY
OFFICE - 1983-793-276
File No. 80-86 R