

OREGON CORNER RESTORATION RECORD

SECTION 36 TOWNSHIP 05S RANGE 40E W.M.

UNION
~~RESERVES~~ COUNTY

DATE 12-27-95

| <u>CORNER DESIGNATION</u> | <u>TYPE OF REPORT</u> | <u>COUNTY SURVEYOR'S RECEIPT STAMP</u> |
|---------------------------|-----------------------|--|
| SC | _____ CONDITION ONLY | INDEX FILE NO. _____ |
| T05S R40E | _____ NOT FOUND | |
| 1/4 S36 | <u>X</u> RENEWED | ALPHA/NUMERIC |
| 1995 | _____ UNRECORDED | CORNER NUMBER <u>Z23</u> |
| | _____ SURVEYED IN | |
| | _____ REFERENCED OUT | |

Page 1 of 2

HISTORY OF ORIGINAL CORNER AND / OR PREVIOUS RENEWALS:

Original survey by N.O. Walden, under GLO Contract No. 198, dated July 15, 1873, 1st Standard Parallel South: 40.00 chains, Set Slate stone 24"x12"x5", 8" in ground, for 1/4 sec. corner from which: A Pine 12" Dia., bears N90W 364 Lks. (240.64 ft) August 13, 1873.

DESCRIPTION OF CORNER EVIDENCE FOUND:

Found the original Slate stone 24"x12"x5" laying on its north face, approximately 3 ft., from the remains of the original stone mound, with chiseled markings as follows: "1/4" on its face. I reset per GLO notes.

From which: a 26" Dia., x 3'8" high Ponderosa Pine stump bears N88°53'35"W, 237.53 feet (West 240.64 ft.) old deep blaze on East face with scribing visible "1/4S". The "S" is backwards.

MONUMENT DETAIL

SKETCH

LOCATION / COMMENTS:

NONE BASED ON SURVEY
MAG. DECL. _____

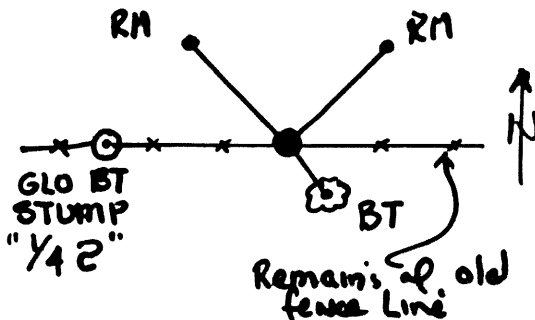
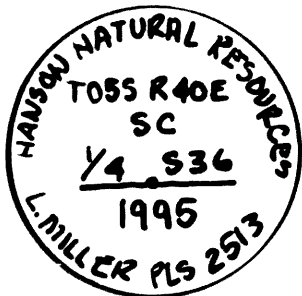

UNION COUNTY
CORNER NO. _____
Date Received 2-2-96
Date Filed 2-5-96
by R. ROBINSON, DEPUTY
PLS 005-1996R

DESCRIPTION OF MONUMENT AND ACCESSORIES ESTABLISHED:

At the original corner point determined to be in the center of the original stone, I set a 3" O.D.x30" galvanized iron pipe, 22" in the ground, with a 3" brass alloy cap, stamped as shown on the DETAIL, in a mound of stone. Placed original stone alongside of pipe. From which:

A 5/8"x30" rebar bears N36°27'25"W 40.92 ft., with 1 1/2" aluminum cap stamped "L.MILLER PLS 2513 RM" with stone alongside.

A 5/8"x30" rebar bears N46°54'30"E 39.14 ft., with 1 1/2" aluminum cap stamped "L.MILLER PLS 2513 RM".

A Ponderosa Pine, 4" dia., bears S25°46'30"E 19.20 ft., scribed: "X" on top blaze. Lower blaze set a 1/2" brass alloy disc stamped: "L.MILLER PLS 2513". Set a 2" brass alloy disc with P-K nail on top, to which my

FIRM/AGENCY NAME: Miller Land Surveying Co.
ADDRESS: P.O. Box 3
Bend, OR 97709-0003

SURVEYOR'S SEAL

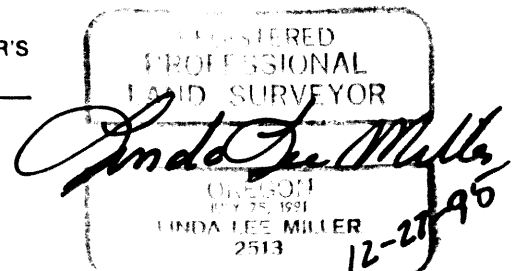

Renewal Date 12-31-96

OREGON CORNER RESTORATION RECORD

COUNTY SURVEYOR'S RECEIPT STAMP

SECTION 36 TOWNSHIP 05S RANGE 40E W.M.

INDEX FILE NO. _____

HISTORY OF ORIGINAL CORNER AND/OR PREVIOUS RENEWALS:

ALPHA/NUMERIC CORNER NUMBER Z23

Page 2 of 2

DESCRIPTION OF MONUMENT AND ACCESSORIES ESTABLISHED (Cont'd)

measurements were to, stamped: "L.MILLER PLS 2513".

Measurements taken to BT and RM's with a total station and chain with bearings based on the survey control network. Set fence post alongside monument. Corner is located on a flat area with heavy sagebrush and scattered trees.

This monumentation was performed by:

Linda Lee Miller, PLS 2513
October 11, 1995

| |
|-----------------------------|
| UNION COUNTY SURVEYOR |
| Date Received <u>2-2-96</u> |
| Date Paid <u>2-5-96</u> |
| <u>R. ROBINSON, DEPUTY</u> |
| File No. <u>005-1996R</u> |

FIRM / AGENCY NAME:

ADDRESS:

Miller Land Surveying Co.
P.O. Box 3
Bend, OR 97709-0003

SURVEYOR'S
SEAL _____

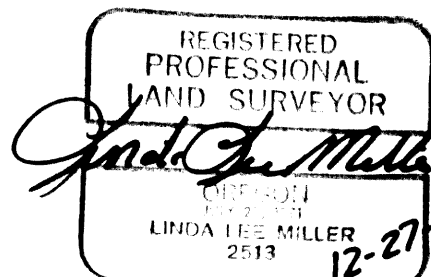

Renewal Date 12-31-96