

CERTIFIED RECORD OF LAND CORNER MONUMENTATION

History of original corner establishment:

Corner not established in original survey

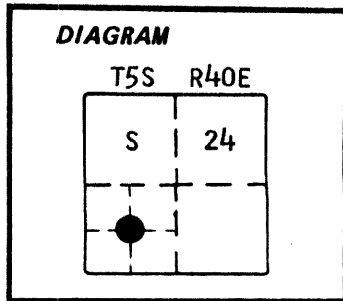

No evidence found of subsequent remonumentation in the county records

Description of corner evidence found:

NONE

**UNION COUNTY SURVEYOR**

---

Date Received 6-5-86

Date Filed 6-18-86

By G. LANGLITZ, DEPUTY

File No. 63-86 R

See map of survey dated June, 1986

Description of monument and accessories I established to perpetuate the original location of this corner: At position determined by survey, I set a 2 1/2" x 30" aluminum pipe with aluminum cap marked as shown, 27 inches in the ground with mound of stone 3 ft. base to top of cap from which:

New BTs

- A 13 inch diameter P. Pine bears N54°E 54.91 feet marked SW 1/16 S24 BT
- A 13 inch diameter Red Fir bears S87°E 19.74 feet marked SW 1/16 S24 BT

Set steel fenceposts approximately 5 feet East with 54-2 sign and approximately 5 feet North with 54-2 and 54-9 signs attached

Corner set May 27, 1986  
Witness; Rick Robinson

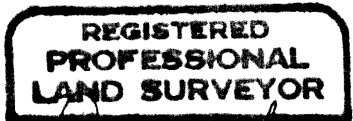
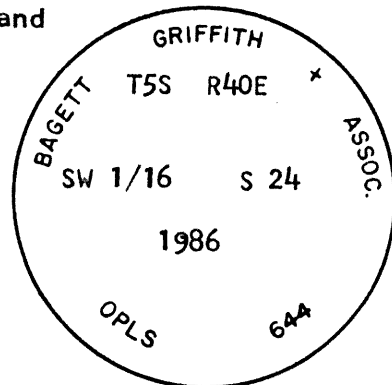

*Duane I. Griffith*

OREGON  
JULY 10, 1894  
**DUANE I. GRIFFITH**  
644

Brass washer marked OPLS 644 nailed to BT blaze. Used steel tape and magnetic compass with 20° East declination. Distances to the BTs are to a 50d spike set in right side of tree when facing tree, unless otherwise stated.

Office of..... County of.....  
State of....., I hereby certify that the within instrument was filed in this office  
for record on the..... day of....., 19.....

..... by .....  
(COUNTY OFFICIAL) (DEPUTY)