

CERTIFIED RECORD OF LAND CORNER MONUMENTATION

HISTORY OF ORIGINAL CORNER ESTABLISHMENT:

Corner originally established by William B. Barr under GLO contract Number 443, dated May, 29 1882. Surveyor General Record states:

Set lava rock 15x9x6, 10" in ground, marked 2 notches on East and 5 notches on South for corner of sections 2,3,10 & 11, from which;

- A Pine 14" in Dia. bears N48°E, 114 lks.
 - A Pine 12" in Dia. bears N72°W, 110 lks.
 - A Pine 16" in Dia. bears S56½°W, 260 lks.
- Raised a mound of stone.

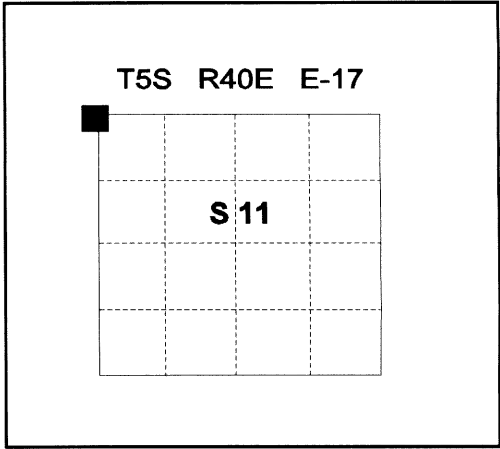

No record of subsequent monumentation found in Union County survey records

DESCRIPTION OF CORNER EVIDENCE FOUND:

Found SW bearing tree, now a 32" Ponderosa Pine, upper blaze evident, lower BT scribe visible, alive and vigorous.
Found NE bearing tree, now a 22" rotted stump, bearing and distance of record.

DESCRIPTION OF MONUMENT AND ACCESSORIES I ESTABLISHED TO PERPETUATE THE ORIGINAL LOCATION OF THIS CORNER:

At the recorded bearing and distance from the found BT's I set a 2½"x30" aluminum pipe with aluminum cap marked as shown, 28 inches in the ground. From which;

NEW BEARING TREES:

- An 11" Ponderosa Pine bears N66°E, 34.46 feet, marked T5S R40E S2 BT.
- An 18" Ponderosa Pine bears S1°E, 18.35 feet, marked T5S R40E S11 BT.
- A 22" Ponderosa Pine bears N69°W, 28.89 feet, marked T5S R40E S3 BT.

I hereby certify that the corner was monumented on October 24, 1995.
Witness: Mark Durbin, Jeff Madsen



Renewal Date: December, 31 1995

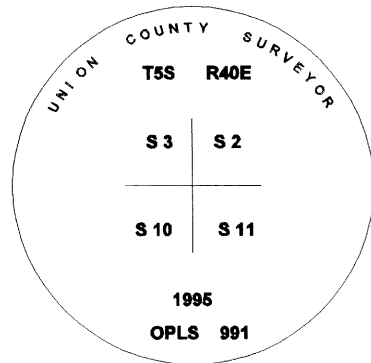

I used a steel tape and magnetic compass in the establishment of the new accessories. I used 20° East declination, the distances are to a 60d spike driven into the root crown of the bearing tree.

UNION COUNTY SURVEYOR

Date Received 11/7/95

Date Filed 11/13/95

Filed By Gregory T. Blackman

File Number 043-1995-R