

**CERTIFIED RECORD OF LAND CORNER MONUMENTATION**

**History of original corner establishment:**

This section corner was set by deputy surveyor Timothy W. Davenport, under Contract No. 102, dated July 20, 1863. He states he set a post for the section corner from which:  
 A pine 24" dia. bears S 68 E, 69 lks. dist.  
 A pine 28" dia. bears N 10 E, 47 lks. dist.  
 A pine 30" dia. bears N 35 W, 60 lks. dist.  
 A pine 12" dia. bears S 30 W, 72 lks. dist.

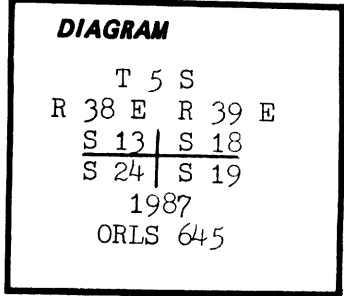

Deputy surveyor W.B. Barr retraced this line under Contract No. 388, dated May 7, 1881. He states he found the bearing trees agreeing to description, but the corner had been destroyed. He then re-established the corner by planting a basalt rock 16" x 14" x 8".

**Description of corner evidence found:**

At the assumed section corner location I found no trace of the original corner or the bearing trees due to heavy logging activity in recent years destroying all evidence.

**Description of monument and accessories I established to perpetuate the original location of this corner:**

With no evidence of the original section corner available, I then used single proportioning to establish this corner. I then set an Alum. cap on a 2" x 30" pipe, with a magnet fixed in the cap, at the corner location. I buried the pipe to within 2" above the surface of the ground. I then placed a small mound of stone 3 feet dia. and 6" high about the pipe and covering the monument. From which I set four new bearing trees:  
 A pine 11" dia. bears N 18 00 W, 131.84 feet and scribed T 5 S R 38 E S 13 BT.  
 A pine 11" dia. bears N 53 15 E, 86.40 feet and scribed T 5 S R 39 E S 18 BT.  
 A pine 9" dia. bears S 28 45 E, 61.90 feet and scribed T 5 S R 39 E S 19 BT.  
 A pine 13" dia. bears S 69 45 W, 114.40 feet and scribed T 5 S R 38 E S 24 BT.

<b>UNION COUNTY SURVEYOR</b>	
Date Received	<u>9-22-87</u>
Date Filed	<u>9-25-87</u>
By	<u>G. LANGLIT, DEPUTY</u>
File No.	<u>126-87 R</u>

REGISTERED PROFESSIONAL LAND SURVEYOR
<i>James H. Hambleton</i>
<u>9-25-87</u>
OREGON JULY 10, 1884 JAMES H. HAMBLETON 645

REFER TO SURVEY 28-87

Office of..... County of.....  
 State of....., I hereby certify that the within instrument was filed in this office  
 for record on the..... day of....., 19.....  
 ..... by .....

(COUNTY OFFICIAL)

(DEPUTY)

**CERTIFIED RECORD OF LAND CORNER MONUMENTATION**

**HISTORY OF ORIGINAL CORNER ESTABLISHED:**

Corner originally established by Timothy W. Davenport under GLO contract no. 102, dated July 20, 1863. Surveyor General field notes state:

T 5 S R 38 E N-25

Set post corner to Secs 18, 19, 13 and 24, on the East side of a ridge of mountain, from which:

- A Pine 24 in. dia. bears S68°E, 69 lks. dist.
- A Pine 28 in. dia. bears N10°E, 47 lks. dist.
- A Pine 30 ins. dia. bears N55°W, 60 lks. dist.
- A Pine 12 in. dia. bears S30°W, 72 lks. dist.

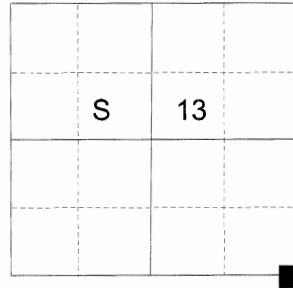

In Survey Number 28-87, James Hambleton finds no evidence of the original corner and places it at proportionate position. Union County Monumentation record 126-87R states:

I then set an Alum. cap on a 2"x30" pipe, with a magnet fixed in the cap, at the corner location. I buried the pipe to within 2" above the surface of the ground. I then placed a small mound of stone 3 feet dia. and 6" high about the pipe and covering the monument. From which I set new bearing trees:

- A pine 11" dia. bears N18°00'W, 131.84 feet, and scribed T5S R38E S13 BT.
- A pine 11" dia. bears N53°15'E, 86.40 feet and scribed T5S R39E S18 BT.
- A pine 9" dia. bears S28°45'E, 61.90 feet and scribed T5S R39E S19 BT.
- A pine 13" dia. bears S69°45'W, 114.40 feet and scribed T5S R38E S24 BT.

**DESCRIPTION OF CORNER EVIDENCE FOUND:**

I find the 2 ½" aluminum cap in a collar of stone set by Hambleton as described. By survey I determine that this corner falls South 89°43'35" East, a distance of 91.42 feet from a true proportionate position. From a true proportionate position:

- A 20" Ponderosa Pine bears North 71° East, a distance of 167.90 feet, alive and vigorous with healed blaze.
- A 14" Ponderosa Pine bears South 67° East, a distance of 134.40 feet, alive and vigorous with healed blaze.
- A 21" Ponderosa Pine bears South 19° West, a distance of 45.80 feet, alive and vigorous with healed blaze.
- A 24" Ponderosa Pine bears North 20° East, a distance of 131.90 feet, alive and vigorous with healed blaze.

SEE SURVEY NUMBER 010-2017

**DESCRIPTION OF MONUMENT AND ACCESSORIES I ESTABLISHED**

**TO PERPETUATE THE ORIGINAL LOCATION OF THIS CORNER:**

At proportionate position, I set a 2 ½" x 30" aluminum pipe with 2 ½" aluminum cap, marked as shown below, 28 inches in the ground, in a collar of stone 1 ft. diam.

I stamp and 'AM' on the Hambleton cap. I set a steel fencepost approx 1 foot North of the corner monument. I hereby certify that the corner was monumented April 6, 2017.

**UNION COUNTY SURVEYOR**

Date Received 4/11/17

Date Filed 4/11/17

Filed By J.S. Hsu

File Number 006-2017R

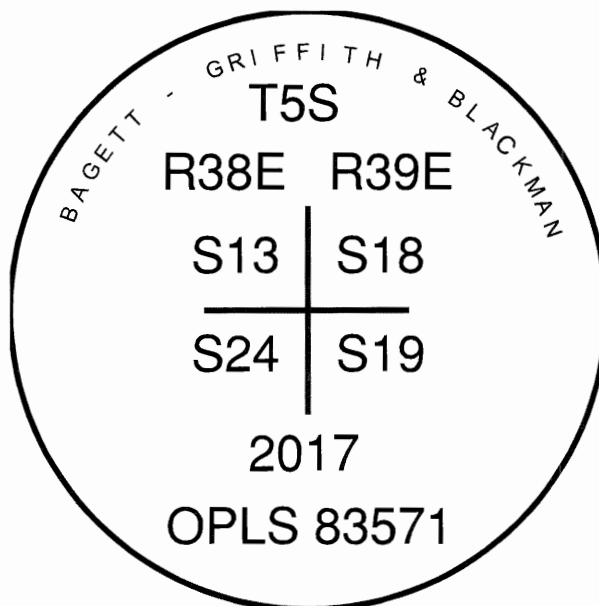

REGISTERED PROFESSIONAL LAND SURVEYOR

OREGON  
June 2, 2010  
JEFFREY S. HSU  
83571

Renewal Date: June 30, 2017

I used a steel tape and magnetic compass in the establishment of the bearing trees. Magnetic declination used was 13° East. Bearings and distances are to the center of the tree.

# HORIZONTAL CONTROL DATA

## UNION COUNTY, OREGON

### OREGON STATE PLANE, NORTH ZONE (3601)

STA NAME: 2017005

SECTION CORNER COMMON TO SECTIONS 13, 18, 19 AND 24

TWP. 5 S. RGE. 38 & 39 E.

GEODETIC COORD: NAD 83(91)

DATE TIED: April 6, 2017

LAT: 45 ° 7 ' 20.90067 " N

SURVEYOR: RICK G. ROBINSON  
OPLS 2219

LONG: 117 ° 59 ' 37.80590 " W

FIRM: BAGETT, GRIFFITH, & BLACKMAN  
2006 ADAMS AVENUE  
LAGRANDE, OR 97850  
(541) 963-6092

SP. COOR: NAD 83(91)

N: 540776.565 INT FT.

E: 8848849.797 INT FT.

TYPE: GPS

THETA: 1 ° 46 ' 38.4138966 "

ORDER: SECOND CLASS: 1

SCALE FACTOR: 0.9998949072

ELEV: 3847.84 US FT.

ELEV: DATUM: NGVD 29

**COMMENTS:**

2 ½" aluminum monument marked  
as shown, in mound of stone

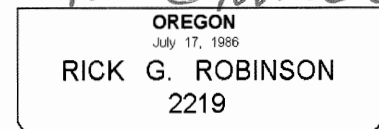
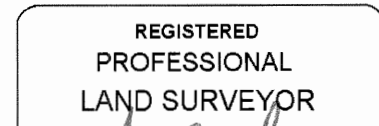
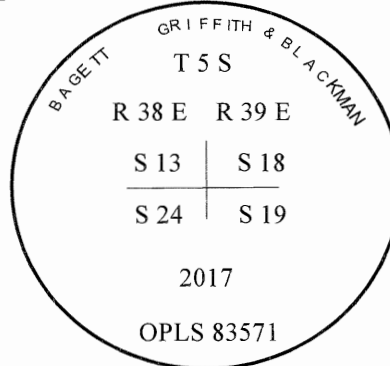

Renewal Date: December 31, 2018

1 METER = 3.280833333... US FEET = 39.37 INCHES

1 METER = 3.280839895 INT'L FEET OR 1 INCH = 2.54 CM

TO CALCULATE ELEVATION FACTOR ( IN THE NORTH AMERICAN CONTINENT)

DIVIDE 20,906,000 BY (20,906,000 + ELLIPSOID ELEV. IN FEET)