

CERTIFIED RECORD OF LAND CORNER MONUMENTATION

S-13

History of original corner establishment:

Corner not set during original GLO survey. No record of corner in Union Co. records.

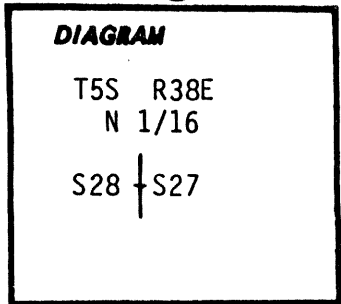

Description of corner evidence found:

None

Description of monument and accessories I established to perpetuate the original location of this corner:

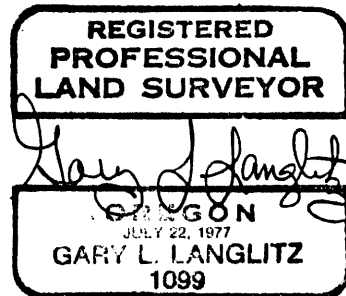

At the corner position determined at a point midway and on line between the West 1/4 and N.W. corner of Section 27, we set a 2"x30" aluminum pipe, 27" in the ground, with aluminum cap, marked:

from which we mark the following BT's:

- A 13" Douglas Fir, scribed "N 1/16 S27 BT" on a double blaze bears N 71°E, 12⁹ ft.
- A 10" Englemann Spruce scribed "N 1/16 S28 BT" on a double blaze, bears S 20°W 10.1 ft.

T5S R38E
N 1/16
S28 | S27
PLS 1099
1984

Attached brass washer marked "LS 1099" to lower blaze of new BT's:
Magnetic Compass (20° East Declination)
Steel Tape

Corner is located approx. 70' West of a creek and in an old and down N-S fenceline.

October 8, 1984

Witnesses:

Gary Langlitz, LS 1099
Ray Crapo
Doug Wright

UNION COUNTY SURVEYOR

Date Received 11-13-84

Date Filed 11-13-84

By G. LANGLITZ, DEPUTY

File No. 1019-84 R

Office of..... County of.....
State of....., I hereby certify that the within instrument was filed in this office
for record on the..... day of....., 19.....

..... by

(COUNTY OFFICIAL) (DEPUTY)