

CERTIFIED RECORD OF LAND CORNER MONUMENTATION

HISTORY OF ORIGINAL CORNER ESTABLISHED:

Corner originally established by W. B. Barr under GLO contract number 388 dated May 7, 1881. Surveyor General field notes state:
 Marked basalt rock 12x8x6 for 1/4 sec. cor. from which:
 A Fir 10 in. diam. bears S19°W 11 lks. dist.
 A Fir 10 in. diam. bears S40°E 8 lks. dist.

T 5 S R 38 E C-17

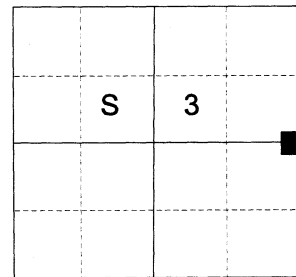

DESCRIPTION OF CORNER EVIDENCE FOUND:

None found.

SEE SURVEY 035-2020

DESCRIPTION OF MONUMENT AND ACCESSORIES I ESTABLISHED TO MONUMENT THE ORIGINAL LOCATION OF THIS CORNER:

At proportionate position I set a 2 1/2" x 30" aluminum pipe, 27" in the ground, with 3" aluminum cap marked as shown below and in a 1.5' diam. mound of stone,
 From which:

NEW BEARING OBJECTS:

- A 5" Engleman Spruce bears North 68° East a dist. of 7.60 ft., marked 1/4 S2 BT.
- A 5" Lodgepole Pine bears South 7° East a dist. of 17.65 ft., marked 1/4 S2 BT.
- A 22" Engleman Spruce bears South 33° West a dist. of 15.85 ft., marked 1/4 S3 BT. (tree also has BLM loc. tag)
- A 15" Engleman Spruce bears North 61° West a dist. of 12.00 ft., marked 1/4 S3 BT.

A steel fence post bears East approx. 1'

I hereby certify that the corner was monumented on September 9, 2020.
 Witness: Kyle A. Tucker

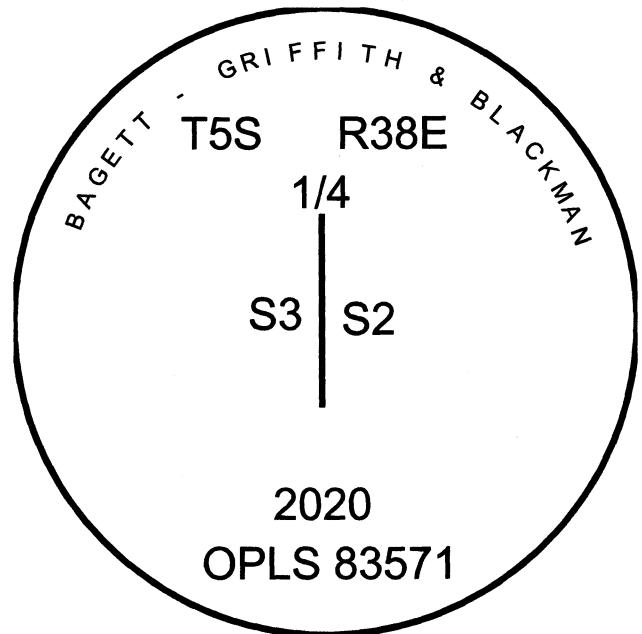

Renewal Date: June 30, 2021

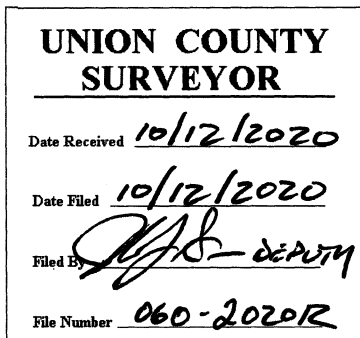

I used a steel tape and magnetic compass in the establishment of the new accessories. I used 14° East declination, the distances are to a 60d spike driven into the right side of the root crown of the bearing trees. A brass washer marked OPLS 83571 is attached to the BT blaze of the new bearing trees.