

CERTIFIED RECORD OF LAND CORNER MONUMENTATION

HISTORY OF ORIGINAL CORNER ESTABLISHED:

Corner not previously established.

T 5 S R 38 E C-14

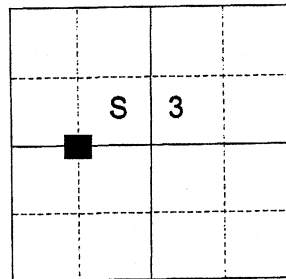

DESCRIPTION OF CORNER EVIDENCE FOUND:

None.

SEE SURVEY NUMBER 036-2024

DESCRIPTION OF MONUMENT AND ACCESSORIES I ESTABLISHED TO MONUMENT THE ORIGINAL LOCATION OF THIS CORNER:

At position determined by survey, I set a 5/8 x 17" iron pin, drilled 13" into rock, with a 2 1/2" aluminum cap marked as shown below and in a 2 ft. diam. collar of stone, from which:

NEW BEARING OBJECTS:

A 15" diam. Ponderosa Pine bears South 35° East, a distance of 47.75 feet, marked CW 1/16 S3 BT.

A 5/8" x 13" iron pin, drilled into rock, bears South 60 1/2° West, a distance of 25.00 feet, with 1 1/2" aluminum cap marked BGB SURVEY MARKER.

Set steel fence post approx. 3 ft. South

Corner falls approx. 200 ft. East of end of North/South running forest road on top of a ridge.

I hereby certify that the corner was monumented on September 16, 2024.

Witnesses: Kyle Tucker

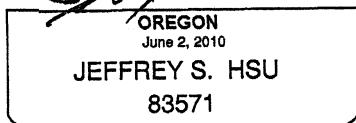
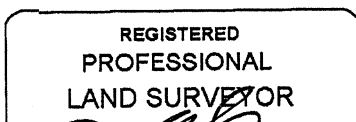
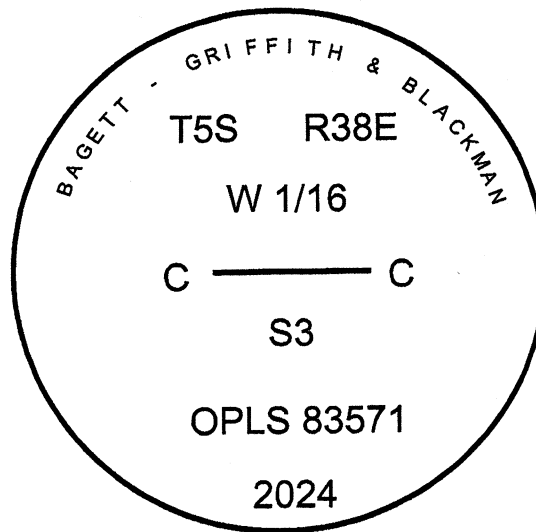

Renewal Date: June 30, 2025

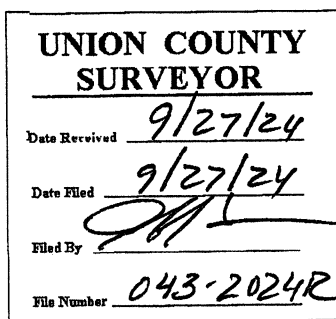

I use a tape and compass in the establishment of the new bearing objects. I use 14° East declination. Bearings are measured to a brass washer labeled "OPLS 83571" in the BT blaze at the base of the tree or to the center of the aluminum caps. Distances are to a 60D nail in the right side of the base of the center of the tree or to the center of the aluminum caps.