

USDA-FOREST SERVICE D-7100-52(2/82)
 Index File No. E 7
 T 5.5 R. 37 E R.D. LaGrande County Union State Or. Cor. No. 54 Cor. of Section 5
 Merid. W 11 N.F. W-W State Or.

CORNER DIAGRAM per Legend

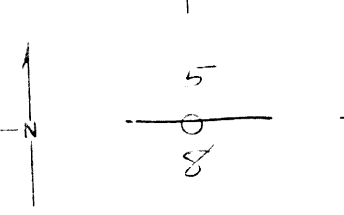

DESCRIBE CORNER MONUMENT FOUND
Botted remains of post in ground

DESCRIBE BEARING TREES OR OTHER OFFICIAL ACCESSORIES FOUND
Sec. 8 10" LP, Live 4.5 BT visible
Sec. 5 rotted remains of stump

PHOTO IDENTIFICATION DATA
 Photo No. _____
 Filed At. _____
 Object Ident. _____
 Ident. By _____
 Signature _____

DESCRIBE CORNER LOCATION RELATIVE TO NEAR-BY FEATURES, ALSO HOW TO REACH CORNER
approx 75' East of sta 35+00
on road #4305271 (proposed road)

CORNER LEGEND:
 PS or Contr. Unverified
 Other
 Searched For/Not Found
 Evidence Found/Accept.
 Permanent Mon. Set/Pd.

Searched By: Dave Dahlstrom CET, LaGrande 6-24-85

CORNER RECORD (PERPETUATION)

MONUMENT DESCRIBE NEW MONUMENT SET, OR WORK DONE TO PRESERVE EXISTING MONUMENT
Attached 54-3 ~~signs~~ signs to AF in
Sec 8 and painted with red band

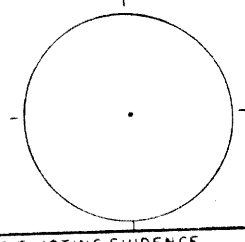

ACCESSORIES DESCRIBE NEW BT'S WITNESS OBJECTS ETC. ESTABLISHED, OR WORK DONE TO PRESERVE EXISTING EVIDENCE

Work Done By _____ Title _____ Date _____ State Registration No. or Agency _____
 Plat or Certified Cor Record Prepared? Yes No Filed At. _____ Co. Surveyor's Office Date _____

History of Surveys, G.L.O., etc.
Pine 8" N55 W 8 Lx5 5.3'
Pine 8" S 10 E 7 Lx5 4.6'

Index File No. _____ T. _____, R. _____, Contract or Surv. No. _____ Cor. _____

UNION COUNTY SURVEYOR
 Date Received _____
 Date Filed 12-23-87
 By G. LANGLITZ, DEPUTY
 File No. 357-87R

E-7

CERTIFIED RECORD OF LAND CORNER MONUMENTATION

History of original corner establishment:

William R. Gradon conducted the survey of Township 5 South, Range 37 East, W.M., under GLO contract No. 445, dated June 1, 1882.

Gradon set a post for the corner point, from which:

- A black pine 8" dia. bears N 55° W at 8 lks.
- A black pine 8" dia. bears S 10° E at 7 lks.

E-7

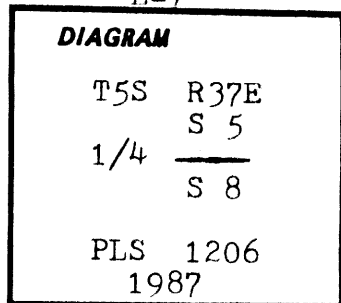

Description of corner evidence found:

BT's-

A live 10" dia. Lodgepole Pine bears S 10° E at 4.6 ft. dist., mkd. 1/4 S / BT.

A rotted stump, size indeterminate, bears N 55° W at 5.3 ft. dist. unmarked.

Description of monument and accessories I established to perpetuate the original location of this corner:

Corner point re-established from the two original found bearing trees.

At the corner point, set a 2 1/2" x 30" aluminum pipe 15" into the ground, with no stone mound. 2 1/2" aluminum cap mkd. as shown in the corner diagram.

From the corner point: (New BT's)

A 9" dia. Tamarack bears N 39° W at 15.0 ft. dist., mkd. 1/4 S 5 BT.

Attached U.S.F.S. 54-9 and 54-3 signs to the bearing trees, and painted the blaze and a 6" band around the bearing trees red. Attached a 3/4" dia. brass I.D. washer mkd. PLS 1206, between the B and T scribes. Set a steel fence post 4' East with U.S.F.S. 54-9 sign attached to it. Used 18 1/2° declination on a staff compass for readings to the bearing trees, and used a steel tape to measure to a nail set in the side of the bearing trees at the base.

This corner was monumented to U.S.F.S. specifications on May, 1987, witnessed by Tom Fisk and Larry McBroom.

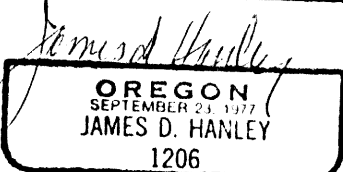
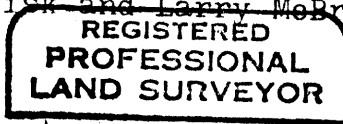

UNION COUNTY SURVEYOR	
Date Received	5-1-89
Date Filed	5-15-89
By	G. LANGLITZ, DEPUTY
File No.	64-89 R

Office of... County Surveyor..... County of... Union

State of... Oregon.....

I hereby certify that the within instrument was filed in this office for record on the..... day of....., 19.....

..... by (COUNTY OFFICIAL) (DEPUTY)