

CERTIFIED RECORD OF LAND CORNER MONUMENTATION

HISTORY OF ORIGINAL CORNER ESTABLISHED:

Not previously established.

T 4 S R 41 E Y-12

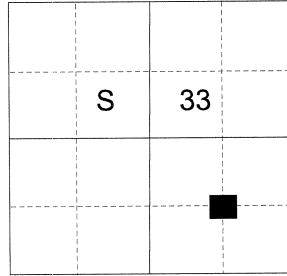

DESCRIPTION OF CORNER EVIDENCE FOUND:

None.

DESCRIPTION OF MONUMENT AND ACCESSORIES I ESTABLISHED TO MONUMENT THE LOCATION OF THIS CORNER:

At position by survey I set a 5/8" x 30" iron pin, 28" in the ground, with 2 1/2" aluminum cap marked as shown below, from which:

NEW BEARING OBJECTS:

A 6' tall rock outcrop, bears South 30° West, a dist. of 11.93 ft., marked X BO.
A 4" Douglas Fir bears South 63° West, a dist. of 9.50 ft., marked SE 1/16 S33 BT.

Set steel fence post approx. 1 ft. South

I hereby certify that the corner was perpetuated on November 25, 2019.

Witness: Kyle A. Tucker

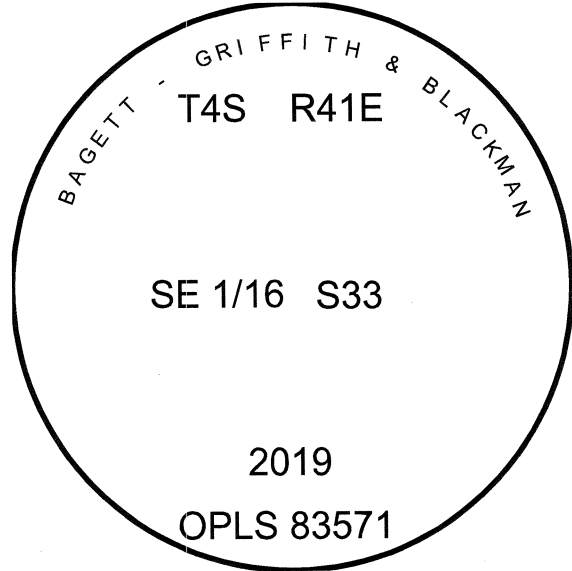

Renewal Date: June 30, 2021

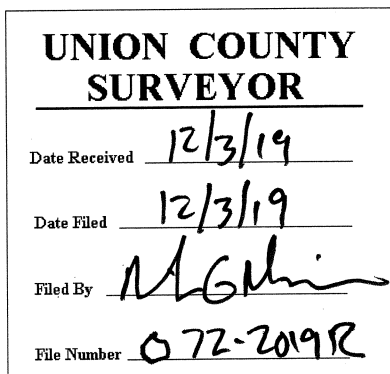

I used a steel tape and magnetic compass with 13° East declination in the establishment of the new accessories. The distance is to a 60d spike driven into the right side of the root crown of the bearing tree. A brass washer marked OPLS 83571 is attached to the BT blaze of the new bearing tree. Bearing and distance is to the center of the X of the rock outcrop.