

**CERTIFIED RECORD OF LAND CORNER MONUMENTATION**

**History of original corner establishment:**

Corner originally established by Henry M. Thatcher under GLO contract number 320, dated April 1, 1879. Surveyor General record states:

Set stone 15x7x5 for 1/4 sec cor from which;

A pine 12 in dia bears N10°E, 77 lks dist  
A pine 30 in dia bears S20°W, 87 lks dist

Corner was searched for on a survey by J.W. Kimbrell on survey dated April 19, 1888 and recorded as survey number 32 in the old book of County surveys. His notes state: Found no 1/4 sec corner, Set post, built mound of stone for 1/4 sec corner from which;  
A pine 4 inches dia. bears N6°15'W, 35 lks dist  
A pine 12 inches dia. bears S2°E, 100 lks dist

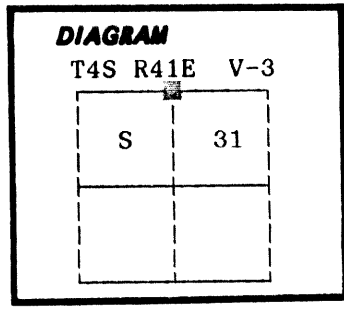

No record of subsequent monumentation found in Union County survey records.

**Description of corner evidence found:**

Found Mr. Kimbrell's Southeast bearing tree.  
Found a 20 inch diameter snag 8 feet high, S2°E, 100 lks, standing with 1/4 S BT scribes visible (Scribed with knife)

Distance measured to the face of the BT blaze.

No evidence of the post or other bearing tree.

Corner falls 6 ft. North and 6 ft. West of fence corner with fences running South and West, and 6 ft. North and 15 ft. East of fence corner with fences running North, East and West.

A search was made for Mr. Thatcher's corner, but no evidence was found.

See Union County survey number 29-88

UNION COUNTY SURVEYOR	
Date Received	<u>8-9-88</u>
Date Filed	<u>8-24-88</u>
By	<u>G. LANGRITZ, Deputy</u>
File No.	<u>98-88R</u>

**Description of monument and accessories I established to perpetuate the original location of this corner:**

At record bearing and distance from the above described Kimbrell bearing tree, I set a 2 1/2" x 30" aluminum pipe with aluminum cap marked as shown, 28 inches in the ground, from which;

New BTs  
A 18 inch diameter Douglas Fir bears S44°W, 36.94 feet marked 1/4 S31 BT  
A 19 inch diameter Douglas Fir bears N48°W, 12.54 feet marked 1/4 S30 BT

Raised a small mound of stone around monument.

Painted a 6 inch red band around all BTs and attached 54-3 and 54-9 signs.

Set a steel fencepost approximately 5 feet West with 54-9 sign attached

I hereby certify that the above corner point was perpetuated as hereon described on July 21, 1988.

Witness: Duane Griffith

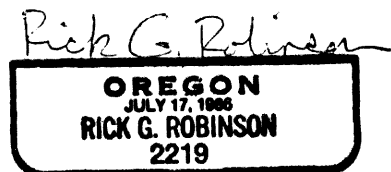
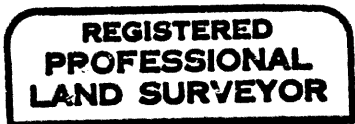
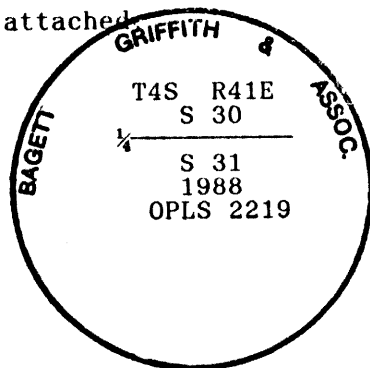

I used a steel tape and magnetic compass in the establishment of new accessories. I used 18° magnetic declination. The distances are to a 50d spike driven in the right side of the root crown. I attached a brass washer marked OPLS 2219 to the BT blaze.

Office of..... County of.....  
State of....., I hereby certify that the within instrument was filed in this office for record on the..... day of....., 19.....  
..... by .....  
(COUNTY OFFICIAL) (DEPUTY)

**CERTIFIED RECORD OF LAND CORNER MONUMENTATION**

**HISTORY OF ORIGINAL CORNER ESTABLISHMENT:**

Corner originally established by Henry M. Thatcher under GLO contract number 320, dated April 1, 1879. Surveyor General record states:

Set stone 15x7x5 for 1/4 sec cor, from which:

- A pine 12 in. dia. bears N 10° E, 77 lks. dist.
- A pine 30 in. dia. bears S 20° W, 87 lks. dist.

Corner was searched for by J.W. Kimbrell on Survey Number 32, dated April 19, 1888. Survey record states:

Found no 1/4 sec corner. Set post, built mound of stone for 1/4 sec cor from which:

- A pine 4 inches dia. bears N6°15'W, 35 lks. dist.
- A pine 12 inches dia. bears S2°E, 100 lks. dist.

Kimbrell corner reestablished by Survey Number 29-88, by SE bearing tree. Union County monumentation records states:

Found a 20 inch diameter snag 8 feet high, S2°E, 100 lks, standing with 1/4S BT scribed visible. (Scribed with knife)

At record bearing and distance from the above described Kimbrell bearing tree, I set a 2 1/2"x30" aluminum pipe with aluminum cap marked as shown, 28 inches in the ground, from which:

- A 18 inch Douglas Fir bears S. 44° W., 36.94 feet, marked 1/4 S 31 BT.
- A 19 inch Douglas Fir bears N. 48° W., 12.54 feet, marked 1/4 S 30 BT.

**DESCRIPTION OF CORNER EVIDENCE FOUND:**

Found 2 1/2" Aluminum pipe with 2 1/2" cap, marked as shown below, 2 inches above ground, in a collar of stone 2 ft. diam., from which:

- A snag, 8 ft. high, bears South 2° East, a distance of 66.00 feet, with visible scribe marks.
- A 20 inch Douglas Fir bears South 44° West, a distance of 36.94 feet, with a healed blaze.

Northwest bearing tree found down and dead, with healed blaze.

A steel fencepost falls approx. 3 ft West of corner.

**DESCRIPTION OF MONUMENT AND ACCESSORIES I ESTABLISHED**

**TO PERPETUATE THE ORIGINAL LOCATION OF THIS CORNER:**

From the corner monument position,

**NEW BEARING OBJECTS**

- A 5/8"x30" iron pin bears North 44° East, a distance of 28.60 feet, with 1 1/2" aluminum cap marked NE RP.
- A 5/8"x30" iron pin bears South 62° East, a distance of 10.87 feet, with 1 1/2" aluminum cap marked SE RP. Pin falls at base of an existing fence corner.
- A 5/8"x30" iron pin bears North 69° West, a distance of 21.35 feet, with 1 1/2" aluminum cap marked NW RP. Pin falls in a North/South running fenceline.

I hereby certify that the corner was perpetuated on October 22, 2010.

Witness: Jeff Hsu, Gregory T. Blackman, Jr.

T 4S R 41 E V-03

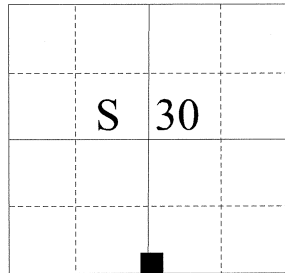

**REGISTERED  
PROFESSIONAL  
LAND SURVEYOR**

**OREGON**  
July 17, 1986

**RICK G. ROBINSON**  
2219

Renewal Date: December 31, 2010

BAGETT - GRIFFITH & ASSOCIATES

T 4S R 41 E

1/4      S 30

            S 31

            1988

OPLS 2219

**UNION COUNTY  
SURVEYOR**

Date Received 10/27/2010

Date Filed 1/17/2011

Filed By [Signature]

File Number 038-2010R

I used a steel tape and magnetic compass in the establishment of the accessories. I used 16° East declination, the distances are to a 60d spike driven into the root crown at the right side of the bearing trees and to the center of the aluminum cap accessories.

# HORIZONTAL CONTROL DATA

## UNION COUNTY, OREGON

### OREGON STATE PLANE, NORTH ZONE (3601)

STA NAME: 201023

QUARTER CORNER COMMON TO SECTION 30 AND 31

TWP. 4 S. RGE. 41 E.

GEODETIC COORD: NAD 83(91)

DATE TIED: OCTOBER 19, 2010

LAT: 45 ° 10 ' 48.04721 " N

SURVEYOR: RICK G. ROBINSON  
OPLS 2219

LONG: 117 ° 44 ' 9.66747 " W

FIRM: BAGETT, GRIFFITH, & BLACKMAN  
2006 ADAMS AVENUE  
LAGRANDE, OR 97850  
(541) 963-6092

SP. COOR: NAD 83(91)

N: 563912.299 INT FT.

E: 8914640.490 INT FT.

TYPE: GPS

THETA: 1 ° 57 ' 36.6 "

ORDER: SECOND CLASS: 1

SCALE FACTOR: 0.999894602

ELEV: 4175.10 US FT.

ELEV: DATUM: NGVD 29

**COMMENTS:**

Corner is 2 1/2" aluminum pipe with aluminum cap marked as shown

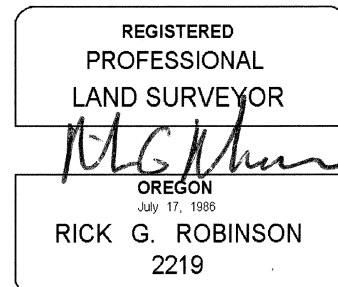
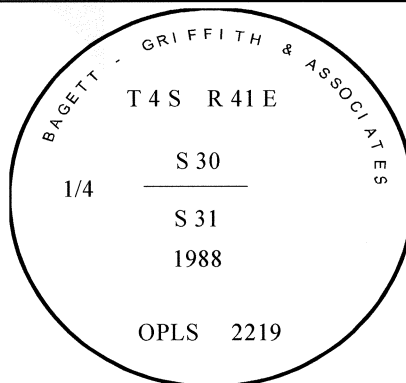

Renewal Date: December 31, 2010

1 METER = 3.280833333... US FEET = 39.37 INCHES

1 METER = 3.280839895 INT'L FEET OR 1 INCH = 2.54 CM

TO CALCULATE ELEVATION FACTOR ( IN THE NORTH AMERICAN CONTINENT)

DIVIDE 20,906,000 BY (20,906,000 + ELLIPSOID ELEV. IN FEET)