

CERTIFIED RECORD OF LAND CORNER MONUMENTATION

History of original corner establishment:

Corner originally established by Henry M. Thatcher under GLO contract number 320, dated April 1, 1879. Surveyor General record states:

Set a fir post 4 ft. long 4 in. dia. for $\frac{1}{4}$ sec cor from which;
 A fir 12 in. dia. bears N80°W, 18 lks dist.
 A fir 18 in. dia. bears S50°E, 41 lks dist.

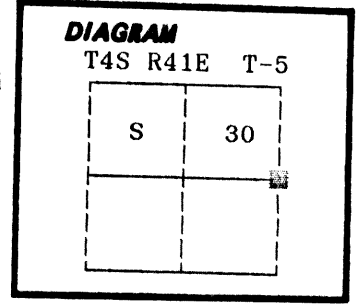

No record of subsequent monumentation found in Union County survey records.

Description of corner evidence found:

Found no evidence of the original corner or it's accessories.
 Area has been heavily logged.
 See Union County survey number 29-88

UNION COUNTY SURVEYOR

Date Received 8-9-88

Date Filed 8-24-88

By G. LANGLITZ, DEPUTY

File No. 108-88 R

Description of monument and accessories I established to perpetuate the original location of this corner:

At position determined by survey, I set a $2\frac{1}{2}$ " x 30" aluminum pipe with aluminum cap marked as shown, 26 inches in the ground, from which;

New BTs
 A 16 inch diameter Ponderosa Pine bears S86°E, 47.65 feet marked $\frac{1}{4}$ S29 BT
 A 13 inch diameter Ponderosa Pine bears S11°W, 27.09 feet marked $\frac{1}{4}$ S30 BT

Painted a 6 inch red band around all BTs and attached 54-3 and 54-9 signs.
 Set a steel fencepost approximately 5 feet South with 54-9 sign attached.

I hereby certify that the above corner point was perpetuated as hereon described on July 20, 1988.

Witness: Duane Griffith

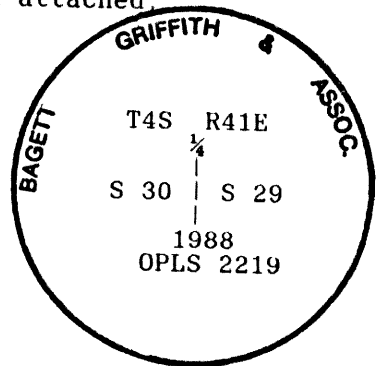

REGISTERED PROFESSIONAL LAND SURVEYOR

Rick G. Robinson

OREGON
JULY 17, 1906
RICK G. ROBINSON
2219

I used a steel tape and magnetic compass in the establishment of new accessories. I used 18° magnetic declination. The distances are to a 50d spike driven in the right side of the root crown. I attached a brass washer marked OPLS 2219 to the BT blaze.

Office of..... County of.....
 State of....., I hereby certify that the within instrument was filed in this office
 for record on the..... day of....., 19.....
 by
 (COUNTY OFFICIAL) (DEPUTY)

CERTIFIED RECORD OF LAND CORNER MONUMENTATION

HISTORY OF ORIGINAL CORNER ESTABLISHMENT:

Corner originally established by Henry M. Thatcher under GLO contract number 320, dated April 1, 1879. Surveyor General record states:

Set a fir post 4 ft. long 4 in. dia. For 1/4 sec. cor, from which:

- A fir 12 in. dia. bears N 80° W, 18 lks. dist.
- A fir 18 in. dia. bears S 50° E, 41 lks. dist.

Corner reestablished by Survey Number 29-88, by proportionate position. No remaining evidence of original corner position found. Union County monumentation records states:

Set a 2 1/2"x30" aluminum pipe with aluminum cap marked as shown, 26 inches in the ground, from which:

- A 16 inch Ponderosa Pine bears S. 86° E., 47.65 feet, marked 1/4 S 29 BT.
- A 13 inch Ponderosa Pine bears S. 11° W., 27.09 feet, marked 1/4 S 30 BT.

T 4S R 41 E T-05

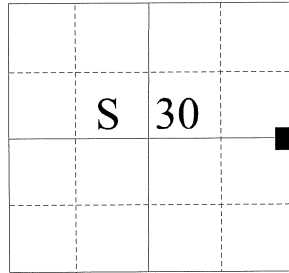

DESCRIPTION OF CORNER EVIDENCE FOUND:

Found 2 1/2" Aluminum pipe with 2 1/2" cap, marked as shown below, 4 inches above ground, from which:

- A 21 inch Ponderosa Pine bears South 86° East, a distance of 47.65 feet, with a healed blaze.
- A 23 inch Ponderosa Pine bears South 11° West, a distance of 27.09 feet, with a healed blaze.

DESCRIPTION OF MONUMENT AND ACCESSORIES I ESTABLISHED

TO PERPETUATE THE ORIGINAL LOCATION OF THIS CORNER:

From the corner monument position,

NEW BEARING TREES

- A 9 inch Ponderosa Pine bears North 30° East, a distance of 31.85 feet, marked 1/4 S29 BT.
- A 4 inch Ponderosa Pine bears North 58° West, a distance of 17.65 feet, marked X BT.

I hereby certify that the corner was perpetuated on October 19, 2010.

Witness: Jeff Hsu, Gregory T. Blackman, Jr.

REGISTERED
PROFESSIONAL
LAND SURVEYOR

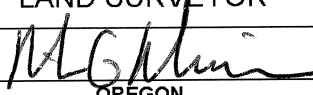

OREGON
July 17, 1986
RICK G. ROBINSON
2219

Renewal Date: December 31, 2010

BAGETT - GRIFFITH & ASSOCIATES

T 4S R 41 E
1/4
S 30 | S 29
1988
OPLS 2219

**UNION COUNTY
SURVEYOR**

Date Received 10/27/2010
Date Filed 11/17/2010
Filed By Gregory T. Blackman
File Number 039-2010R

I used a steel tape and magnetic compass in the establishment of the accessories. I used 16° East declination, the distances are to a 60d spike driven into the root crown at the right side of the bearing trees. I place a brass washer marked OPLS 2219 in the lower blaze of the new accessories.

HORIZONTAL CONTROL DATA
UNION COUNTY, OREGON
OREGON STATE PLANE, NORTH ZONE (3601)

STA NAME: 201022

QUARTER CORNER COMMON TO SECTION 29 AND 30

TWP. 4 S. RGE. 41 E.

GEODETIC COORD: NAD 83(91)

DATE TIED: OCTOBER 19, 2010

LAT: 45 ° 11 ' 14.86114 " N

SURVEYOR: RICK G. ROBINSON
OPLS 2219

LONG: 117 ° 43 ' 29.20688 " W

FIRM: BAGETT, GRIFFITH, & BLACKMAN
2006 ADAMS AVENUE
LAGRANDE, OR 97850
(541) 963-6092

SP. COOR: NAD 83(91)

N: 566725.521 INT FT.

E: 8917443.466 INT FT.

TYPE: GPS

THETA: 1 ° 58 ' 5.3 "

ORDER: SECOND CLASS: 1

SCALE FACTOR: 0.999894636

ELEV: 4649.08 US FT.

ELEV: DATUM: NGVD 29

COMMENTS:

Corner is 2 1/2" aluminum pipe with
aluminum cap marked as shown

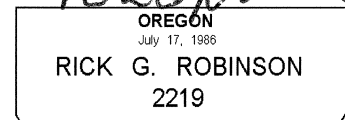
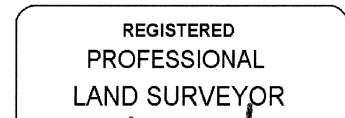
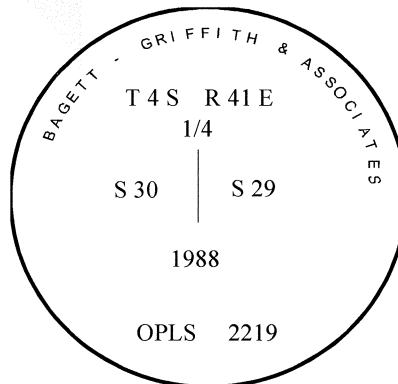

Renewal Date: December 31, 2010

1 METER = 3.280833333... US FEET = 39.37 INCHES

1 METER = 3.280839895 INT'L FEET OR 1 INCH = 2.54 CM

TO CALCULATE ELEVATION FACTOR (IN THE NORTH AMERICAN CONTINENT)

DIVIDE 20,906,000 BY (20,906,000 + ELLIPSOID ELEV. IN FEET)