

**CERTIFIED RECORD OF LAND CORNER MONUMENTATION**

**History of original corner establishment:**

Corner originally established by John H. Stone under GLO contract number 235, dated July 6, 1875. Surveyor General record states:

Set stone 20"x14"x10" for corner to sections 25 and 30

Corner was found by J.W. Kimbrell on survey dated April 19, 1888, filed as survey number 32 in the old book of Union County Surveys. Mr. Kimbrell does not describe the corner monument other than "The 1/4 sec cor btween Secs 25 and 30"

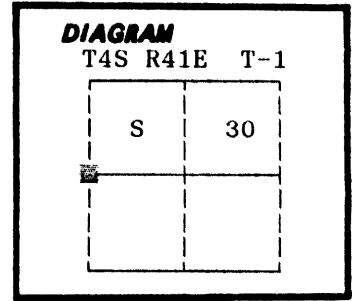

No record of subsequent monumentation found in Union County survey records.

**Description of corner evidence found:**

Found a stone 20x14x9 inches marked 1/4  
See Union County survey number 29-88

UNION COUNTY SURVEYOR	
Date Received	<u>8-9-88</u>
Date Filed	<u>8-24-88</u>
By	<u>G. LANGUTZ, DEPUTY</u>
File No.	<u>99-88 R</u>

**Description of monument and accessories I established to perpetuate the**

**original location of this corner:** At the position of the found original corner stone, I set a 2 1/2" x 30" aluminum pipe with aluminum cap marked as shown, 24 inches in the ground, from which;

New BTs

A 19 inch diameter double bole Ponderosa Pine bears S77°E, 79.31 feet marked 1/4 S30 BT  
A 10 inch diameter Ponderosa Pine bears N34°W, 69.72 feet marked 1/4 S25 BT

Painted a 6 inch red band around all BTs and attached 54-3 and 54-9 signs.

Set a steel fencepost approximately 5 feet North with 54-9 sign attached.

Buried the original corner stone West and alongside of monument.

I hereby certify that the above corner point was perpetuated as hereon described on July 21, 1988.

Witness: Duane Griffith

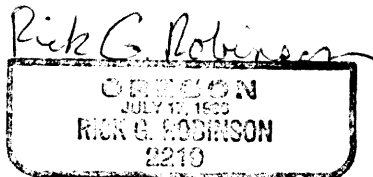
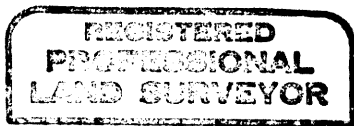
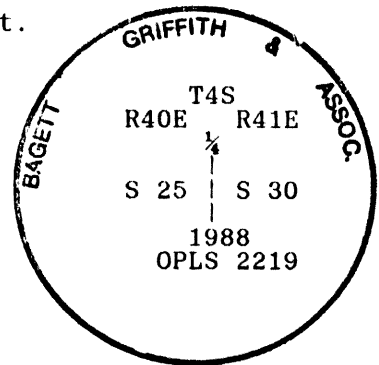

I used a steel tape and magnetic compass in the establishment of new accessories. I used 18° magnetic declination. The distances are to a 50d spike driven in the right side of the root crown. I attached a brass washer marked OPLS 2219 to the BT blaze.

Office of..... County of.....  
State of....., I hereby certify that the within instrument was filed in this office for record on the..... day of....., 19.....  
..... by .....  
(COUNTY OFFICIAL) (DEPUTY)

# HORIZONTAL CONTROL DATA

## UNION COUNTY, OREGON

### OREGON STATE PLANE, NORTH ZONE (3601)

STA NAME: 201024

QUARTER CORNER COMMON TO SECTION 25 AND 30, RANGE 40-41

TWP. 4 S. RGE. 40/41 E.

GEODETIC COORD: NAD 83(91)

DATE TIED: OCTOBER 22, 2010

LAT: 45 ° 11 ' 14.02108 " N

SURVEYOR: RICK G. ROBINSON  
OPLS 2219

LONG: 117 ° 44 ' 52.70220 " W

FIRM: BAGETT, GRIFFITH, & BLACKMAN  
2006 ADAMS AVENUE  
LAGRANDE, OR 97850  
(541) 963-6092

SP. COOR: NAD 83(91)

N: 566435.995 INT FT.

E: 8911470.397 INT FT.

TYPE: GPS

THETA: 1 ° 57 ' 6.1 "

ORDER: SECOND CLASS: 1

SCALE FACTOR: 0.999894635

ELEV: 3826.24 US FT.

ELEV: DATUM: NGVD 29

#### COMMENTS:

Corner is 2 1/2" aluminum pipe with  
aluminum cap marked as shown

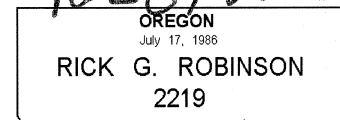
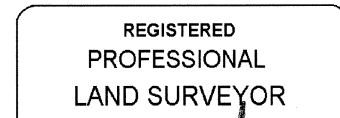
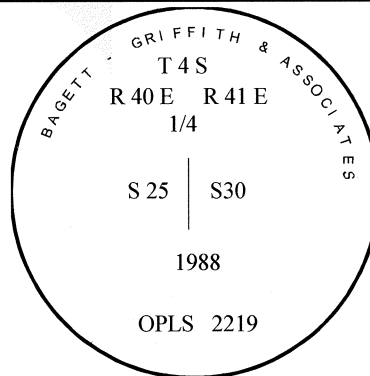

Renewal Date: December 31, 2010

1 METER = 3.280833333... US FEET = 39.37 INCHES

1 METER = 3.280839895 INT'L FEET OR 1 INCH = 2.54 CM

TO CALCULATE ELEVATION FACTOR ( IN THE NORTH AMERICAN CONTINENT)

DIVIDE 20,906,000 BY (20,906,000 + ELLIPSOID ELEV. IN FEET)