

CERTIFIED RECORD OF LAND CORNER MONUMENTATION

History of original corner establishment:

Corner not previously established

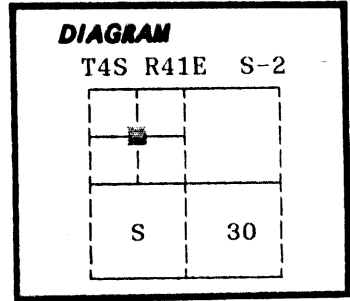

No record of subsequent monumentation found in Union County survey records.

Description of corner evidence found:

Corner not previously established

See Union County survey number 29-88

UNION COUNTY SURVEYOR	
Date Received	<u>8-9-88</u>
Date Filed	<u>8-24-88</u>
By	<u>G. LANGRITZ, DEPT</u>
File No.	<u>107-88 R</u>

Description of monument and accessories I established to perpetuate the

original location of this corner: At the position determined by survey, I set a 2½" x 30" aluminum pipe with aluminum cap marked as shown, 30 inches in the ground, from which;

- New Bearing Tree and Bearing object;
- A 5/8"x30" iron pin with plastic cap marked BGA SURVEY MARKER bears North, 3.33 feet
- A 23 inch diameter Ponderosa Pine bears S39°W, 48.28 feet marked NW1/16 S30 BT

Set a steel fencepost approximately 3 feet North with 54-9 sign attached.

I hereby certify that the above corner point was perpetuated as hereon described on July 27, 1988.

Witness: Jeff Petersen

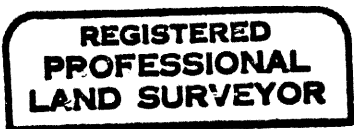
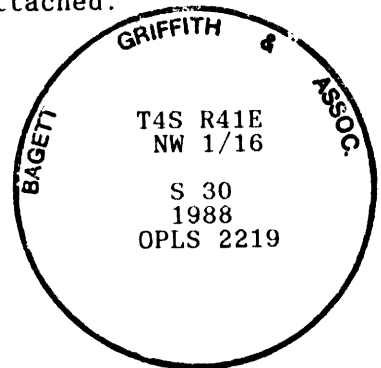

Rick G. Robinson

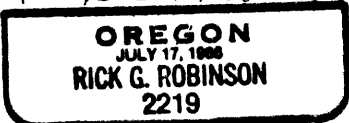

I used a steel tape and magnetic compass in the establishment of new accessories. I used 18° magnetic declination. The distances are to a 50d spike driven in the right side of the root crown. I attached a brass washer marked OPLS 2219 to the BT blaze.

Office of..... County of.....

State of....., I hereby certify that the within instrument was filed in this office for record on the..... day of....., 19.....

..... by (COUNTY OFFICIAL) (DEPUTY)