

Sec Cor 17, 18, 19, 20 4 S 41 E
Stone 46 x 12 x 6" Found. No
BTs No marks on stone.

1/4 Cor 17-20 4 S 41 E.
Pine Stump fd w/ Axe Blaze.
Apparently lower edge of BT
Blaze. Evidence Rd of
Tamarack down & rotted.
No stone Rd. in place.

} N-7
←

1/4 Cor Between 8 + 9 5 S
41 E
1 BT, Fd. - on down
rotted Pine. Apparently
on East side of corner.

UNION COUNTY SURVEYOR	
Date Received	<u>1-4-88</u>
Date Filed	<u>1-7-88</u>
By	<u>G. LANGLITZ, Deputy</u>
File No.	<u>06-88R</u>

N-7

CERTIFIED RECORD OF LAND CORNER MONUMENTATION

HISTORY OF ORIGINAL CORNER ESTABLISHED:

Corner originally established by Henry M. Thatcher under GLO Contract Number 320, dated April 1, 1879. Surveyor General field notes state:

Set Stone 13x11x5 for 1/4 Sec. Cor. From which:
A Pine 24 in. in dia. bears N52°W, 20 lks. dist.
A Tamarack 20 in. in dia. bears S5°W, 27 lks. dist.

T 4 S R 41 E N-07

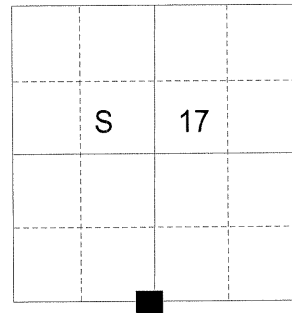

DESCRIPTION OF CORNER EVIDENCE FOUND:

None

See Survey Number 047-2015

DESCRIPTION OF MONUMENT AND ACCESSORIES I ESTABLISHED TO PERPETUATE THE ORIGINAL LOCATION OF THIS CORNER:

At proportionate position, I set a 2½" x 30" aluminum pipe 21" in the ground, marked as shown below, with mound of stone 1 ½ feet base to top of cap. From which:

NEW BEARING TREES:

A 6" Douglas Fir bears North 30° East, a distance of 2.25 feet, marked 1/4 S17 BT.
A 5" Western Larch bears South 72° East, a distance of 23.70 feet, marked 1/4 S20 BT.
A 3" Douglas Fir bears South 29° West, a distance of 8.15 feet, marked 1/4 S20 BT.
A 4" Lodgepole Pine bears North 72° West, a distance of 22.70 feet, marked 1/4 S17 BT.

I set a steel fencepost approx. 1 foot South of corner monument.

I hereby certify that this corner was monumented on July 15, 2015.

Witness: Thomas J. Kopp



Renewal Date: June 30, 2017

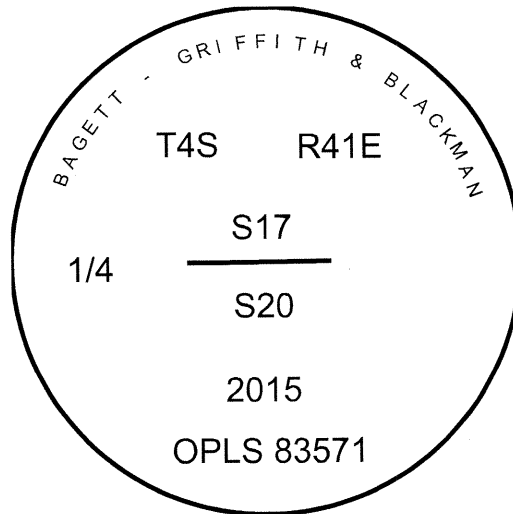
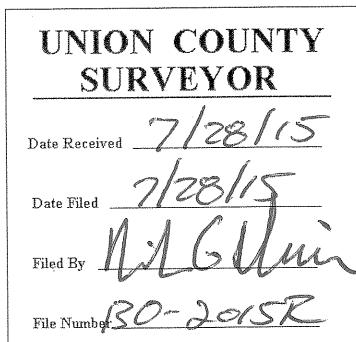

I used a steel tape and magnetic compass in the establishment of the new bearing trees. I used 16° East declination, the distances are to a 60d spike driven into the right side of the root crown of the new bearing trees. A brass washer marked OPLS 83571 is attached to the BT blaze of the new bearing trees.