

CERTIFIED RECORD OF LAND CORNER MONUMENTATION

History of original corner establishment:

Corner originally established by J.W. Kimbrell on survey dated July 13, 1888 and recorded as survey number 41, in the old book of Union County Surveys. His notes state:

Set stone 17x7x6 inches for 1/8 corner from which;
A Pine 30 inches dia. bears S77°W, 665 lks dist.

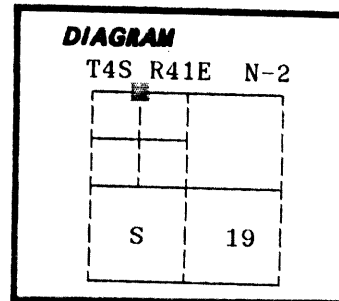

No record of subsequent monumentation found in Union County survey records.

Description of corner evidence found:

No evidence of the Kimbrell corner or it's accessory was found.

See Union County survey number 29-88

UNION COUNTY SURVEYOR	
Date Received	<u>8-9-88</u>
Date Filed	<u>8-24-88</u>
By	<u>G. LANGRISH DEPUTY</u>
File No.	<u>103-88 R</u>

Description of monument and accessories I established to perpetuate the

original location of this corner: At the position determined by survey, I set a 2½" x 30" aluminum pipe with aluminum cap marked as shown, 30 inches in the ground, from which;

New Bearing objects;

A 5/8"x30" iron pin with plastic cap marked BGA SURVEY MARKER bears S56°E, 7.65 feet (pin is set in an existing East-West fenceline)

A 5/8"x30" iron pin with plastic cap marked BGA SURVEY MARKER bears N73°W, 82.14 feet (pin is set in an existing North-South fenceline)

Set a steel fencepost approximately 5 feet South with 54-9 sign attached.

I hereby certify that the above corner point was perpetuated as hereon described on July 26, 1988.

Witnesses: Duane Griffith and Jeff Petersen

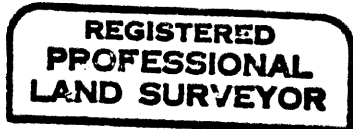
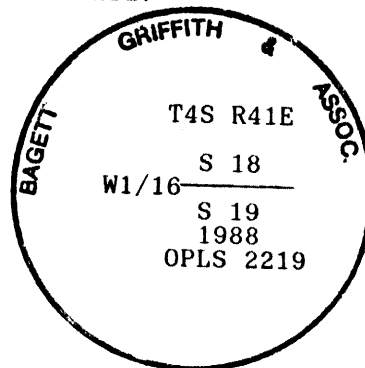

Rick G. Robinson

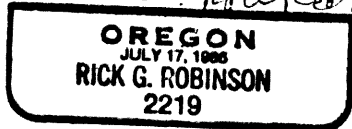

I used a steel tape and magnetic compass in the establishment of new accessories. I used 18° magnetic declination.

Office of..... County of.....
State of....., I hereby certify that the within instrument was filed in this office for record on the..... day of....., 19.....

..... by
(COUNTY OFFICIAL) (DEPUTY)