

**CERTIFIED RECORD OF LAND CORNER MONUMENTATION**

**History of original corner establishment:**

Corner originally established by John H. Stone under GLO contract number 235, dated July 6, 1875. Surveyor General record states:

Set stone 24"x16"x8" for corner to sections 25 and 30

Corner was remonumented by J.W. Kimbrell, Union County Surveyor, on a survey dated July 13, 1888 and recorded as survey number 41 in the old book of Union County surveys. His notes state:

Found no Sec corner. Set stone 18x8x7 inches for corner to Secs 18=19=13&24

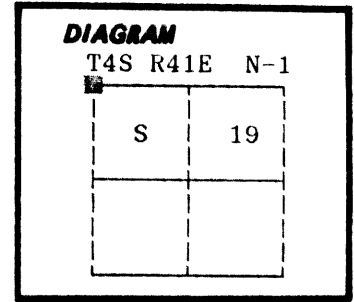

No record of subsequent monumentation found in Union County survey records.

**Description of corner evidence found:**

Found no evidence of the corner monument set by either Mr. Stone or Mr. Kimbrell. The area has been cleared of rocks and farmed.

See Union County survey number 29-88

UNION COUNTY SURVEYOR	
Date Received	<u>8-9-88</u>
Date Filed	<u>8-24-88</u>
By	<u>G. LANGRISH, Deput</u>
File No.	<u>102-88 R</u>

**Description of monument and accessories I established to perpetuate the**

**original location of this corner:** At the position determined by survey, I set a 2½" x 30" aluminum pipe with aluminum cap marked as shown, 24 inches in the ground, from which;

**New Bearing objects**

- A 5/8"x30" iron pin with plastic cap marked BGA SURVEY MARKER bears N41°E, 8.51 feet
- A 5/8"x30" iron pin with plastic cap marked BGA SURVEY MARKER bears S44°E, 6.55 feet
- A 5/8"x30" iron pin with plastic cap marked BGA SURVEY MARKER bears S41°W, 6.88 feet
- A 5/8"x30" iron pin with plastic cap marked BGA SURVEY MARKER bears N44°W, 8.63 feet

Set a steel fencepost approximately 5 feet North with 54-9 sign attached

Raised mound of stone around monument, 3 ft. base to top of cap.

I hereby certify that the above corner point was perpetuated as hereon described on July 26, 1988.

Witnesses: Duane Griffith and Jeff Petersen

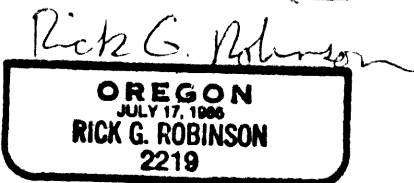
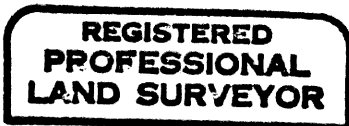
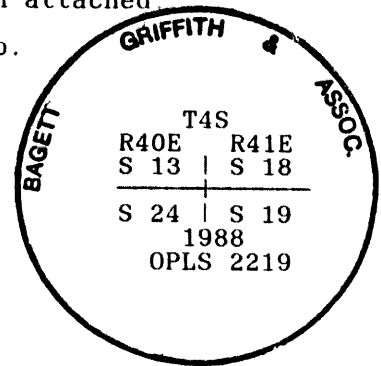

I used a steel tape and magnetic compass in the establishment of new accessories. I used 18° magnetic declination.

Office of..... County of.....  
 State of....., I hereby certify that the within instrument was filed in this office  
 for record on the..... day of....., 19.....

..... by .....  
 (COUNTY OFFICIAL) (DEPUTY)