

**CERTIFIED RECORD OF LAND CORNER MONUMENTATION**

**History of original corner establishment:**

Corner originally established by J.L. Curtis on survey dated March 26, 1894 and recorded as survey number 178, in the old book of Union County Surveys. His notes state:

Set corner for SE corner of SW $\frac{1}{4}$  of NW $\frac{1}{4}$  Sec 18

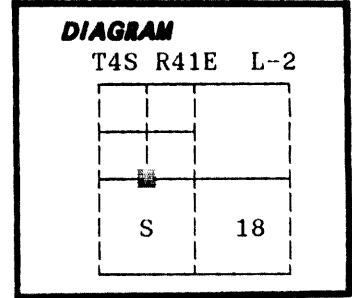

No record of subsequent monumentation found in Union County survey records.

**Description of corner evidence found:**

No evidence of the Curtis corner was found.

See Union County survey number 29-88

**UNION COUNTY SURVEYOR**

Date Received 8-9-88

Date Filed 8-24-88

By G. Langley, Dorr

File No. 101-88 R

**Description of monument and accessories I established to perpetuate the**

**original location of this corner:**

At the position determined by survey, I set a 2 $\frac{1}{2}$ " x 30" aluminum pipe with aluminum cap marked as shown, 12 inches in the ground, in concrete, from which;

New Bearing Trees;

- A 13 inch diameter Ponderosa Pine bears S60°W, 27.39 feet marked CW1/16 S18 BT
- A 10 inch diameter Douglas Fir bears N18°W, 29.90 feet marked CW1/16 S18 BT

Raised mound of stone around monument, 4 ft. base to top of cap.

Set a steel fencepost approximately 5 feet West with 54-9 sign attached.

I hereby certify that the above corner point was perpetuated as hereon described on July 27, 1988.

Witness: Jeff Petersen

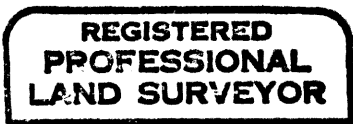
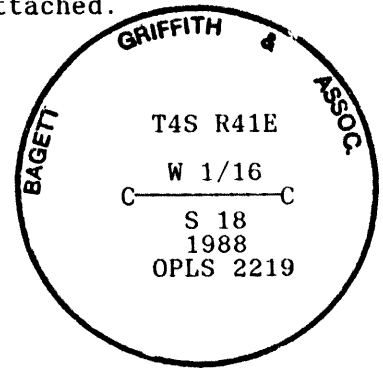

*Rick G. Robinson*

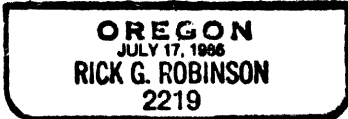

I used a steel tape and magnetic compass in the establishment of new accessories. I used 18° magnetic declination. The distances are to a 50d spike driven in the right side of the root crown. I attached a brass washer marked OPLS 2219 to the BT blaze.

Office of..... County of.....

State of....., I hereby certify that the within instrument was filed in this office for record on the..... day of....., 19.....

..... by ..... (COUNTY OFFICIAL) (DEPUTY)