

CERTIFIED RECORD OF LAND CORNER MONUMENTATION

History of original corner establishment:

Original survey by J. Stone under L.L.O. Contract 235, 1875:
Set an Alder Post with mound and trench as per instructions for 1/4 sec. cor from which:
A Fir 20" dia. bears South 8° East 18 lks. distant.
A Fir 18" dia. bears North 85° West 48 lks. distant.

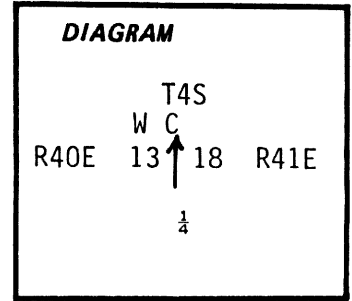

Description of corner evidence found:

The original SE bearing tree, a 30" dia. Grand Fir Snag with scribing "1/4 BT" on a previously opened chest-high single blaze.
The record position of the SW BT is in a fast-flowing creek, no evidence found for this BT.

Description of monument and accessories established to perpetuate the original location of this corner:

The true corner as established by record measurement from the original SE BT is located at water level approx. 7 ft. South of the South Bank of Peter's Creek as described in the original survey. This location is subject to annual flooding, therefore, we establish a Witness Corner at a point 16.0 ft. South of the true corner position.

At the Witness Corner, we set a 2"x30" Galvanized Iron Pipe 24" in the ground with brass cap attached, marked:

From Which:

The true corner position bears North 16.0 ft.
We mark new bearing trees for the Witness Corner:
A 14" Grand Fir scribed "X BT" on a double blaze bears S58°E 32.5 ft.
And a 16" Grand Fir scribed "WCX BT" on a double blaze bears S73°W 38.1 ft.

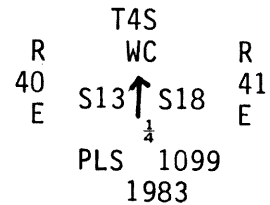

Attached brass washer marked "LS 1099" to lower blaze of new BT's.
Horizontal dist. and bearing to BT's measured to center of tree root crown at ground level.
Magnetic Compass (20° East Declination)
Steel Tape

June 16, 1983

Witnesses: Gary Langlitz
Dick Humiston

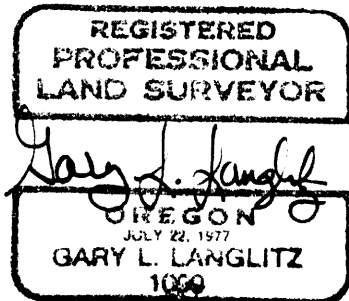

Office of..... County of.....
State of....., I hereby certify that the within instrument was filed in this office for record on the..... day of....., 19.....
..... by.....
(COUNTY OFFICIAL)

UNION COUNTY SURVEYOR (DEPUTY)
Date Received 8-18-83
Date Filed 8-18-83
By G. LANGLITZ
File No. 325-83 R

CERTIFIED RECORD OF LAND CORNER MONUMENTATION

HISTORY OF ORIGINAL CORNER ESTABLISHED:

Corner originally established by John H. Stone under GLO contract number 235 dated July 6th, 1875. Surveyor General field notes state:
Set an alder post with mound and trench as per instructions for 1/4 section corner from which:
A Fir 20 in. in diameter bears South 8° East 18 links distant
A Fir 18 in. in diameter bears North 85° West 48 links distant

T 4 S R 41 E L-01

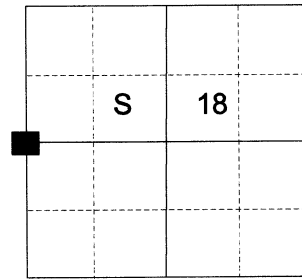

In 1983 Gary Langlitz found the original Southeast bearing tree. Union County Monumentation Record 325-83R states:
The true corner as established by record measurement from the original SE BT is located at water level approx. 7 ft. South of the South Bank of Peter's Creek as described in the original survey. This location is subject to annual flooding, therefore, we establish a Witness Corner at a point 16' South of the true corner position. At the Witness Corner, we set a 2" x 30" galvanized iron pipe 24" in the ground with brass cap attached from which:
The true corner position bears North 16 feet
A 14" Grand Fir, scribed X BT on a double blaze, bears S58°E 32.5 feet.
A 16" Grand Fir, scribed WCX BT on a double blaze bears S73°W 38.1 feet.

DESCRIPTION OF CORNER EVIDENCE FOUND:

Found a 2 1/2" iron pipe, 6" above ground, with 2 1/2" brass cap marked as shown below, from which:

A stump hole with a downed and rotted log lying Northerly bears North 21° East a dist. of 4.50 ft., with wood remnant of "1/4" scribe visible upon excavation.
An 18" White Fir bears South 58° East a dist. of 32.50 ft., alive and vigorous with healed blaze.
A 22" White Fir bears South 73° West a dist. of 38.10 ft., alive and vigorous with healed blaze.

DESCRIPTION OF MONUMENT AND ACCESSORIES I ESTABLISHED TO PERPETUATE THE ORIGINAL LOCATION OF THIS CORNER:

From the iron pipe monument:

NEW BEARING OBJECTS:

A 14" White Fir bears North 52° East a dist. of 14.50 ft., marked 1/4 WC BT.
A 5" White Fir bears West a dist. of 20.25 ft., marked 1/4 WC BT.

Falls on South side of Peter's Creek on a steep North aspect.

I hereby certify that the corner was perpetuated on April 21, 2022.
Witness: Kyle A. Tucker

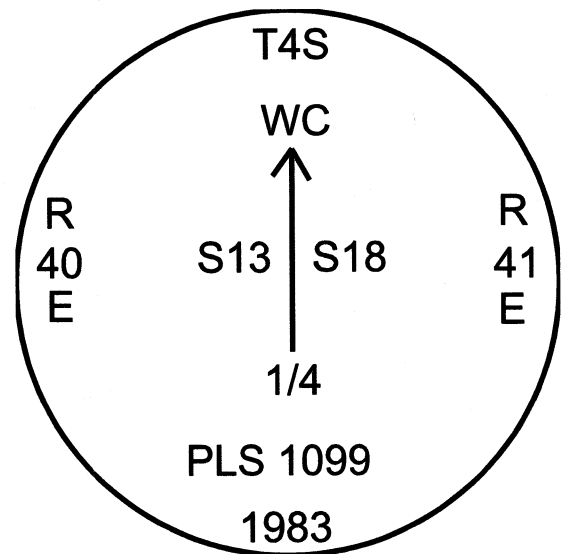

Renewal Date: June 30, 2023

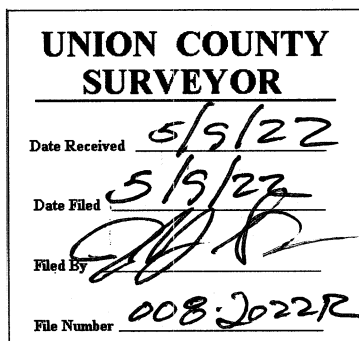

I used a steel tape and magnetic compass in the establishment of the new accessories. I used 14° East declination, the distances are to a 60d spike driven into the right side of the root crown of the bearing trees. A brass washer marked OPLS 83571 is attached to the BT blaze of the new bearing trees.