

**CERTIFIED RECORD OF LAND CORNER MONUMENTATION**

**History of original corner establishment:**

Corner originally established by Henry M. Thatcher under GLO contract number 320, dated April 1, 1879. Surveyor General record states:

Set stone 17x13x11 for 1/4 sec cor  
 Raised mound of stone at cor

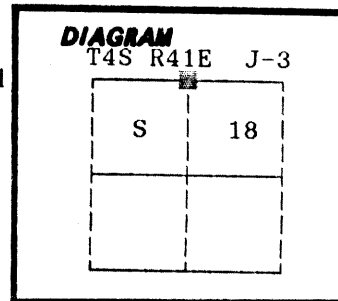

No record of subsequent monumentation found in Union County survey records.

**Description of corner evidence found:**

No evidence of the original corner was found.  
 Area has been heavily logged.  
 I place this corner by survey at a proportionate distance from the creek call to the East.  
 See Union County survey number 29-88

UNION COUNTY SURVEYOR	
Date Received	<u>8-9-88</u>
Date Filed	<u>8-24-88</u>
By	<u>G. Langutz, Deput</u>
File No.	<u>100-88 R</u>

**Description of monument and accessories I established to perpetuate the**

**original location of this corner:** At position determined by survey, I set a 2 1/2" x 30" aluminum pipe with aluminum cap marked as shown, 22 inches in the ground, from which;

New BTs  
 A 18 inch diameter Ponderosa Pine bears N26°E, 14.47 feet marked 1/4 S7 BT  
 A 18 inch diameter Ponderosa Pine bears S83°E, 18.61 feet marked 1/4 S18 BT

Raised a small mound of stone around monument.  
 Painted a 6 inch red band around all BTs and attached 54-3 and 54-9 signs.  
 Set a steel fencepost approximately 5 feet East with 54-9 sign attached

I hereby certify that the above corner point was perpetuated as hereon described on July 20, 1988.

Witness: Duane Griffith

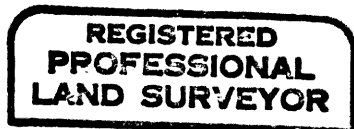
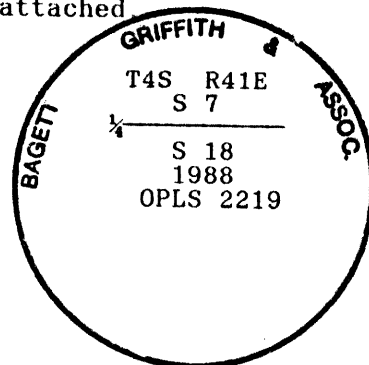

*Rick G. Robinson*

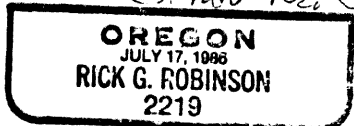

I used a steel tape and magnetic compass in the establishment of new accessories. I used 18° magnetic declination. The distances are to a 50d spike driven in the right side of the root crown. I attached a brass washer marked OPLS 2219 to the BT blaze.

Office of..... County of.....  
 State of....., I hereby certify that the within instrument was filed in this office for record on the..... day of....., 19.....

..... by .....  
 (COUNTY OFFICIAL) (DEPUTY)

C  
-  
W

**CERTIFIED RECORD OF LAND CORNER MONUMENTATION**

**HISTORY OF ORIGINAL CORNER ESTABLISHED:**

Corner originally established by Henry M. Thatcher under GLO Contract Number 320, dated April 1, 1879. Surveyor General field notes state:  
Set Stone 7x13x11 for 1/4 Sec. Cor.  
Raised Stone Mound at Cor.

T 4 S R 41 E J-03

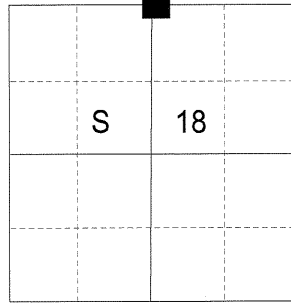

In 1988, Rick Robinson brings this monument up to modern standards by proportionate distance from the creek call to the East. Union County Monumentation Record states:  
I set a 2 1/2" x 30" aluminum pipe with aluminum cap, 22 inches in the ground, from which:  
A 18 inch diameter Ponderosa Pine bears N26°E, 14.47 feet marked 1/4 S7 BT  
A 18 inch diameter Ponderosa Pine bears S83°E, 18.61 feet marked 1/4 S18 BT

**DESCRIPTION OF CORNER EVIDENCE FOUND:**

Found a 2 1/2" aluminum pipe with a 2 1/2" aluminum cap, marked as shown below, 3" above ground. From which:

A 19" Ponderosa Pine snag bears North 26° East, a distance of 14.47 feet, with healed blaze.  
A 21" stump bears South 83° East, a distance of 18.61 feet, with healed blaze.

**DESCRIPTION OF MONUMENT AND ACCESSORIES I ESTABLISHED TO PERPETUATE THE ORIGINAL LOCATION OF THIS CORNER:**

From the aluminum pipe monument

**NEW BEARING TREES:**

A 16" Ponderosa Pine bears North 6° East, a distance of 93.85 feet, marked 1/4 S7 BT.  
A 14" Ponderosa Pine bears South 27° East, a distance of 35.75 feet, marked 1/4 S18 BT.  
A 16" Douglas Fir bears South 55° West, a distance of 58.50 feet, marked 1/4 S18 BT.  
A 15" Ponderosa Pine bears North 24° West, a distance of 31.90 feet, marked 1/4 S7 BT.

I hereby certify that this corner was perpetuated on May 15, 2015.

Witness: Thomas J. Kopp

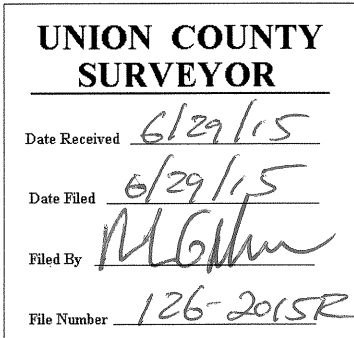
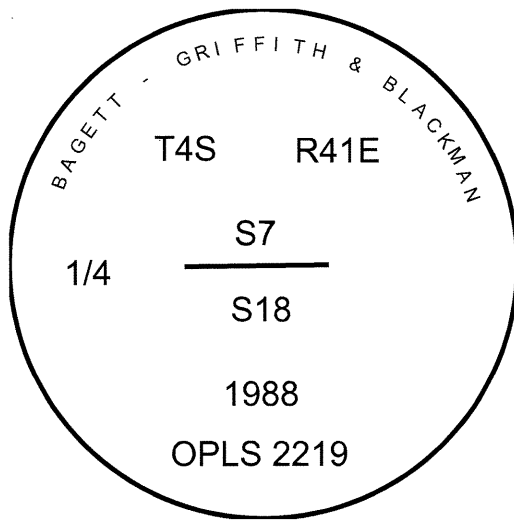

I used a steel tape and magnetic compass in the establishment of the new bearing trees. I used 16° East declination, the distances are to a 60d spike driven into the right side of the root crown of the new bearing tree. A brass washer marked OPLS 83571 is attached to the BT blaze of the new bearing trees.