

CERTIFIED RECORD OF LAND CORNER MONUMENTATION

HISTORY OF ORIGINAL CORNER ESTABLISHED:

Corner originally established by David Thompson under GLO contract number 103 dated September 3, 1863. Surveyor General field notes state:

Set post for corner to secs. 20, 21, 28, and 29 in mound of stone.

Corner noted by W.B. Blakeley in Old Book Survey number 186, page 315. No description given.

Corner found by Mark R. Heidecke in Union County Survey 019-2000. Survey states:
End. Mound of stone over circular hole w/ post remains.

T 4 S R 40 E R-09

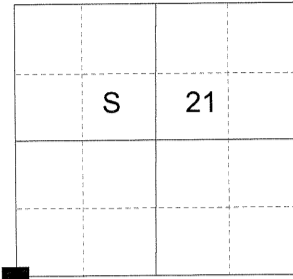

DESCRIPTION OF CORNER EVIDENCE FOUND:

Found a 4 ft. diam. mound of stone with post remains and pink flagging buried in center.

SEE SURVEY NUMBER 045-2019

DESCRIPTION OF MONUMENT AND ACCESSORIES I ESTABLISHED TO MONUMENT THE ORIGINAL LOCATION OF THIS CORNER:

At the center of found mound of stone I set a 5/8" x 30" iron pin, 26" in the ground and drilled into stone, with a 2 1/2" aluminum cap marked as shown below, with 4' diam. mound of stone base to top of cap, from which:

NEW BEARING OBJECTS:

- A 5/8" x 30" iron pin bears North 54°51' East a dist. of 21.84 ft., with 1 1/2" aluminum cap marked Union County Surveyor NE RP.
- A rock outcrop bears South 38°48' East a dist. of 16.80 ft., marked X BO.
- A rock outcrop bears South 28°09' West a dist. of 15.47 ft., marked X BO.
- A rock outcrop bears North 81°44' West a dist. of 14.65 ft., marked X BO.

Set steel fence post approx. 2' West

Falls on top of bluff North of Highway.

I hereby certify that the corner was monumented on December 10, 2019.
Witness: Kyle A. Tucker

REGISTERED
PROFESSIONAL
LAND SURVEYOR

OREGON
June 2, 2010
JEFFREY S. HSU
83571

Renewal Date: June 30, 2021

UNION COUNTY
SURVEYOR

Date Received 12/31/19

Date Filed 12/31/19

Filed By M.G. Min

File Number 077-2092

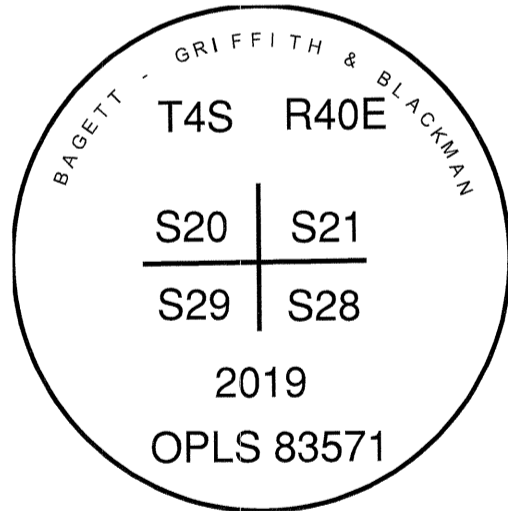

I used a Leica GS18 RTK GPS for the establishment of the new accessories. Basis of bearings is as per Survey Number 045-2019. Distances and bearings are to the center of the "X" on bearing objects, and to the center of the aluminum cap on the iron pin.

HORIZONTAL CONTROL DATA

UNION COUNTY, OREGON

OREGON STATE PLANE, NORTH ZONE (3601)

STA NAME: 2020003

SECTION CORNER COMMON TO SECTIONS 20, 21, 28, AND 29

TWP. 4 S RGE. 40 E.

GEODETIC COORD: NAD 83(91)

DATE TIED: December 31, 2019

LAT: 45 ° 11 ' 41.44616 " N

SURVEYOR: RICK G. ROBINSON
OPLS 2219

LONG: 117 ° 49 ' 45.67083 " W

FIRM: BAGETT, GRIFFITH, & BLACKMAN
2006 ADAMS AVENUE
LAGRANDE, OR 97850
(541) 963-6092

SP. COOR: NAD 83(91)

N: 568507.888 INT FT.

E: 8890409.566 INT FT.

TYPE: GPS

THETA: 1 ° 53 ' 38.3478107 "

ORDER: SECOND CLASS: 1

SCALE FACTOR: 0.9998946862

ELEV: 3068.87 US FT.

ELEV: DATUM: NGVD 29

COMMENTS:

5/8" iron pin with 2 1/2" aluminum cap
marked as shown

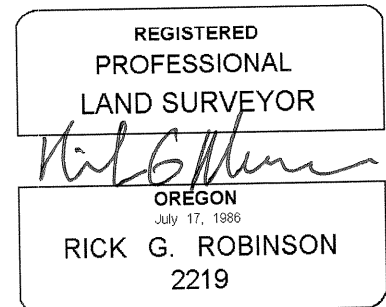
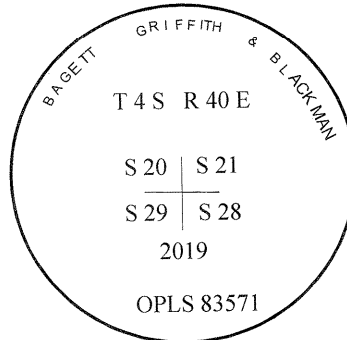

Renewal Date: December 31, 2020

1 METER = 3.2808333333... US FEET = 39.37 INCHES

1 METER = 3.280839895 INT'L FEET OR 1 INCH = 2.54 CM

TO CALCULATE ELEVATION FACTOR (IN THE NORTH AMERICAN CONTINENT)

DIVIDE 20,906,000 BY (20,906,000 + ELLIPSOID ELEV. IN FEET)