

CERTIFIED RECORD OF LAND CORNER MONUMENTATION

HISTORY OF ORIGINAL CORNER ESTABLISHMENT:

Corner originally established by David P. Thompson. GLO contract number 103, dated September 3, 1882. Surveyor General Record states:

Set a wooden post in mound of stone.

No subsequent monumentation found in Union County survey records.

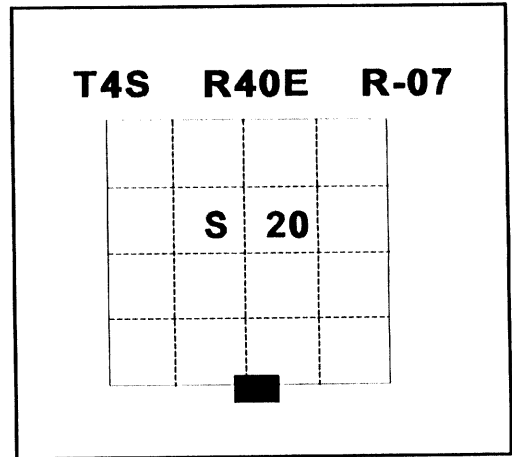

DESCRIPTION OF CORNER EVIDENCE FOUND:

Ancient rock jack fence corner.

See Union County Survey Number 017-1997.

DESCRIPTION OF MONUMENT AND ACCESSORIES I ESTABLISHED

TO PERPETUATE THE ORIGINAL LOCATION OF THIS CORNER:

At position of ancient rock jack fence corner I chiseled a 4" X on a 8'x6' boulder, from which:

NEW BEARING OBJECTS:

A 5/8" x 30" rebar bears S58°E, 19.50 feet, with 1½" aluminum cap marked UNION COUNTY SURVEYOR SE RP.

A 2½" x 30" aluminum pipe with aluminum cap marked as shown below, bears S78°W, 10.50 feet.

A chiseled 3" X BO on 15" high x 6' long rock outcrop bears N78°W, 11.15 feet.

A chiseled 3" X BO on 5' high x 20" wide rock outcrop bears N36°E, 9.10 feet.

I hereby certify that the corner was monumented on June 19, 1997

Witness: Jeff Madsen, Gregory T. Blackman Jr., Jeff Petersen

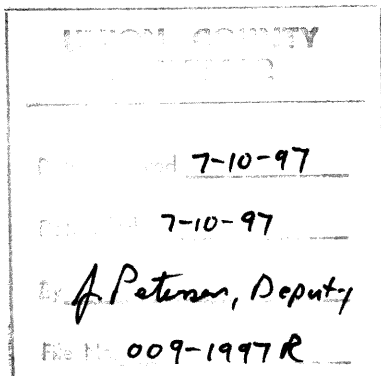
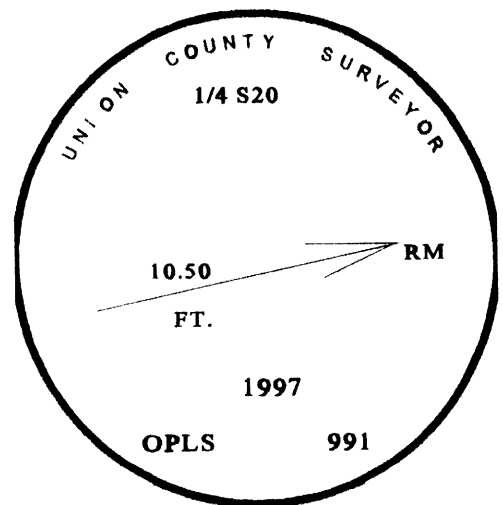
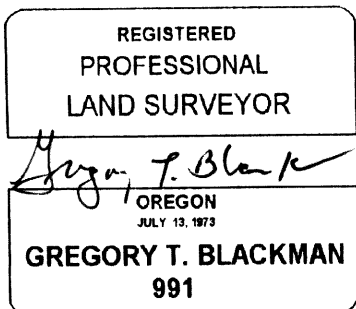

I used a steel tape and magnetic compass in the establishment of the new accessories. I used 18° East declination, the distances are to the X on the bearing objects and to the center of the aluminum cap on the rebar.

HORIZONTAL CONTROL DATA
UNION COUNTY, OREGON
OREGON STATE PLANE, NORTH ZONE (3601)

STA NAME: 2024001

QUARTER CORNER COMMON TO SECTIONS 20 AND 29

TWP. 4 S RGE. 40 E

GEODETIC COORD: NAD 83(91)

DATE TIED: March 8, 2024

LAT: 45 ° 11 ' 42.14453 " N

SURVEYOR: JEFFREY S. HSU
OPLS 83571

LONG: 117 ° 50 ' 22.90286 " W

FIRM: BAGETT, GRIFFITH, & BLACKMAN
2006 ADAMS AVENUE
LAGRANDE, OR 97850
(541) 963-6092

SP. COOR: NAD 83(91)

N: 568490.634 INT FT.

E: 888742.685 INT FT.

TYPE: GPS

THETA: 1 ° 53 ' 11.943375 "

ORDER: SECOND CLASS: 1

SCALE FACTOR: 0.999894688

ELEV: 3014.02 US FT.

ELEV: DATUM: NGVD 29

COMMENTS:

4" chiseled "X" in stone under rock jack

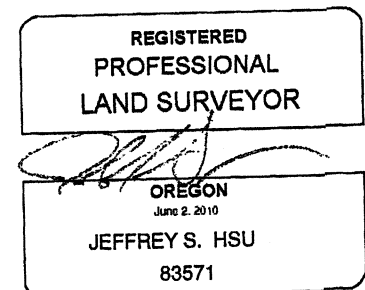

Renewal Date: June 30, 2025

1 METER = 3.280833333... US FEET = 39.37 INCHES

1 METER = 3.280839895 INT'L FEET OR 1 INCH = 2.54 CM

TO CALCULATE ELEVATION FACTOR (IN THE NORTH AMERICAN CONTINENT)

DIVIDE 20,906,000 BY (20,906,000 + ELLIPSOID ELEV. IN FEET)

GEOID MODEL : 2012B